



CT·SA

Super Tite-Lock®

Kraftspannfutter
Milling Chuck

*Hochleistungsfräsen
mit höchster Präzision !
powerful machining
with high run-out accuracy !*



made by  **NT TOOL**
www.nttooleurope.com

Inhalt | Content

CT-SA	Hochleistungs-Kraftspannfutter High Performance Milling Chuck	Seite Page 4 - 6
CTS-P	Power-Kraftspannfutter Power Milling Chuck	Seite Page 7
Verlängerung	Extension	Seite Page 26
MC	Spannhülsen Straight Collets	Seite Page 28 - 29
Zubehör	Accessories	Seite Page 30

Zeichenerklärung | Key to symbols



Spannbereich | clamping range



Rundlaufgenauigkeit | Run-out accuracy



max. Einsatzdrehzahl | max. RPM



geeignet für IK-Werkzeuge | suitable for internally cooled tools



alle Kraftspannfutter sind korossionsgeschützt | all Milling chucks are rust-proofed
ausgenommen Hohlschaftkegel (HSK) | except for HSK-taper

Spannpower, Präzision und Flexibilität - alles in einem

Clamping power, precision and flexibility
- All in one.

HSK-A	Seite / Page 8
HSK-E	Seite / Page 13
HSK-F	Seite / Page 14
Polygon	Seite / Page 15
SK DIN 69871....	Seite / Page 16
BT	Seite / Page 20
WBT-AHO	Seite / Page 23
ST-PHC-SB	Seite / Page 26

Einfache & schnelle Werkzeugspannung
Simple & quick tightening action

Für alle Werkzeugschäfte geeignet
All types of shanks can be clamped

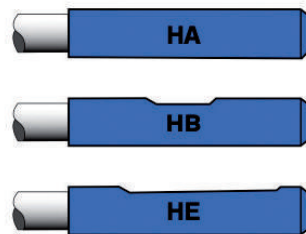
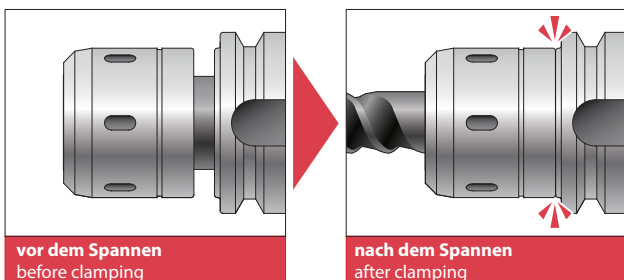

Einzigartige Spanngeometrie | unique clamping geometry

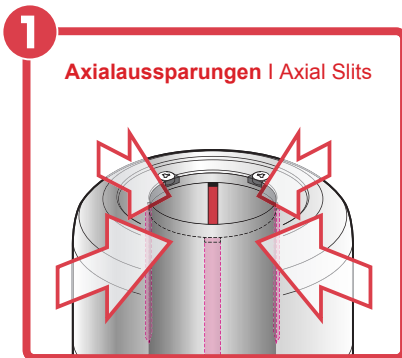
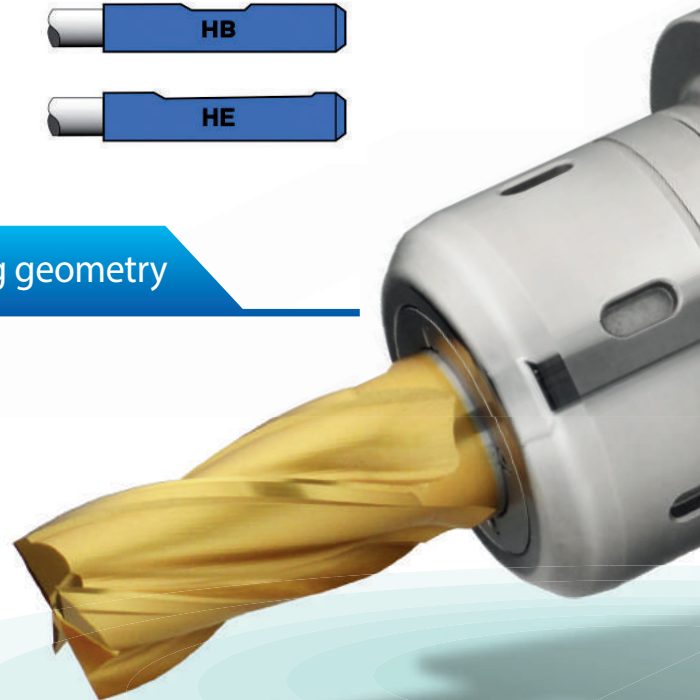

erhöhen die Spannkraft
increases the clamping forces

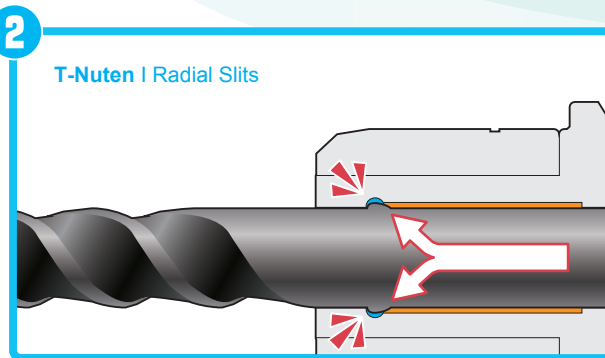

reduzieren die Gefahr des Fräserauszugs und halten die Spannflächen trocken.
minimizes risk of milling cutter being pulled out and keeps clamping dry.

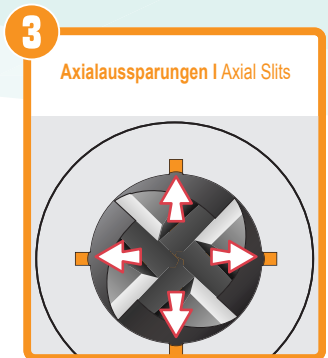

verhindern das „Durchrutschen“ des Fräasers.
prevents tool rotation

Schwingungsdämpfung
Vibration damping

unübertroffene Spannkräfte
unsurpassed clamping forces

Der „Super Tite-Lock“-Mechanismus absorbiert Schwingungen und ermöglicht somit lange Werkzeugstandzeiten und beste Oberflächen.

The „Super Tite-Lock“ mechanism absorbs vibrations thus improving machining quality and tool life.

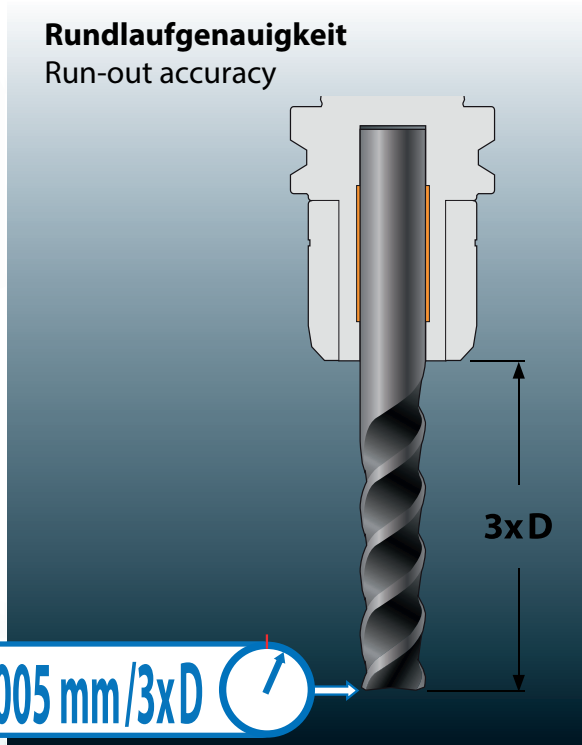
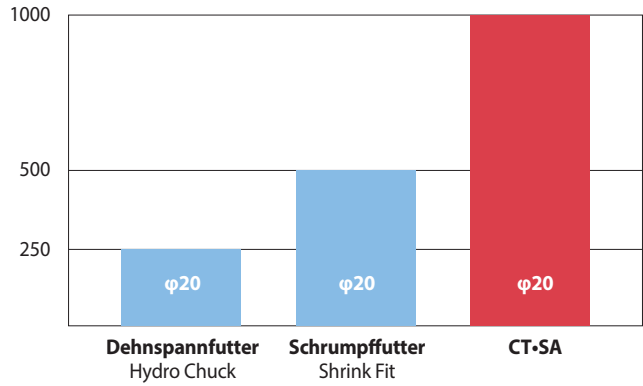

Kühlmittelezufuhr zentral | peripher
Central coolant | side-through



zentral | center-through **peripher** | side-through

Zubehör | Accessories



MC - Spannhülse
MC - Straight Collets

zur Durchmesserreduzierung, für innere und periphere Kühlmittelezufuhr

to reduce diameter, for inner coolant and side-through-coolant

Anschlagschrauben
Stopper bolt



Vielfältige Einsatz- und Anwendungsbereiche

Wide range of use and applications

Hohe Flexibilität

Direktspannung, Durchmesser-Reduzierung mittels Spannhülsen oder mit zylindrischen Verlängerungen.

Alles ist möglich !

Das bedeutet:

- Hohe Flexibilität
- Kostenersparnis

High flexibility

Direct clamping, use of MC Collets or tool extensions.

Everything is possible !

This means:

- High flexibility
- Cost savings



Schrupfräsen
heavy milling

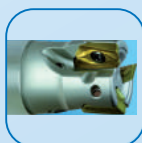

Hochvorschubfräsen
Highfeed-Milling



Schlichtfräsen
Finishing



Gewindefräsen
thread milling

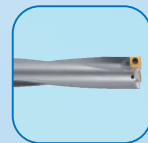

WP-Vollbohrer
Indexable drills

Das stärkste Fräser-Spannfutter aller Zeiten

The most powerfull Milling chuck of all times

Unsere Lösung: CTS-P Power-Kraftspannfutter

- bewährte Kraftspanntechnik
- extreme Spannkräfte
- hohe Rundlaufgenauigkeit
- vibrationsdämpfend
- gute Radialsteifigkeit
- maximale Flexibilität

optimal für das

- Fräsen schwer zerspanbarer Werkstoffe
- trochoidales Fräsen
- Hochvorschubfräsen



Our Solution: CTS-P Power Milling Chuck

- long time proven Milling chuck system
- extremely high clamping forces
- high run out accuracy
- good damping
- optimal rigidity
- maximum flexibility

first choice for

- milling of difficult-to-cut material
- trochoidal milling
- Highfeed-Milling

CTS-P	1700 Nm
CT-SA	1000 Nm
Schrumpffutter verstärkt Shrink Fit reinforced	500 Nm*
Einpressfutter Press-in Chuck	800 Nm*
Dehnspannfutter verstärkt Hydro Chuck Heavy Duty	900 Nm*

Vergleich Spannkräfte ausgewählter Spannsysteme D=20.0

Comparison table of
selected toolholding
systems D=20.0

* lt. Herstellerangaben / acc. to mfc

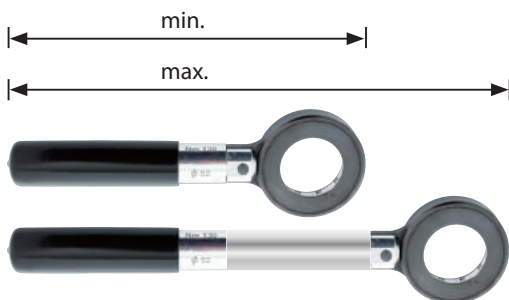

RS

RS Rollenschlüssel | Teleskopausführung
RS Roller spanner | Telescope type

Halter Holder	Rollenschlüssel Roller spanner	min. max.
CT20S-P	RS-20	250-370
CT25S-P	RS-25	280-400
CT32S-P	RS-32	280-400

Unsere Rollenschlüssel mit Teleskopgriff ermöglichen die schnelle und sichere Werkzeugspannung ohne Verletzungsgefahr.

Our Roller Spanners with telescopic handle ensures
fast and secure tool clamping without risk of injury.



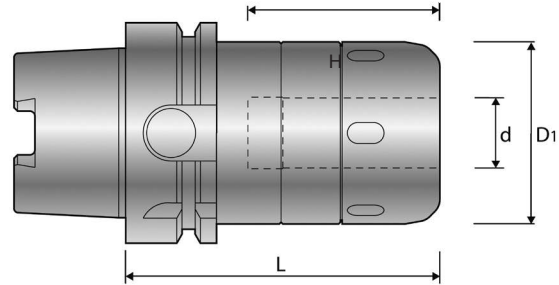

HSK40A



DIN 69893 | ISO 12164

3.0
-
25.0

0.005
-
3x D

max
15.000
min⁻¹



Halter Holder			d	D ₁	L	H		
HSK40A	-CT16SA	-75	16	45	75	50	MC16-d	HS-1-16
		-90	16	45	90	60	MC16-d	HS-1-16
	-CT20SA	-90	20	52	90	60	MC20-d	HS-2-20
		-105	20	52	105	60	MC20-d	HS-2-20
-CT25SA	-105	25	61	105	60	MC25-d	HS-2.5-25	

HSK50A



DIN 69893 | ISO 12164

3.0
-
25.0

0.005
-
3x D

max
15.000
min⁻¹



Halter Holder			d	D ₁	L	H		
HSK50A	-CT16SA	-90	16	45	90	60	MC16-d	HS-1-16
		-90	20	52	90	60	MC20-d	HS-2-20
	-CT20SA	-105	20	52	105	60	MC20-d	HS-2-20
		-105	25	61	105	60	MC25-d	HS-2.5-25

- HSK-Kühlmittelrohr im Lieferumfang enthalten.
- HSK ohne Bohrung für Handspannung.
- MC-A Spannhülsen nicht einsetzbar.

- HSK-Coolant pipe included in delivery.
- HSK without holes for manual clamping.
- MC-A Collets cannot be used.



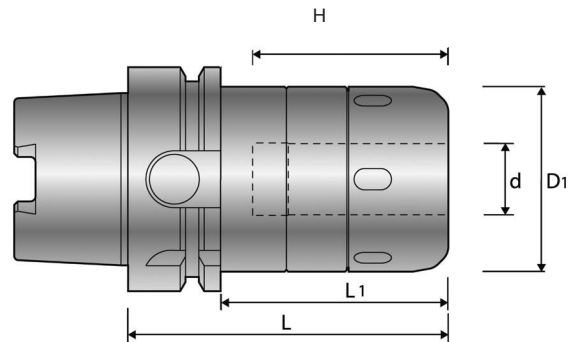

HSK63A



DIN 69893 | ISO 12164

3.0
32.0

0.005
3x D

max
20.000
min⁻¹



Halter Holder			d	D ₁	L	L ₁	H		
HSK63A	-CT16SA	-75-H ¹	16	45	75	49	47	MC16-d	HS-1-16
		-90-H	16	45	90	64	60	MC16-d	HS-1-16
	-CT20SA	-75-H ¹	20	52	75	49	49	MC20-d-SL	HS-2-20
		-90-H ¹	20	52	90	64	60	MC20-d	HS-2-20
		-105-H ¹	20	52	105	79	75	MC20-d	HS-2-20
	-CT25SA	-135-H ¹	20	52	135	109	80	MC20-d	HS-2-20
		-105-H ¹	25	61	105	-	75	MC25-d	HS-2.5-25
		-120-H ¹	25	61	120	-	75	MC25-d	HS-2.5-25
	-CT32SA	-135-H ¹	25	61	135	-	80	MC25-d	HS-2.5-25
		-105-H ¹	32	73	105	-	75	MC32-d	HS-3-32
		-120-H ¹	32	73	120	-	90	MC32-d	HS-3-32
			-135-H ¹	32	73	135	-	MC32-d	HS-3-32

CT·SA-C *cool series*



mit Peripheriekühlung
with side-through coolant

Halter Holder			d	D ₁	L	L ₁	H		
HSK63A	-CT20SA	-90-C	20	52	90	64	60	n.a.	HS-2-20

CTS·P *Power* Kraftspannfutter Milling Chuck

mit erhöhter Spannkraft
with enhanced clamping force

Halter Holder			d	D ₁	L	L ₁	H		
HSK63A	-CT20S	-100P	20	52	100	89	75	MC20-d	RS-20

- HSK-Kühlmittelrohr im Lieferumfang enthalten.
- HSK mit Bohrung für Handspannung
- ¹ MC-A Spannhülsen nicht einsetzbar.

- HSK-Coolant pipe included in delivery.
- HSK with holes for manual clamping
- ¹ MC-A Collets cannot be used.



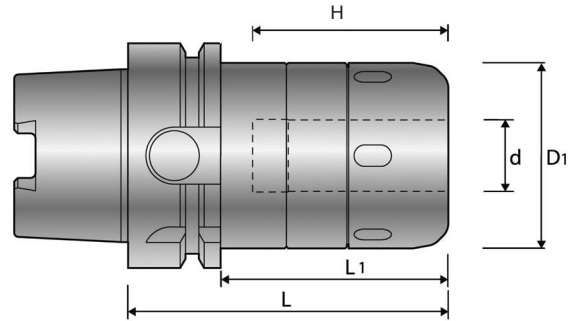

HSK80A



DIN 69893 | ISO 12164

3.0
32.0

0.005
3x D

max
20.000
min⁻¹



Halter Holder			d	D ₁	L	L ₁	H		
HSK80A	-CT20SA	-105-H	20	52	105	79	70	MC20-d	HS-2-20
	-CT25SA	-105-H	25	61	105	79	70	MC25-d	HS-2.5-25
	-CT32SA	-120-H	32	73	120	-	70	MC32-d	HS-3-32

- HSK-Kühlmittelrohr im Lieferumfang enthalten.
- HSK mit Bohrung für Handspannung
- MC-A Spannhülsen nicht einsetzbar.

- HSK-Coolant pipe included in delivery.
- HSK with holes for manual clamping
- MC-A Collets cannot be used.



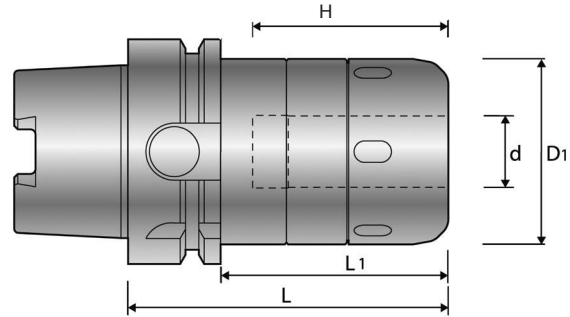

HSK100A



DIN 69893 | ISO 12164

3.0
-
32.0

0.005
-
3x D

max
15.000
min⁻¹





Halter Holder			d	D ₁	L	L ₁	H		
HSK100A	-CT16SA	-90-H ^{1, 2}	16	45	90	-	55	MC16-d	HS-1-16
		-105-H	16	45	105	-	70	MC16-d	HS-1-16
	-CT20SA	-90-H	20	52	90	-	55	MC20-d-SL	HS-2-20
		-105-H	20	52	105	-	70	MC20-d	HS-2-20
		-120-H	20	52	120	-	80	MC20-d	HS-2-20
		-135-H	20	52	135	-	80	MC20-d	HS-2-20
		-150-H	20	52	150	-	80	MC20-d	HS-2-20
	-CT25SA	-90-H ^{1, 2}	25	61	90	61	55	-	HS-2.5-25
		-105-H	25	61	105	-	70	MC25-d	HS-2.5-25
		-120-H	25	61	120	-	80	MC25-d	HS-2.5-25
		-135-H	25	61	135	-	80	MC25-d	HS-2.5-25
	-CT32SA	-150-H	25	61	150	-	80	MC25-d	HS-2.5-25
		-90-H ^{1, 2}	32	73	90	61	55	-	HS-3-32
		-105-H ¹	32	73	105	76	70	MC32-d	HS-3-32
		-120-H ¹	32	73	120	91	85	MC32-d	HS-3-32
			-135-H ¹	32	73	135	106	MC32-d	HS-3-32
		-150-H ¹	32	73	150	121	MC32-d	HS-3-32	

CTS·P Power

Kraftspannfutter

Milling Chuck

mit erhöhter Spannkraft
with enhanced clamping force

Halter Holder			d	D ₁	L	L ₁	H		
HSK100A	-CT20S	-115P	20	52	115	86	80	MC20-d	RS-20
	-CT25S	-115P	25	61	115	86	80	MC20-d	RS-25
	-CT32S	-115P	32	73	115	86	80	MC20-d	RS-32

• HSK-Kühlmittelehr im Lieferumfang enthalten.

• HSK mit Bohrung für Handspannung

¹ MC-A Spannhülsen nicht einsetzbar

² MC Spannhülsen nicht einsetzbar, nur Direktspannung

• HSK-Coolant pipe included in delivery.

• HSK with holes for manual clamping

¹ MC-A Collets cannot be used

² MC straight collets cannot be used, only direct chucking.



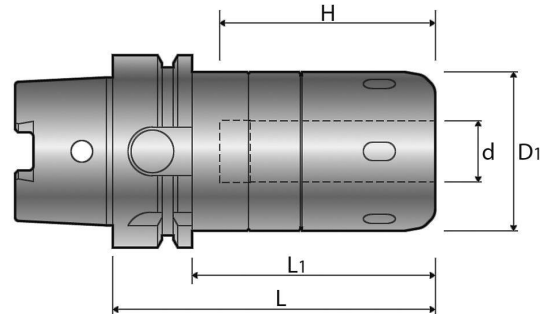
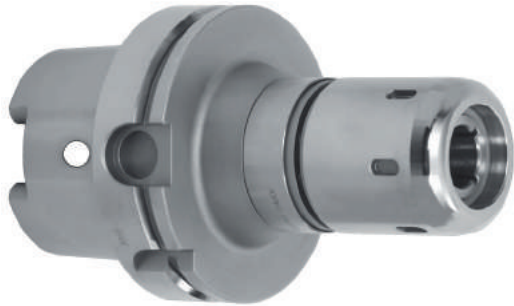

HSK125A

DIN 69893 | ISO 12164



3.0
32.0

0.005
3xD

max
15.000
min⁻¹



mit erhöhter Spannkraft
with enhanced clamping force

Halter Holder			d	D ₁	L	L ₁	H		
HSK125A	-CT20S	-120P	20	52	120	86	80	MC20-d	RS-20
	-CT32S	-120P	32	73	120	86	80	MC32-d	RS-32

- Spannmutter, HSK-Kühlmittelrohr und Einstellschraube im Lieferumfang enthalten.
- HSK mit Bohrung für Handspannung

- Cap nut, HSK-Coolant pipe and preset screw included in delivery.
- HSK with holes for manual clamping



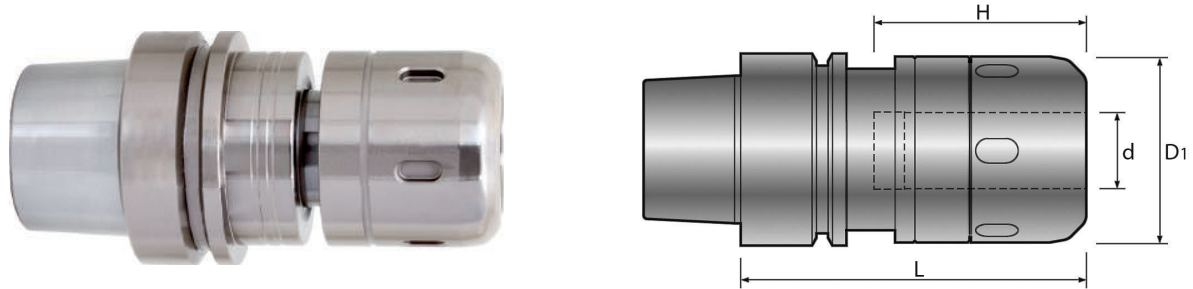

HSK40E



DIN 69893

3.0
25.0

0.005
3x D

max
20.000
min⁻¹



Halter Holder			d	D ₁	L	H		
HSK40E	-CT16SA	-75	16	45	75	55	MC16-d	HS-1-16
		-90	16	45	90	70	MC16-d	HS-1-16
	-CT20SA	-90	20	52	90	70	MC20-d	HS-2-20
		-105	20	52	105	85	MC20-d	HS-2-20
	-CT25SA	-105	25	61	105	85	MC25-d	HS-2.5-25

HSK50E



DIN 69893

3.0
25.0

0.005
3x D

max
20.000
min⁻¹



Halter Holder			d	D ₁	L	H		
HSK50E	-CT16SA	-90	16	45	90	70	MC16-d	HS-1-16
		-90	20	52	90	70	MC20-d	HS-2-20
	-CT20SA	-105	20	52	105	85	MC20-d	HS-2-20
		-105	25	61	105	85	MC25-d	HS-2.5-25

• MC-A Spannhülsen nicht einsetzbar.

• MC-A Collets cannot be used.



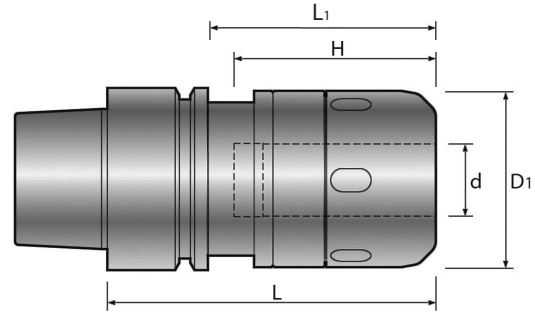
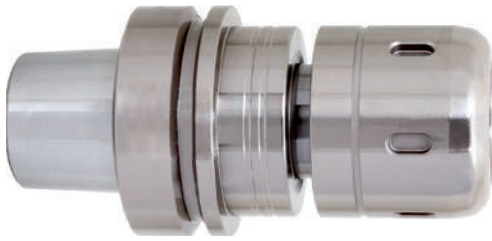

HSK63F



DIN 69893

3.0
32.0

0.005
3x D

max
25.000
min⁻¹



Halter Holder			d	D ₁	L	L ₁	H		
HSK63F	-CT20SA	-105	20	52	105	79	75	MC20-d	HS-2-20
	-CT25SA	-105	25	61	105	79	75	MC25-d	HS-2.5-25
	-CT32SA	-105	32	73	105	79	75	MC32-d	HS-3-32

• MC-A Spannhülsen nicht einsetzbar.

• MC-A Collets cannot be used.

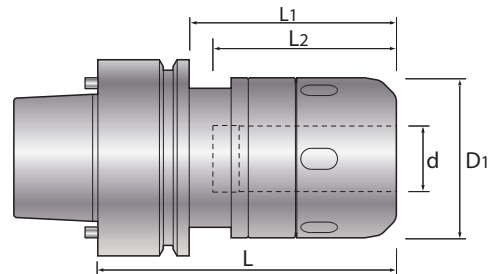

HSK80F

DIN 69893



3.0
25.0

0.005
4x D

G2.5
20.000
min⁻¹



MAKINO MAG SERIES

Halter Holder			d	D ₁	L	L ₁	L ₂		
HSK80F	-CT16SA	-75	16	45	75	49	47	MC16-d	HS-1-16
	-CT20SA	-75	20	52	75	49	47	MC20-d	HS-2-20
	-CT20SA	-90	20	52	90	64	60	MC20-d	HS-2-20
	-CT25SA	-105	25	61	105	-	75	MC25-d	HS-2.5-25

• MC-A Spannhülsen nicht einsetzbar

• MC-A Collets cannot be used



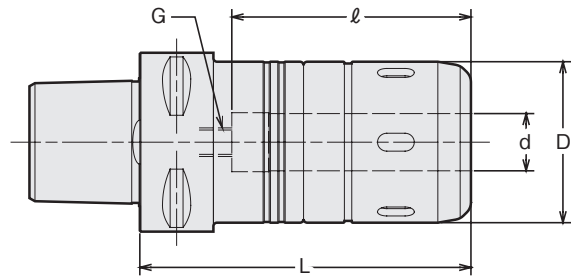



POLYGON

ISO 26623-1



Halter Holder			d	D _i	L	H ^{max}	G		
C5	-CT16SA	-75 ^{1,2}	16	45	70	64	-	MC16-d	HS-1-16
		-90	16	45	90	65	M10	MC16-d	HS-1-16
	-CT20SA	-75 ^{1,2}	20	52	75	65	-	MC20-d	HS-2-20
		-90 ^{1,2}	20	52	90	80	-	MC20-d	HS-2-20
	-CT25SA	-90 ^{1,2}	25	61	90	80	-	MC25-d	HS-2.5-25
-105 ¹		25	61	105	80	M12	MC25-d	HS-2.5-25	
-CT32SA	-90 ^{1,2}	32	73	90	75	-	MC32-d	HS-3-32	
C6	-CT16SA	-70 ²	16	45	70	61	-	MC16-d	HS-1-16
		-90	16	45	90	65	M10	MC16-d	HS-1-16
		-105	16	45	105	65	M10	MC16-d	HS-1-16
		-135	16	45	135	65	M10	MC16-d	HS-1-16
	-CT20SA	-75 ^{1,2}	20	52	75	60	-	MC20-d	HS-2-20
		-90 ^{1,2}	20	52	90	75	-	MC20-d	HS-2-20
		-105 ¹	20	52	105	80	M12	MC20-d	HS-2-20
		-135	20	52	135	80	M12	MC20-d	HS-2-20
	-CT25SA	-80 ^{1,2}	25	61	80	65	-	MC25-d	HS-2.5-25
		-90 ^{1,2}	25	61	90	75	-	MC25-d	HS-2.5-25
		-105 ¹	25	61	105	80	M12	MC25-d	HS-2.5-25
	-CT32SA	-135	25	61	135	80	M12	MC25-d	HS-2.5-25
		-90 ^{1,2}	32	73	90	75	-	MC32-d	HS-3-32
		-105 ¹	32	73	105	80	-	MC32-d	HS-3-32
	-135 ¹	32	73	135	100	M12	MC32-d	HS-3-32	

*1: MC-A Spannhülsen nicht einsetzbar
*2: BL-Einstellschraube nicht einsetzbar

*1: MC-A Collets cannot be used
*2: BL-Back-up screw cannot be used



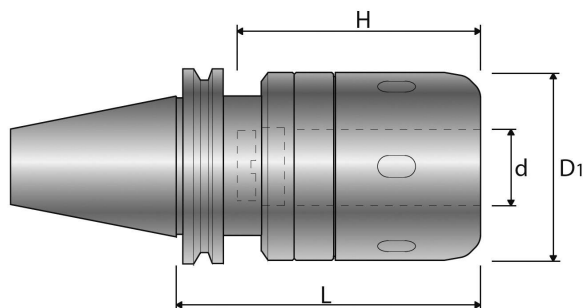

SK30

DIN 69871 | ISO 7388-1



3.0
20.0

0.005
3x D

max
20.000
min⁻¹

Form
AD



Halter Holder			d	D ₁	L	H		
SK30	-CT16SA	-90	16	45	90	65	MC16-d	HS-1-16
		-105	16	45	105	65	MC16-d	HS-1-16
	-CT20SA	-90	20	52	90	80	MC20-d	HS-2-20
		-105	20	52	105	80	MC20-d	HS-2-20

• Bei Verwendung mit innerer Kühlmittelzufuhr die Luftaustrittsbohrungen mit zwei Schrauben M4x5 verschließen (im Lieferumfang enthalten).

• Hex-head screws M4x5 are necessary to plug air hole for center through coolant feed. (incl. in delivery).



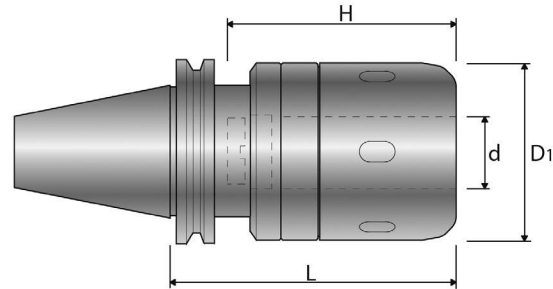

SK40

DIN 69871 | ISO 7388-1



3.0
32.0

0.005
3x D

max
20.000
min⁻¹

Form
AD



Halter Holder			d	D ₁	L	H		
SK40	-CT16SA	-90	16	45	90	65	MC16-d	HS-1-16
		-75 ⁴	20	52	75	80	MC20-d	HS-2-20
	-CT20SA	-90 ²	20	52	90	80	MC20-d	HS-2-20
		-105	20	52	105	80	MC20-d	HS-2-20
		-120	20	52	120	80	MC20-d	HS-2-20
	-CT25SA	-105 ²	25	61	105	80	MC25-d	HS-2.5-25
		-135	25	61	135	80	MC25-d	HS-2.5-25
	-CT32SA	-105 ^{1,2}	32	73	105	85	MC32-d	HS-3-32
		-120 ¹	32	73	120	85	MC32-d	HS-3-32
		-135	32	73	135	120	MC32-d	HS-3-32

• Bei Verwendung mit innerer Kühlmittelzufuhr die Luftaustrittsbohrung mit zwei Schrauben M4x5 verschließen. (im Lieferumfang enthalten)

¹ MC-A Spannhülsen nicht einsetzbar.

² Lagerstandard mit Form B

⁴ Ohne Freistich nach DIN 69871 vor dem Greiferbund

⁴ Nicht einsetzbar auf bestimmten BAZ

• Hex-head screws M4x5 are necessary to plug air hole for center through coolant feed. (included in delivery)

¹ MC-A Collets cannot be used.

² Form B Standard



⁴ Without undercut (DIN 69871) before flange

⁴ Not suitable for certain M/C

CTS·P Power Kraftspannfutter

Milling Chuck

mit erhöhter Spannkraft
with enhanced clamping force

Halter Holder			d	D ₁	L	H		
SK40	-CT20S	-100P	20	52	10,0	80	MC20-d	RS-20



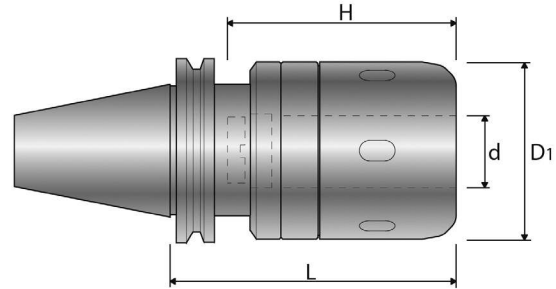

SK50

DIN 69871 | ISO 7388-1



3.0
32.0

0.005
3x D

max
15.000
min⁻¹

Form
AD



Halter Holder			d	D ₁	L	H		
SK50	-CT16SA	-90	16	45	90	65	MC16-d	HS-1-16
		-105 ¹	16	45	105	65	MC16-d	HS-1-16
		-135	16	45	135	65	MC16-d	HS-1-16
	-CT20SA	-90	20	52	90	80	MC20-d	HS-2-20
		-105 ¹	20	52	105	80	MC20-d	HS-2-20
		-135	20	52	135	80	MC20-d	HS-2-20
		-165	20	52	165	80	MC20-d	HS-2-20
		-200	20	52	200	80	MC20-d	HS-2-20
		-250	20	52	250	80	MC20-d	HS-2-20
	-CT25SA	-300	20	52	300	80	MC20-d	HS-2-20
		-105 ¹	25	61	105	80	MC25-d	HS-2.5-25
		-135	25	61	135	80	MC25-d	HS-2.5-25
		-165	25	61	165	80	MC25-d	HS-2.5-25
		-200	25	61	200	80	MC25-d	HS-2.5-25
	-CT32SA	-250	25	61	250	80	MC25-d	HS-2.5-25
		-300	25	61	300	80	MC25-d	HS-2.5-25
		-95	32	73	95	120	MC32-d	HS-3-32
		-105 ¹	32	73	105	120	MC32-d	HS-3-32
		-120	32	73	120	120	MC32-d	HS-3-32
		-135	32	73	135	120	MC32-d	HS-3-32
		-150	32	73	150	120	MC32-d	HS-3-32
		-165	32	73	165	120	MC32-d	HS-3-32
	-200	32	73	200	120	MC32-d	HS-3-32	
	-250	32	73	250	120	MC32-d	HS-3-32	
-300	32	73	300	120	MC32-d	HS-3-32		

• Bei Verwendung mit innerer Kühlmittelzufuhr die Luftaustrittsbohrung mit zwei Schrauben M4x5 verschließen. (im Lieferumfang enthalten)

¹ Lagerstandard mit Form B

• Hex-head screws M4x5 are necessary to plug air hole for center through coolant feed. (included in delivery)

¹ Form B Standard



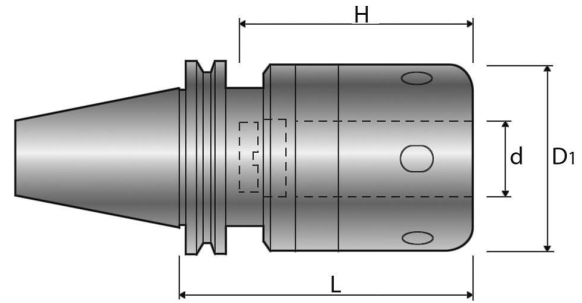

SK50

DIN 69871 | ISO 7388-1

4.0
32.0



0.005
3x D

max
15.000
min⁻¹

Form
AD



mit erhöhter Spannkraft
with enhanced clamping force

Halter Holder			d	D ₁	L	H		
SK50	-CT32S	-115P	32	73	115	120	MC32-d	RS-32

• Bei Verwendung mit innerer Kühlmittelzufuhr die Luftaustrittsbohrungen mit zwei Schrauben M4x5 verschließen (im Lieferumfang enthalten).

• Hex-head screws M4x5 are necessary to plug air hole for center through coolant feed. (incl. in delivery).



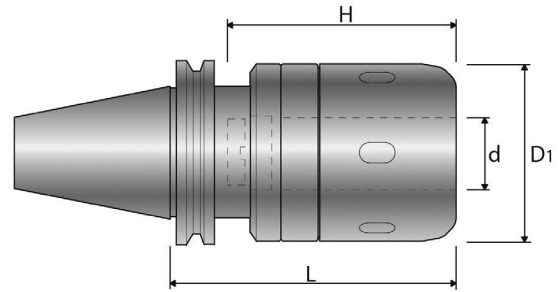

BT30

JIS B6339

3.0
32.0



0.005
3x D

max
20.000
min⁻¹

Form
AD



mit AHO-Plananlage & Hohlsteilkegel verfügbar
with AHO 2Face-Contact & Hollow shank available

Halter Holder			d	D ₁	L	H		
BT30	-CT16SA	-75	16	45	75	65	MC16-d	HS-1-16
		-90	16	45	90	65	MC16-d	HS-1-16
	-CT20SA	-75 ¹	20	52	75	80	MC20-d	HS-2-20
		-90	20	52	90	80	MC20-d	HS-2-20
		-105	20	52	105	80	MC20-d	HS-2-20
	-CT25SA	-90	25	61	90	80	MC25-d	HS-2.5-25
		-105	25	61	105	80	MC25-d	HS-2.5-25
	-CT32SA	-90	32	68	90	75	MC32-d	HS-3-32

• Bei Verwendung mit innerer Kühlmittelzufuhr die Luftaustrittsbohrung mit zwei Schrauben M4x5 verschließen. (im Lieferumfang enthalten)

¹ MC-A Spannhülsen nicht einsetzbar.

• Hex-head screws M4x5 are necessary to plug air hole for center through coolant feed. (included in delivery)

¹ MC-A Collets cannot be used.



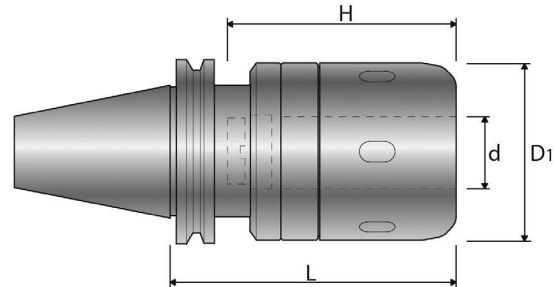

BT40

JIS B6339

3.0
32.0

0.005
3x D

max
20.000
min⁻¹

Form
AD



mit AHO-Plananlage & Hohlsteilkegel verfügbar with AHO 2Face-Contact & Hollow shank available

Halter Holder			d	D ₁	L	H		
BT40	-CT16SA	-75	16	45	75	65	MC16-d	HS-1-16
		-90	16	45	90	65	MC16-d	HS-1-16
	-CT20SA	-75	20	52	75	75	MC20-d	HS-2-20
		-90 ²	20	52	90	80	MC20-d	HS-2-20
		-105	20	52	105	80	MC20-d	HS-2-20
	-CT25SA	-120	20	52	120	80	MC20-d	HS-2-20
		-90	25	61	90	80	MC25-d	HS-2.5-25
		-105 ²	25	61	105	80	MC25-d	HS-2.5-25
		-120	25	61	120	80	MC25-d	HS-2.5-25
	-CT32SA	-135	25	61	135	80	MC25-d	HS-2.5-25
		-90 ¹	32	73	90	76	MC32-d	HS-3-32
		-105 ²	32	73	105	85	MC32-d	HS-3-32
		-120	32	73	120	85	MC32-d	HS-3-32
		-135	32	73	135	120	MC32-d	HS-3-32

• Bei Verwendung mit innerer Kühlmittelzufuhr die Luftaustrittsbohrung mit zwei Schrauben M4x5 verschließen. (im Lieferumfang enthalten)

¹ MC-A Spannhülsen nicht einsetzbar.

² Lagerstandard mit Form B

• Hex-head screws M4x5 are necessary to plug air hole for center through coolant feed. (included in delivery)

¹ MC-A Collets cannot be used.

² Form B Standard

mit erhöhter Spannkraft
with enhanced clamping force

Halter Holder			d	D ₁	L	H		
BT40	-CT20S	-100P	20	52	100	80	MC20-d	RS-20

Zubehör
Accessories
Seite | Page
28 - 30

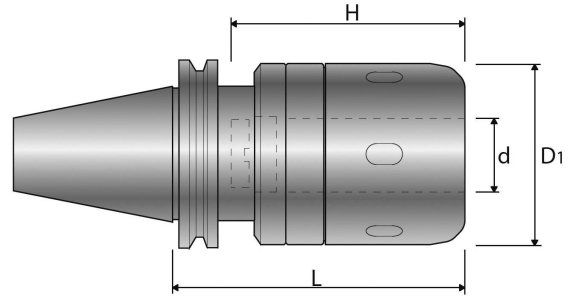

BT50

JIS B6339

3.0
32.0



0.005
3x D

max
15.000
min⁻¹

Form
AD



mit AHO-Plananlage & Hohlsteilkegel verfügbar
with AHO 2Face-Contact & Hollow shank available

Halter Holder			d	D ₁	L	H		
BT50	-CT16SA	-90	16	45	90	65	MC16-d	HS-1-16
		-105	16	45	105	65	MC16-d	HS-1-16
		-135	16	45	135	65	MC16-d	HS-1-16
	-CT20SA	-90	20	52	90	80	MC20-d	HS-2-20
		-105	20	52	105	80	MC20-d	HS-2-20
		-120	20	52	120	80	MC20-d	HS-2-20
		-135	20	52	135	80	MC20-d	HS-2-20
		-165	20	52	165	80	MC20-d	HS-2-20
		-200	20	52	200	80	MC20-d	HS-2-20
		-250	20	52	250	80	MC20-d	HS-2-20
	-CT25SA	-300	20	52	300	80	MC20-d	HS-2-20
		-105	25	61	105	80	MC25-d	HS-2.5-25
		-120	25	61	120	80	MC25-d	HS-2.5-25
		-135	25	61	135	80	MC25-d	HS-2.5-25
		-165	25	61	165	80	MC25-d	HS-2.5-25
		-200	25	61	200	80	MC25-d	HS-2.5-25
	-CT32SA	-250	25	61	250	80	MC25-d	HS-2.5-25
		-300	25	61	300	80	MC25-d	HS-2.5-25
		-95	32	73	95	120	MC32-d	HS-3-32
		-105	32	73	105	120	MC32-d	HS-3-32
		-120	32	73	120	120	MC32-d	HS-3-32
		-135	32	73	135	120	MC32-d	HS-3-32
		-150	32	73	150	120	MC32-d	HS-3-32
		-165	32	73	165	120	MC32-d	HS-3-32
-200		32	73	200	120	MC32-d	HS-3-32	
-250	32	73	250	120	MC32-d	HS-3-32		
-300	32	73	300	120	MC32-d	HS-3-32		

• Bei Verwendung mit innerer Kühlmittelzufuhr die Luftaustrittsbohrung mit zwei Schrauben M4x5 verschließen. (im Lieferumfang enthalten)

¹ MC-A Spannhülsen nicht einsetzbar.

² Lagerstandard mit Form B

• Hex-head screws M4x5 are necessary to plug air hole for center through coolant feed. (included in delivery)

¹ MC-A Collets cannot be used.

² Form B Standard



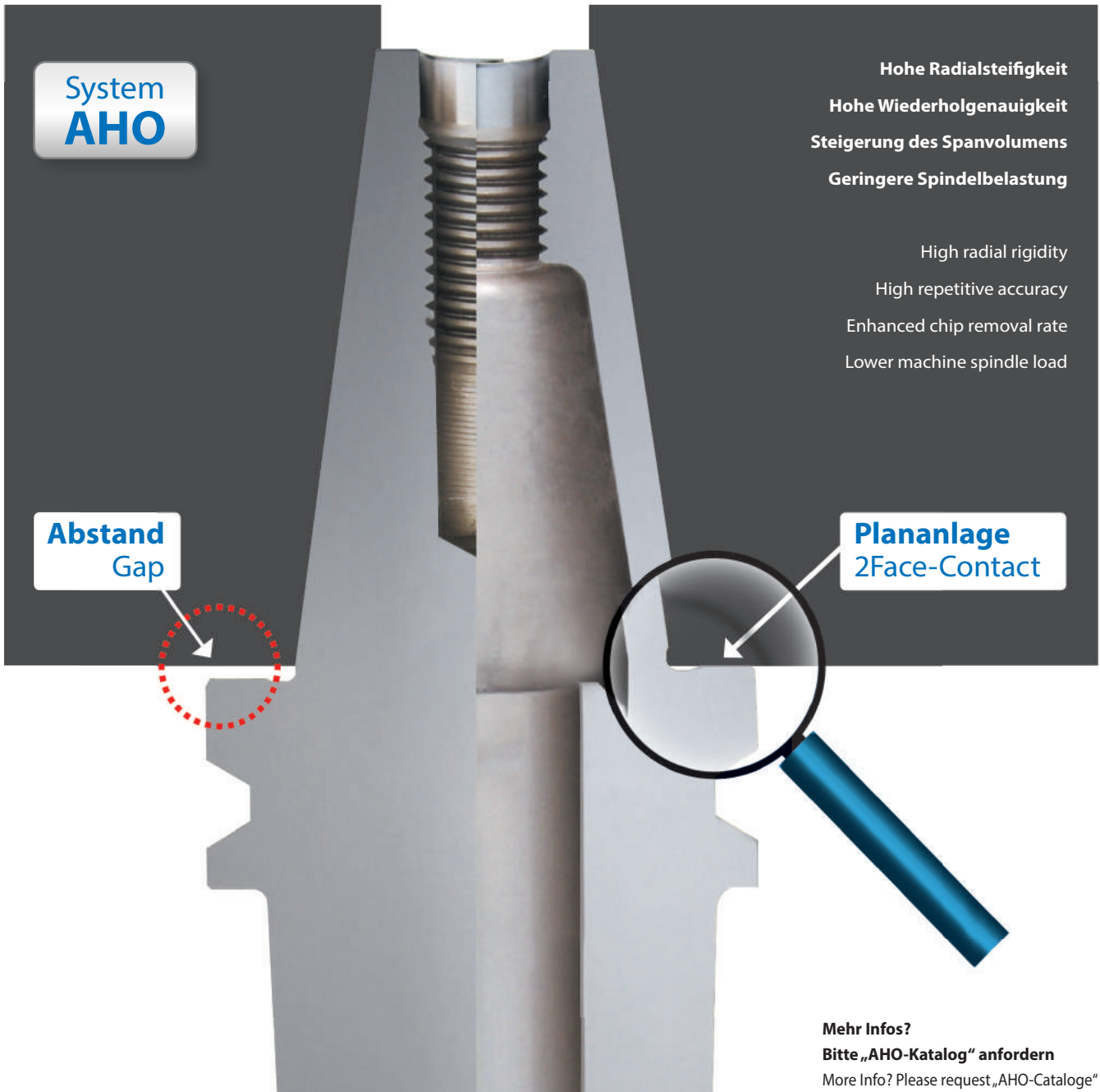

Mehr Infos?
Bitte „AHO-Katalog“ anfordern
 More Info? Please request „AHO-Catalogue“

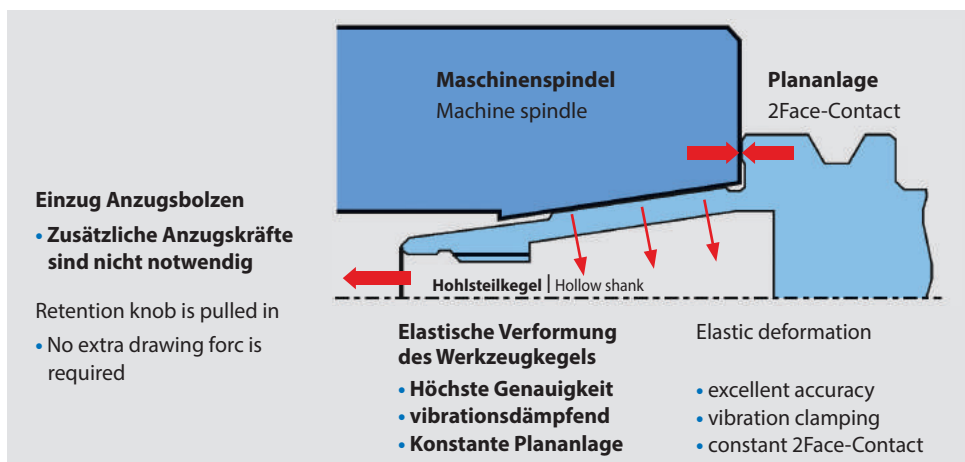

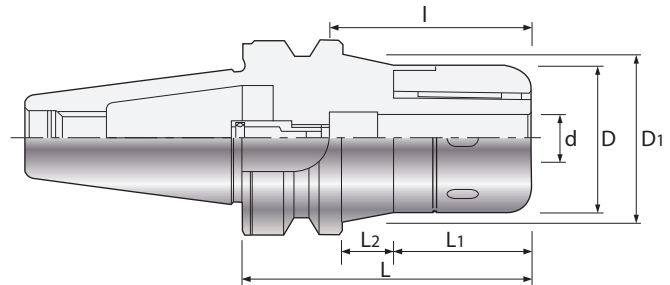

WBT

Mit Plananlage & Hohlsteilkegel
With 2Face-Contact & Hollow shank

3.0
32.0



0.005
3x D



max
20.000
min¹



Form
AD

JIS B6339

Halter Holder		d	D	D1	L	L1	L2	I		
WBT-AHO30	-CT16SA	-75	16	45	-	75	-	55	MC16-d	HS-1-16
		-90	16	45	-	90	-	70	MC16-d	HS-1-16
	-CT20SA	-75 ¹	20	52	-	75	-	55	MC20-d	HS-2-20
		-90	20	52	-	90	-	70	MC20-d	HS-2-20
		-105	20	52	-	105	-	80	MC20-d	HS-2-20
	-CT25SA	-90 ¹	25	61	-	90	-	70	MC25-d	HS-2.5-25
		-105	25	61	-	105	-	80	MC25-d	HS-2.5-25
	-CT32SA	-90 ¹	32	68	-	90	-	68	MC32-d	HS-3-32

Halter Holder		d	D	D1	L	L1	L2	I		
WBT-AHO40	-CT16SA	-75	16	45	-	75	-	60	MC16-d	HS-1-16
		-90	16	45	-	90	-	65	MC16-d	HS-1-16
	-CT20SA	-75	20	52	-	75	-	60	MC20-d	HS-2-20
		-90	20	52	-	90	-	75	MC20-d	HS-2-20
		-105	20	52	-	105	-	80	MC20-d	HS-2-20
	-CT20SA	-120 ²	20	52	-	120	-	80	MC20-d	HS-2-20
		-90	25	61	-	90	-	75	MC25-d	HS-2.5-25
		-105	25	61	-	105	-	80	MC25-d	HS-2.5-25
	-CT25SA	-120 ²	25	61	-	120	-	80	MC25-d	HS-2.5-25
		-135 ²	25	61	-	135	-	80	MC25-d	HS-2.5-25
		-90 ¹	32	73	-	90	-	75	MC32-d	HS-3-32
	-CT32SA	-105	32	73	-	105	-	85	MC32-d	HS-3-32
		-120 ²	32	73	-	120	-	90	MC32-d	HS-3-32
		-135 ²	32	73	-	135	-	105	MC32-d	HS-3-32

¹ MC-A Spann­hülsen nicht einsetzbar.

² BL-Einstellschraube nicht einsetzbar.

³ Nicht einsetzbar auf bestimmten BAZ.

 IKZ nur unter Verwendung des AHO-Anzugsbolzen mit Kühlmittelrohr möglich.

¹ MC-A Collets cannot be used.



² BL Back-up Screw cannot be used.

³ Take precautions against ATC.

 Inner coolant supply only possible by using AHO-Retention stud with coolant pipe.

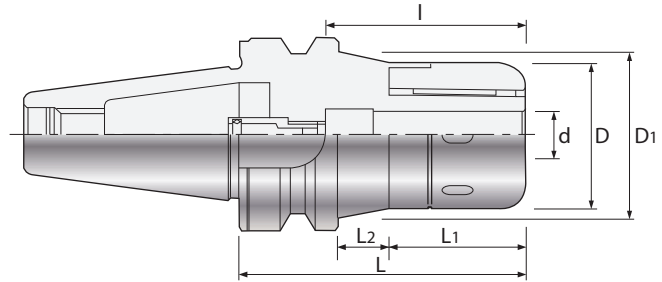



Halter Holder		d	D	D1	L	L1	L2	I			
WBT-AHO50	-CT16SA	-90	16	45	58	90	45	7	65	MC16-d	HS-1-16
		-105 ²	16	45	70	105	45	22	65	MC16-d	HS-1-16
	-CT20SA	-90	20	52	65	90	45	7	65	MC20-d	HS-2-20
		-105	20	52	65	105	60	7	80	MC20-d	HS-2-20
		-120 ²	20	52	70	120	58	24	80	MC20-d	HS-2-20
		-135 ²	20	52	73	135	58	39	80	MC20-d	HS-2-20
	-CT25SA	-105	25	61	82	105	56	11	80	MC25-d	HS-2.5-25
		-120 ²	25	61	82	120	56	26	80	MC25-d	HS-2.5-25
		-135 ²	25	61	83	135	56	41	80	MC25-d	HS-2.5-25
		-165 ²	25	61	86	165	56	71	80	MC25-d	HS-2.5-25
	-CT32SA	-95	32	73	-	95	-	-	75	MC32-d	HS-3-32
		-105	32	73	-	105	-	-	85	MC32-d	HS-3-32
		-120	32	73	87	120	56	26	100	MC32-d	HS-3-32
		-135	32	73	88	135	56	41	105	MC32-d	HS-3-32
		-150 ²	32	73	87	150	56	56	110	MC32-d	HS-3-32
-165 ²		32	73	86	165	56	71	120	MC32-d	HS-3-32	

¹ MC-A Spannhülsen nicht einsetzbar.

² MC Spannhülsen nicht einsetzbar.

³ BL-Einstellschraube nicht einsetzbar.

 IKZ nur unter Verwendung des AHO-Anzugsbolzen mit Kühlmittelrohr möglich.

¹ MC-A Collets cannot be used.

² MC Collets cannot be used.

³ BL Back-up Screw cannot be used.

 Inner coolant supply only possible by using AHO-Retention stud with coolant pipe.

ST-PHC·SB Hydro-Dehn-Verlängerung

Hydro Chuck extension

superschlanke Bauform und vibrationsdämpfend
super slim design and vibration damping

NEW



- optimal für CT-SA Kraftspannfutter
- optimal for CT-SA Milling Chucks



ST-PHC·SB

Hydro-Dehn-Verlängerung

Hydro Chuck extension

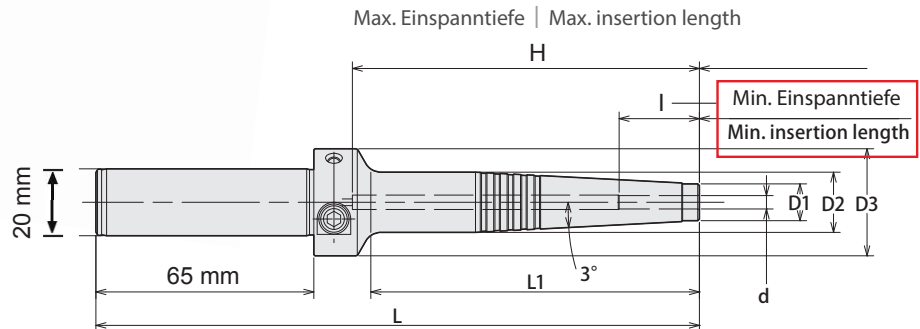

ST20

3.0
12.0



Halter Holder		d	D ₁	D ₂	D ₃	L	L ₁	I	H		
ST20	-PHC03SB	-180	3	11	18	32	180	98	16	103	-
	-PHC04SB	-180	4	11	18	32	180	98	19	103	-
	-PHC06SB	-180	6	13	20	32	180	99	27	103	-
	-PHC08SB	-180	8	15	22	32	180	99	27	101	-
	-PHC10SB	-180	10	17	24	32	180	100	33	101	-
	-PHC12SB	-180	12	19	26	32	180	100	36	101	HS12-d

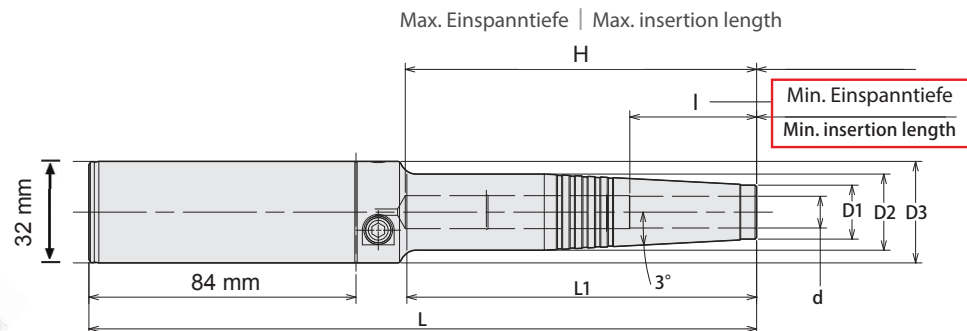

ST32

6.0
12.0



Halter Holder		d	D ₁	D ₂	D ₃	L	L ₁	I	H		
ST32	-PHC06SB	-210	6	13	20	32	210	110	27	103	-
	-PHC08SB	-210	8	15	22	32	210	110	27	111	-
	-PHC10SB	-210	10	17	24	32	210	110	33	111	-
	-PHC12SB	-210	12	19	26	32	210	110	36	111	HS12-d

- ohne Einstellschraube
- optimal für CT-SA Kraftspannfutter
- Nicht für Schrumpfaufnahmen geeignet

- without length adjustment screw
- ideal for CT-SA Milling Chuck
- Not applicable for Shrink fit

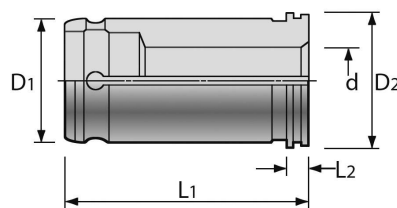

MC

MC Spannhülsen MC Straight Collets

Hülse Collet	D1	D2	L1	L2	d														
MC	-16-d	16	19	50	4	-	-	6	8	10	12	-	-	-	-	-	-	-	
	-20-d	20	24	60	4	-	4	6	8	10	12	14	16	18	-	-	-	-	
	-25-d	20	24	60	4	3	5	7	9	11	13	15	17	-	-	-	-	-	
	-32-d	25	29	60	4	-	-	6	8	10	12	-	16	-	20	-	-	-	-
	-32-d	32	36	72	4	-	4	6	8	10	12	14	16	18	20	25	-	-	-

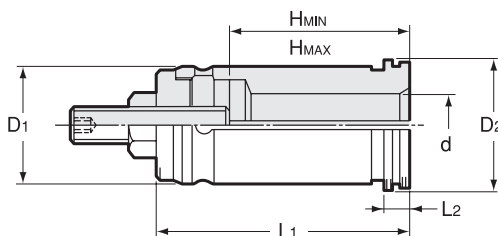

MC-A

MC-A Spannhülsen | mit Stellschraube zur Einstellung der Ausraglänge MC-A Straight Collets | with a bolt to adjust the tool-length

Hülse Collet	D1	D2	L1	L2	Hmax	d													
MC	-16-d	16	19	55	4	45	6	8	10	12	-	-	-	-	-	-	-		
	-20-d	20	24	65	4	55	6	8	10	12	16	-	-	-	-	-	-		
	-25-d	20	29	65	4	55	6	8	10	12	16	20	-	-	-	-	-		
	-32-d	32	36	79	4	66	6	8	10	12	16	20	25	-	-	-	-		

		Hmin								
Hülse Collet	D1	6	8	10	12	16	20	25	32	
MC-A	16	30	30	40	40	-	-	-	-	
	20	30	34	40	40	45	-	-	-	
	25	30	34	40	40	45	45	-	-	
	32	34	34	40	40	45	45	50	-	

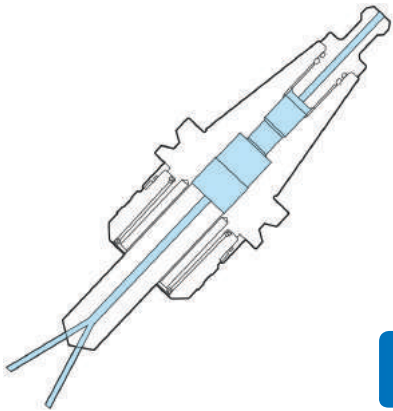

Spannhülsen für innere Kühlmittelzufuhr
Straight Collets for inner coolant supply

MC-OH

MC-OH Spannhülsen MC-OH Straight Collets

Hülse Collet		D1	D2	L1	L2	d										
MC	-16-d-OH	16	19	50	4	-	6	8	10	12	-	-	-	-	-	-
	-20-d-OH	20	24	60	4	4	6	8	10	12	14	16	18	-	-	-
	-25-d-OH	25	29	60	4	-	6	8	10	12	-	16	-	20	-	-
	-32-d-OH	32	36	72	4	4	6	8	10	12	14	16	18	20	25	-
	-20-d-OHSL	20	24	50	4	-	6	8	10	12	-	16	-	-	-	-

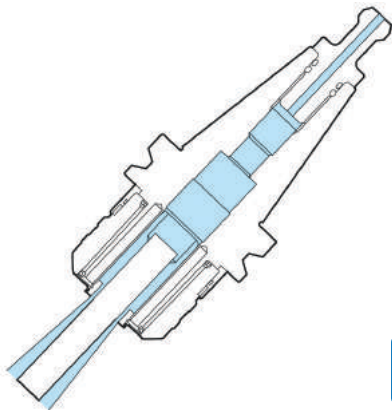

Spannhülsen für Peripheriekühlung
Straight Collets for side-through coolant

MC-C

MC-C Spannhülsen MC-C Straight Collets

Hülse Collet		D1	D2	L1	L2	d										
MC	-16-d-c	16	19	50	4	-	6	8	10	12	-	-	-	-	-	-
	-20-d-c	20	24	60	4	4	6	8	10	12	14	16	-	-	-	-
	-25-d-c	25	29	60	4	-	6	8	10	12	-	16	-	20	-	-
	-32-d-c	32	36	72	4	4	6	8	10	12	14	16	18	20	25	-

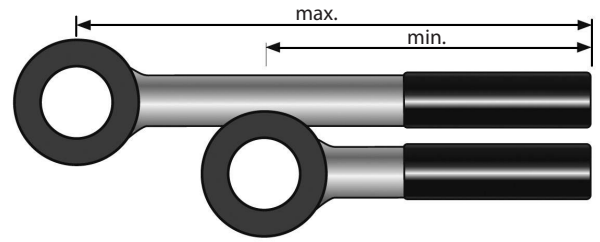
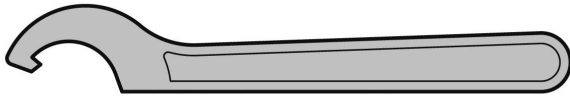

Spannschlüssel für Kraftspannfutter CT-S Series
Spanners for Milling Chucks CT-S Series

HS

Hakenschlüssel
Hook Spanner

Halter Holder		Hakenschlüssel Hookspanner
CT16SA		HS-1-16
CT20SA	CT20SA-C	HS-2-20
CT25SA	CT25SA	HS-2.5-25
CT32SA	CT32SA	HS-3-32

RS

RS Rollenschlüssel
Teleskopausführung
RS Roller Spanner
Telescope type

Halter Holder		Rollenschlüssel Roller spanner	min. max.
CT20SA	CT20S-P	RS-20	250-370
CT25SA	CT25S-P	RS-25	280-400
CT32SA	CT32S-P	RS-32	280-400

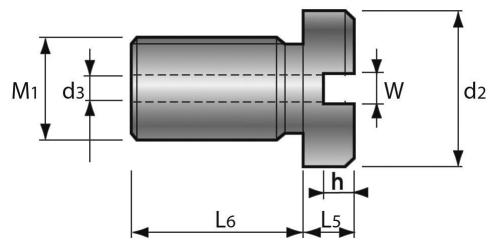

BL

BL Anschlagschraube | für Kraftspannfutter mit SK, BT, POLYGON-Schaft
BL Back-up screw | for Milling Chucks with SK, BT, POLYGON interface

Schraube Screw	d2	d3	L5	L6	M1 P = 1.0	W	h	Halter Holder
BL -16-L5	15	4.5	5, 15, 25	14	10	5	3.5	CT16SA
-20-L5	18	4.5	5, 15, 25	14	12	5	3.5	CT20SA, CT25SA
-32-L5	25	4.5	10, 20, 35	14	18	5	5	CT32SA, CT42SA

BL

BL Anschlagschraube | für Kraftspannfutter mit HSK-A-Schaft
BL Back-up screw | for Milling Chucks with HSK-A-interface

Schnittstelle Interface	d2	d3	L5	L6	M1	W	h
HSK-A 40 50	13	2.5	5, 15, 25	8.5	M5 x0.8	5	2.5
HSK-A 63 80	15	4	5	5.5	M8 x1.25	5	3
HSK-A 63 80	15	4	15, 25	7.5	M8 x1.25	5	3
HSK-A 100 125	15	4.5	5, 15, 25	14.0	M10 x1.5	5	3.5

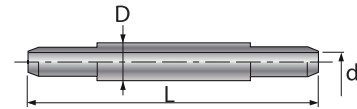
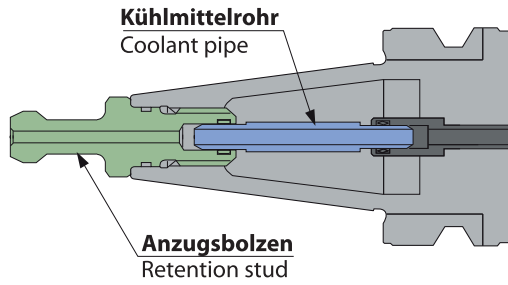

AHO Hohlsteilkegel Hollow shank

CP Kühlmittelrohr Coolant Pipe

IKZ nur unter Verwendung des AHO-Anzugsbolzen mit Kühlmittelrohr möglich.

Inner coolant supply only possible by using AHO-Retention stud with coolant pipe.

Kühlmittelrohr Coolant pipe	d	D	L
CP-NBT30-OH	3	6	42
CP-NBT40-OH	4	8	70
CP-NBT50-OH	7	13	98

Lieferumfang:
AHO-Anzugsbolzen mit Kühlmittelrohr
Scope of delivery:
AHO-Retention stud with coolant pipe

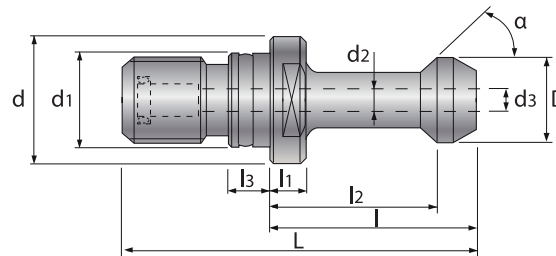

PSB Anzugsbolzen Retention stud

Anzugsbolzen Retention Stud	Steilkegel Taper	Standard	D 0 -0.1	d ₁ h ₇	d ₂	L	ℓ	ℓ ₂	ℓ ₃	G	θ	Type	d ₃	θ ₂
PSB-0-CH-AHO	30	MAS-1	11	12.5	7	43	23	18	5.5	M12	45°	1	2.5	—
PSB-30P-AHO	30	JIS	12	12.5	8	43	23.4	18.4	6	M12	75°	1	4	—
PSB-1T-AHO	30	—	11	12.5	8	43	23	18	5.5	M12	45°	1	4	—
PSB-26-CH-AHO	30	—	11	12.5	7.5	43	23	18	5.5	M12	60°	1	2.5	—
PSB-3-CH-AHO	40	MAS-1	15	17	10	60	35	28	7	M16	45°	1	4	—
PSB-31-CH-AHO	40	MAS-1	15	17	10	60	35	28	7	M16	45°	3	3	30°
PSB-4-CH-AHO	40	MAS-2	15	17	10	60	35	28	7	M16	60°	1	4	—
PSB-38-CH-AHO	40	MAS-2	15	17	10	60	35	28	7	M16	60°	3	3	30°
PSB-40P-AHO	40	JIS	19	17	14	54	29	23	7	M16	75°	1	7	—
PSB-32-CH-AHO	40	JIS	19	17	14	54	29	23	7	M16	75°	1	4	—
PSB-23-CH-AHO	40	—	18.8	17	12.5	44.1	19.1	14	5	M16	45°	1	7	—
PSB-25-CH-AHO	40	—	19	17	14	54	29	23	7	M16	75°	3	7	30°
PSB-7-CH-AHO	50	MAS-1	23	25	17	85	45	35	10	M24	45°	1	6	—
PSB-33-CH-AHO	50	MAS-1	23	25	17	85	45	35	10	M24	45°	3	6	30°
PSB-35-CH-AHO	50	MAS-1	23	25	17	85	45	35	10	M24	45°	3	5.5	60°
PSB-8-CH-AHO	50	MAS-2	23	25	17	85	45	35	10	M24	60°	1	6	—
PSB-36-CH-AHO	50	MAS-2	23	25	17	85	45	35	10	M24	60°	3	5.5	60°
PSB-39-CH-AHO	50	MAS-2	23	25	17	85	45	35	10	M24	60°	3	6	30°
PSB-50P-AHO	50	JIS	28	25	21	74	34	25	10	M24	75°	1	10	—
PSB-37-CH-AHO	50	JIS	28	25	21	74	34	25	10	M24	75°	3	5.5	60°
PSB-17-CH-AHO	50	—	24	25	18	71	31	23	10	M24	90°	1	6	—
PSB-19-CH-AHO	50	—	23	25	17	85	45	35	10	M24	90°	1	6	—
PSB-24-CH-AHO	50	—	29	25	20.9	65.2	25.2	17.6	8	M24	45°	1	10	—
PSB-27-CH-AHO	50	—	23	25	17	85	45	35	10	M24	90°	3	8	30°

**Spannkompetenz
aus einer Hand**
Clamping expertise
from a single source

NT TOOL EUROPE GmbH

Siemensstrasse 17 A, 61449 Steinbach, Germany
Tel.: +49-(0)6171-91639 - 0, Fax: +49-(0)6171-91639-90
info@nttooleurope.com, www.nttooleurope.com



Hochleistungs-Kraftspannfutter
High Performance Milling Chucks



Power-Dehnspannfutter Serie
Power Hydro Chuck Series

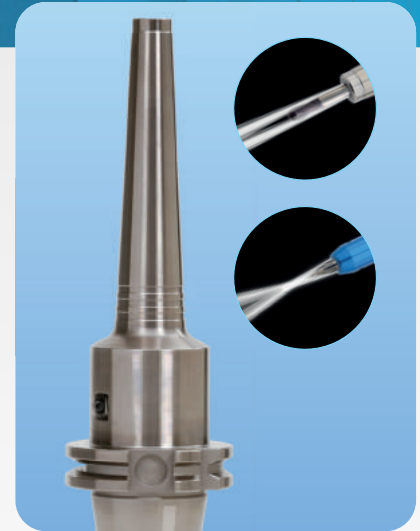

Dehnspannfutter superschlank
Slim Hydro Chucks



Hochgenauigkeits-Spannzangenfutter
High Precision Collet Chucks



Spannsysteme mit Rundlauf "0"
R-Zero Tooling



SynchroFit-Gewindeschneidfutter
SynchroFit Tapping Holder

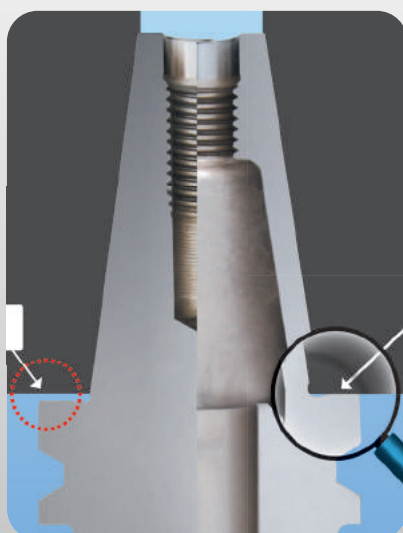

Aufnahmen mit Plananlage
2Face-Contact Tooling

**Druckfehler, Irrtümer und
Änderungen vorbehalten**
Printing errors, mistakes and
changes reserved

Fachhandel | Distributor: