

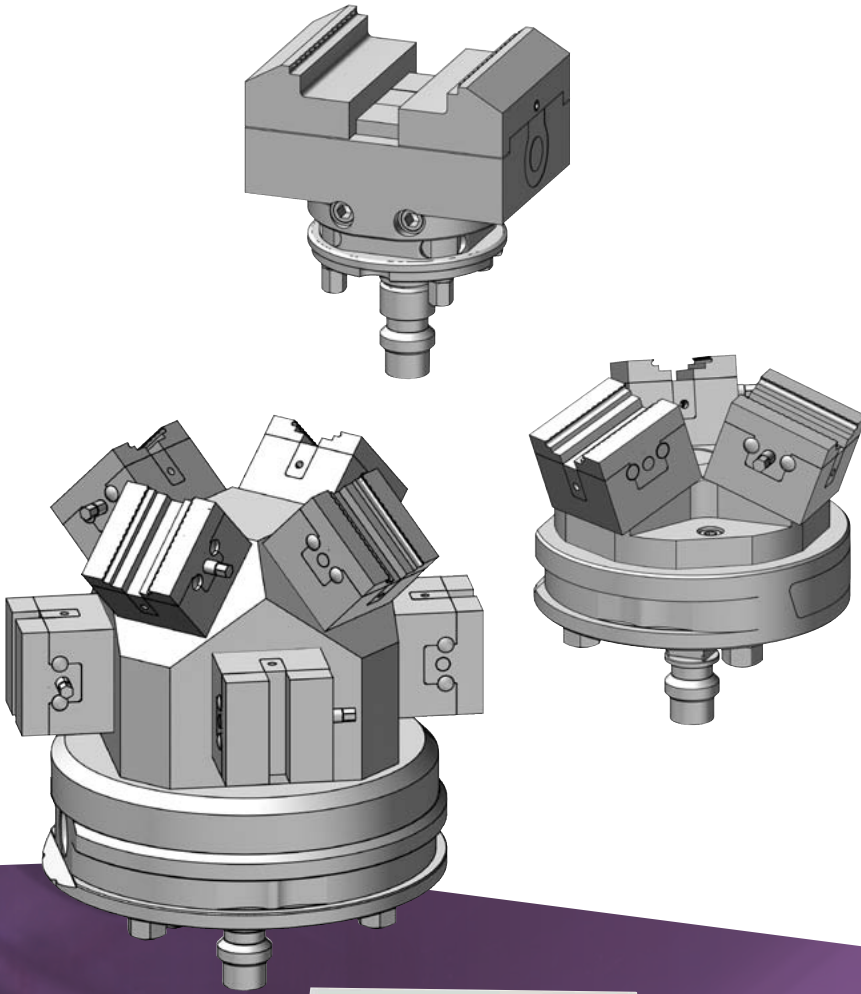

Maschinenspezifische Spannlösungen
Machine specific workholding solutions



TRIAG
INTERNATIONAL



RXP500DS
RXP500DSC
RXP501DS
RXP501DSC







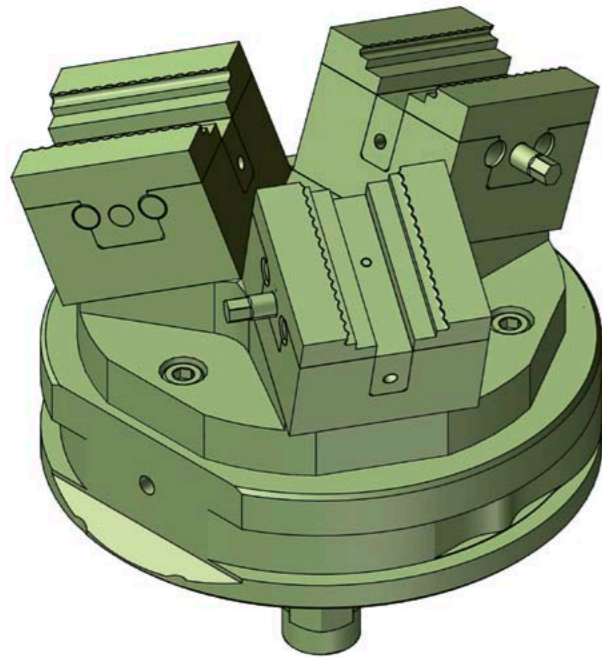

triCENTRO

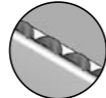
5-Achs Mehrfachspannpyramide mit Erowa Schnittstelle
5-axis multiple workholding pyramid with Erowa interface



- 7** Backenvarianten
Jaw variants
-  2,2 mm Direkt-Prägebacken
2,2 mm Direct stamping jaws
-  «Sputnik» 5-Achs Mehrfachspannpyramide
«Sputnik» 5-axis multiple workholding pyramid
-  EROWA Schnittstelle
EROWA interface
-  Beste Zugänglichkeit
Best accessibility

Bestellschlüssel Order code	Bezeichnung Description	~ Kg	Spannstellen Clamping areas	Winkel Angle	Spannbereich Clamping area
 RD500-SET1	Röders Set 1	3,65	3	20°	12 - 22

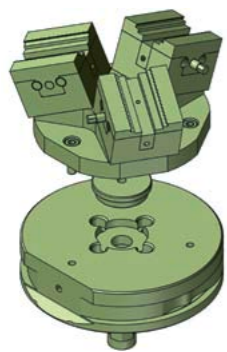

Drehmoment Torque		Spannkraft Workholding force		
Nm	(lb-ft)	~daN	~(lb)	~t
4	3	= 457	1'007	0,46
5	3,7	= 571	1'259	0,57
6	4,4	= 686	1'512	0,69
7	5,2	= 800	1'764	0,8

Backen gemäss Zusammenstellzeichnung falls nicht anders vereinbart.
Jaws according to assembly drawing if not agreed otherwise.

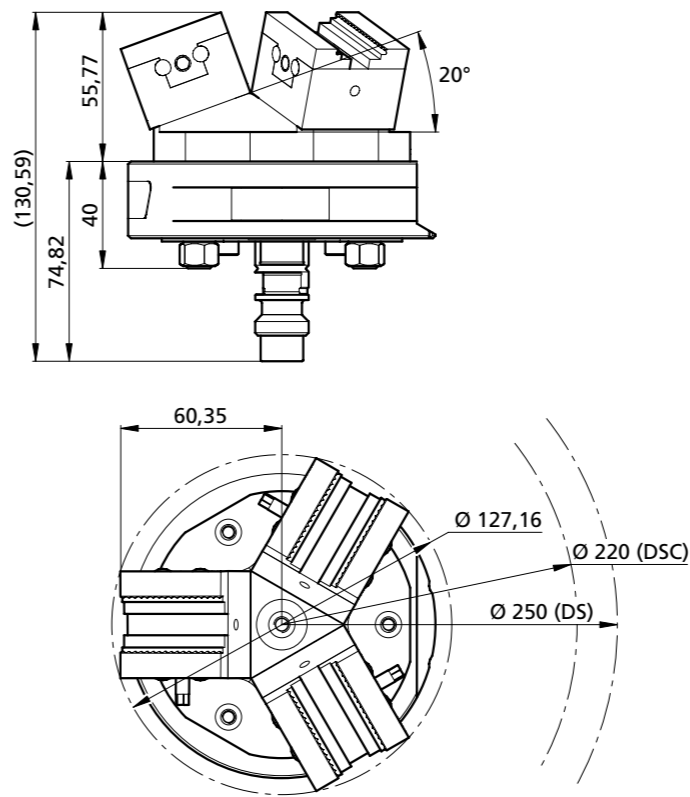

	X	Y	Z	max.		
				Ø	H	kg
RXP500DS	450 (X-316 X+134)	658 (Y-204 Y+454)	240	250	220	60
RXP500DSC	450 (X-316 X+134)	658 (Y-204 Y+454)	240	220	200	30
RXP501DS	500 (X-366 X+134)	700 (Y-230 Y+470)	300	250	200	60
RXP501DSC	500 (X-366 X+134)	700 (Y-230 Y+470)	300	220	200	30

MICRO

Backenvarianten
Jaw variants

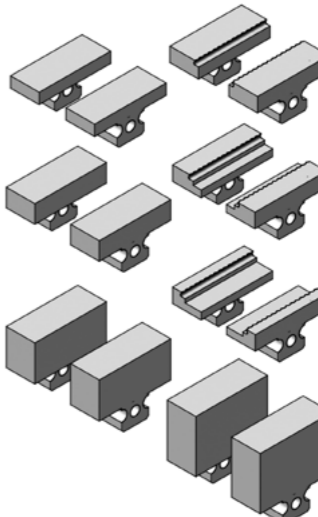

Mehr auf Seite 11
More on page 11

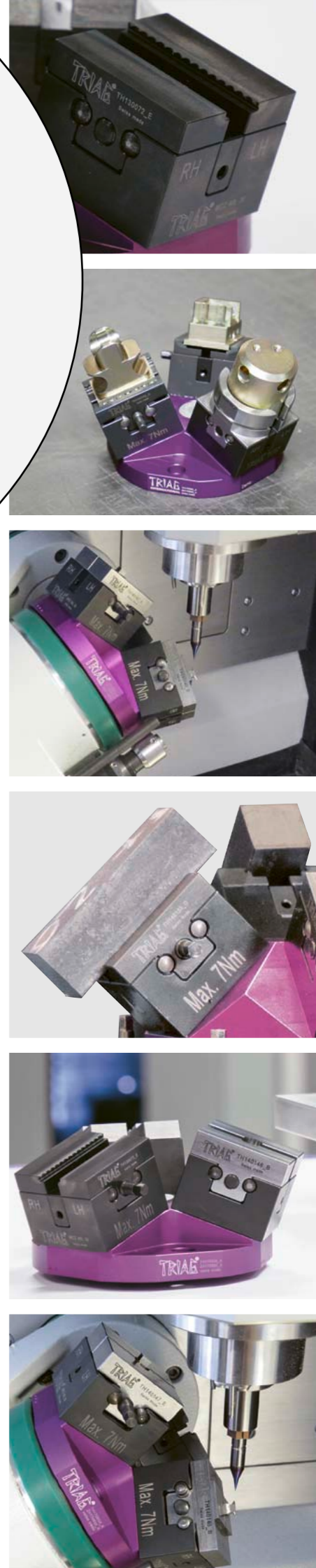





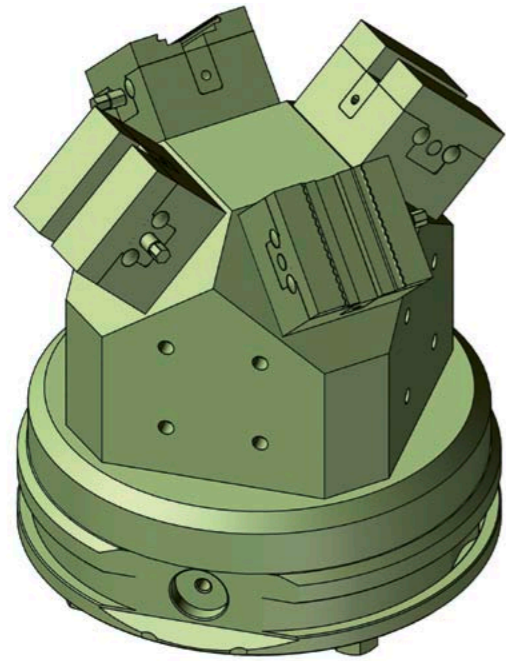

triCENTRO

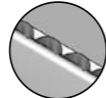
5-Achs Mehrfachspannpyramide mit Erowa Schnittstelle
5-axis multiple workholding pyramid with Erowa interface



- 7** Backenvarianten
Jaw variants
-  2,2 mm Direkt-Prägebacken
2,2 mm Direct stamping jaws
-  «Sputnik» 5-Achs Mehrfachspannpyramide
«Sputnik» 5-axis multiple workholding pyramid
-  EROWA Schnittstelle
EROWA interface
-  Beste Zugänglichkeit
Best accessibility

Bestellschlüssel Order code	Bezeichnung Description	~ Kg	Spannstellen Clamping areas	Winkel Angle	Spannbereich Clamping area
 RD500-SET2	Röders Set 2	4,13	4	45°	12 - 22

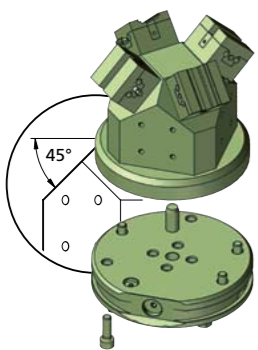

Drehmoment Torque		Spannkraft Workholding force		
Nm	(lb-ft)	~daN	~(lb)	~t
4	3	= 457	1'007	0,46
5	3,7	= 571	1'259	0,57
6	4,4	= 686	1'512	0,69
7	5,2	= 800	1'764	0,8

Backen gemäss Zusammenstellzeichnung falls nicht anders vereinbart.

Jaws according to assembly drawing if not agreed otherwise.

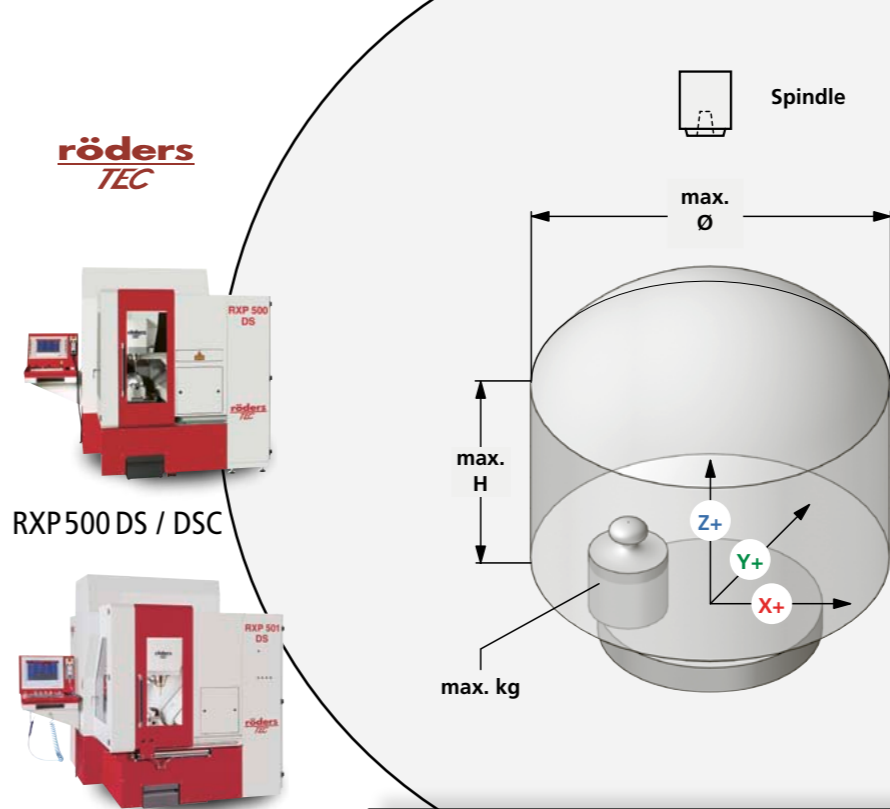

RXP500 DS / DSC



RXP501 DS / DSC

	X	Y	Z	max.		
				Ø	H	kg
RXP500DS	450 (X-316 X+134)	658 (Y-204 Y+454)	240	250	220	60
RXP500DSC	450 (X-316 X+134)	658 (Y-204 Y+454)	240	220	200	30
RXP501DS	500 (X-366 X+134)	700 (Y-230 Y+470)	300	250	200	60
RXP501DSC	500 (X-366 X+134)	700 (Y-230 Y+470)	300	220	200	30

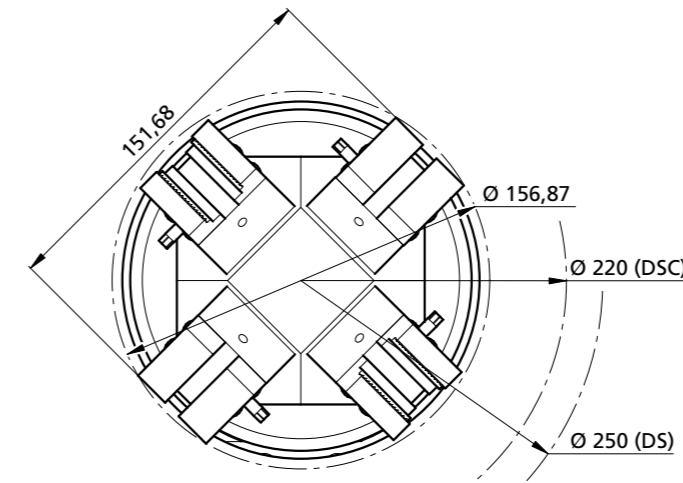
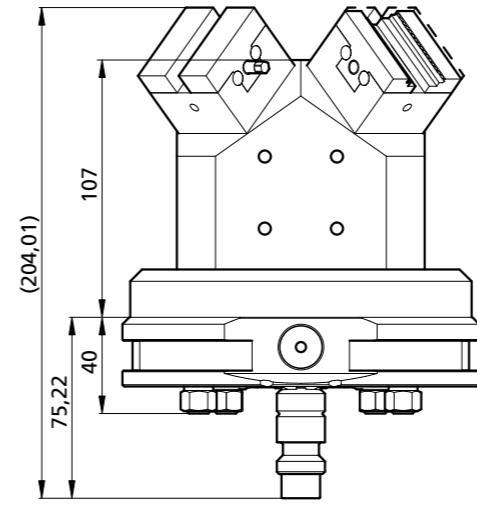

MICRO

Backenvarianten
Jaw variants

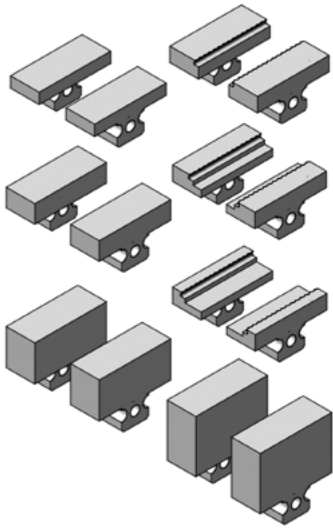

Mehr auf Seite 11
More on page 11

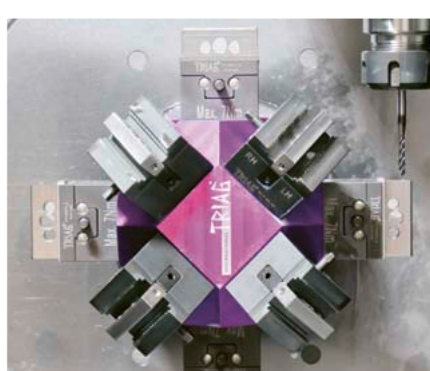





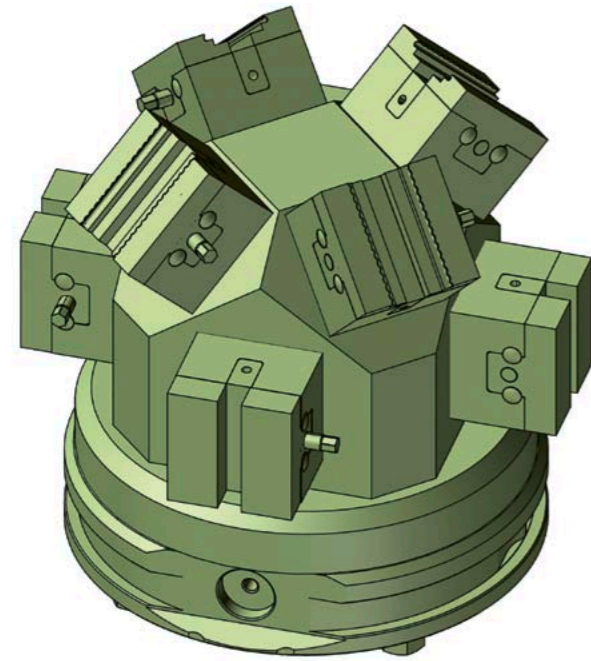

triCENTRO

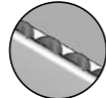
5-Achs Mehrfachspannpyramide mit Erowa Schnittstelle
5-axis multiple workholding pyramid with Erowa interface



- 7** Backenvarianten
Jaw variants
-  2,2 mm Direkt-Prägebacken
2,2 mm Direct stamping jaws
-  «Sputnik» 5-Achs Mehrfachspannpyramide
«Sputnik» 5-axis multiple workholding pyramid
-  EROWA Schnittstelle
EROWA interface
-  Beste Zugänglichkeit
Best accessibility

Bestellschlüssel Order code	Bezeichnung Description	~ Kg	Spannstellen Clamping areas	Winkel Angle	Spannbereich Clamping area
 RD500-SET3	Röders Set 3	8,7	8	45°	12 - 22

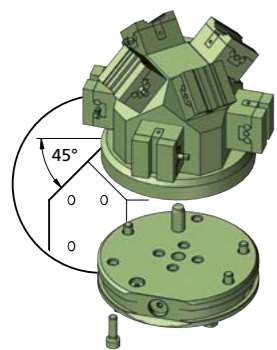

Drehmoment Torque		Spannkraft Workholding force		
Nm	(lb-ft)	~daN	~(lb)	~t
4	3	= 457	1'007	0,46
5	3,7	= 571	1'259	0,57
6	4,4	= 686	1'512	0,69
7	5,2	= 800	1'764	0,8

Backen gemäss Zusammenstellzeichnung
falls nicht anders vereinbart.

Jaws according to assembly drawing
if not agreed otherwise.

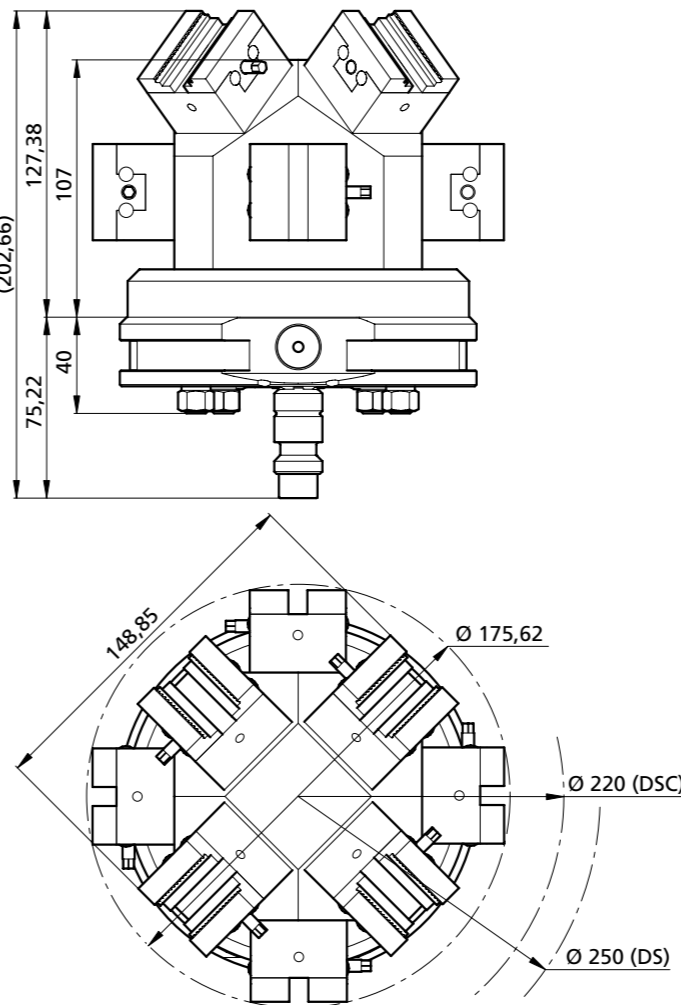

	X	Y	Z	max.		
				Ø	H	kg
RXP500DS	450 (X-316 X+134)	658 (Y-204 Y+454)	240	250	220	60
RXP500DSC	450 (X-316 X+134)	658 (Y-204 Y+454)	240	220	200	30
RXP501DS	500 (X-366 X+134)	700 (Y-230 Y+470)	300	250	200	60
RXP501DSC	500 (X-366 X+134)	700 (Y-230 Y+470)	300	220	200	30

MICRO

Backenvarianten
Jaw variants

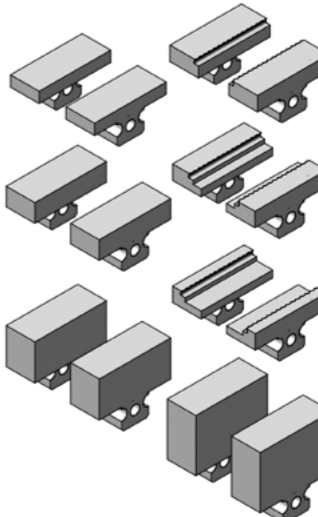

Mehr auf Seite 11
More on page 11

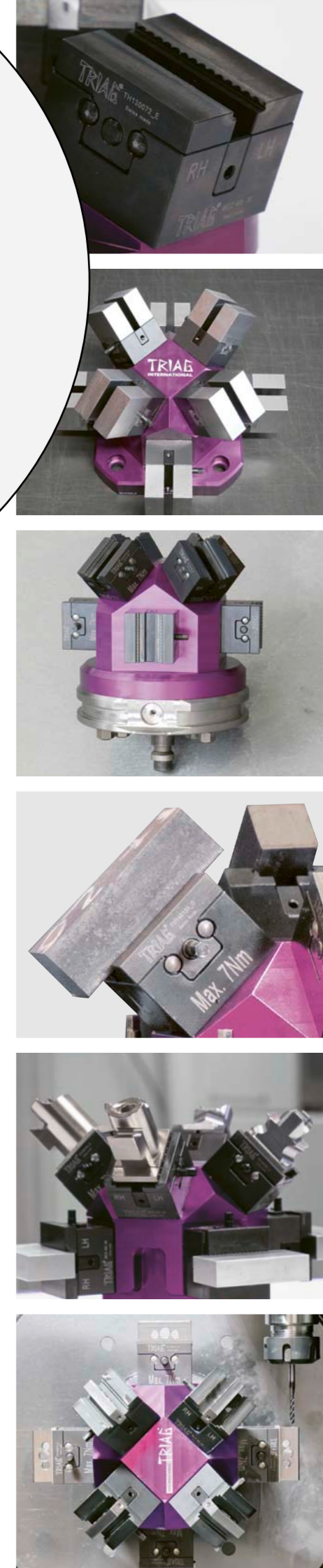



trICENTRO

Mini-Zentrischspanner inkl. Adapterflansch
Mini self centering vises incl. adapter flange

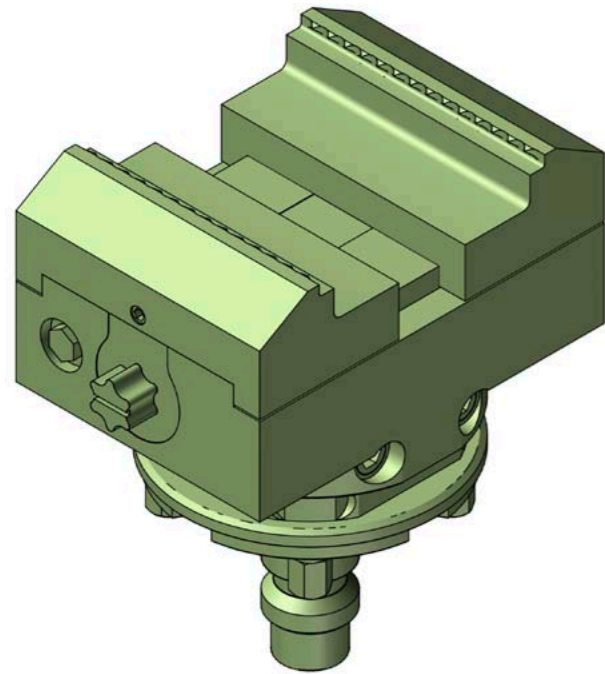

- 14** Backenvarianten
Jaw variants
- 3mm Direkt-Prägebacken
3mm Direct stamping jaws
- Backen-Schnellwechselsystem
Quick-change jaw system
- Beste Zugänglichkeit
Best accessibility

Bestellschlüssel Order code	Bezeichnung Description	~ Kg	Spannstellen Clamping areas	Spannbereich Clamping area
RD500-SET4	Röders Set 4	3,02	1	44 - 64



Drehmoment Torque		Spannkraft Workholding force		
Nm	(lb-ft)	~daN	~(lb)	~t
10	7,4	= 200	440	0,2
20	14,8	= 500	1'102	0,5
30	22,2	= 1'000	2'204	1,0
40	29,6	= 1'300	2'866	1,3
50	37,0	= 1'600	3'527	1,6

Backen gemäss Zusammenstellzeichnung
falls nicht anders vereinbart.

Jaws according to assembly drawing
if not agreed otherwise.

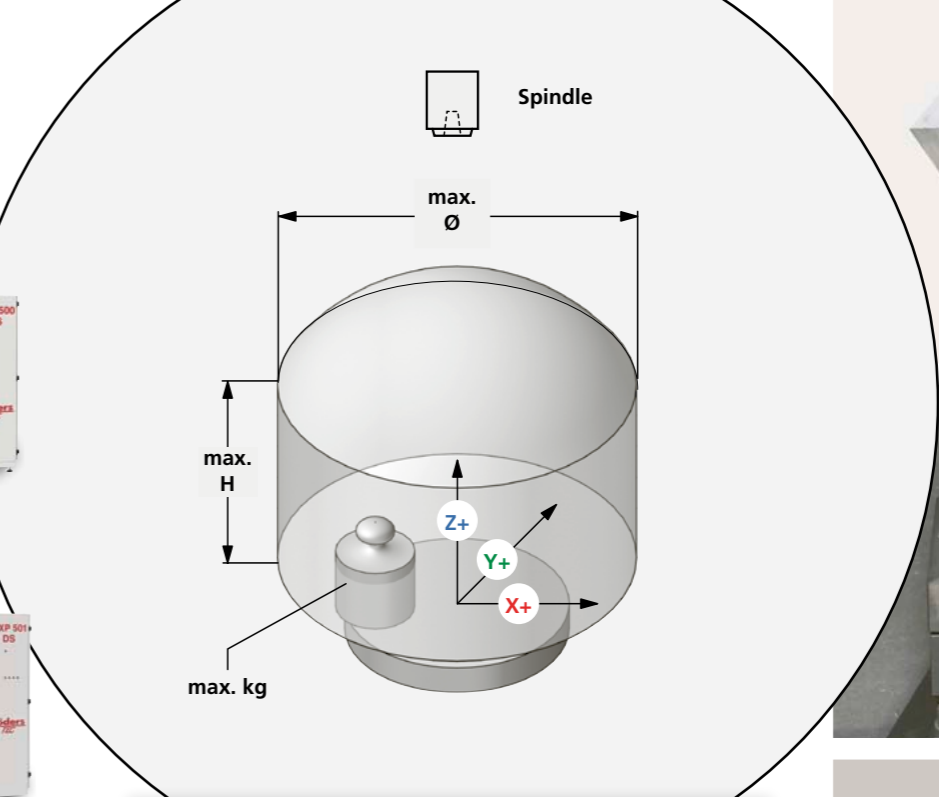
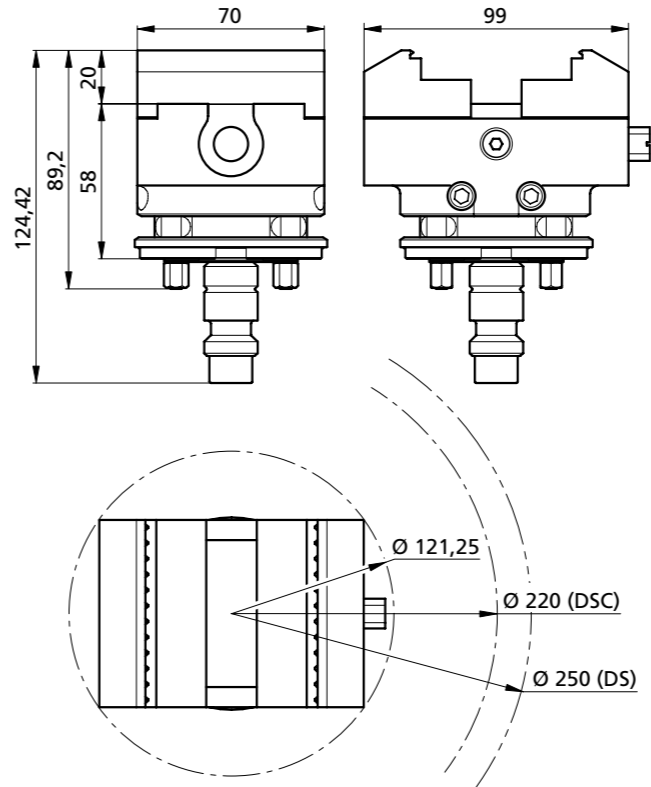

	X	Y	Z	max.		
				Ø	H	kg
RXP500DS	450 (X-316 X+134)	658 (Y-204 Y+454)	240	250	220	60
RXP500DSC	450 (X-316 X+134)	658 (Y-204 Y+454)	240	220	200	30
RXP501DS	500 (X-366 X+134)	700 (Y-230 Y+470)	300	250	200	60
RXP501DSC	500 (X-366 X+134)	700 (Y-230 Y+470)	300	220	200	30

MINI
Backenvarianten
Jaw variants

Mehr auf Seite
More on page 10



Drehmoment Torque		Spannkraft Workholding force		
Nm	(lb-ft)	~daN	~(lb)	~t
10	7,4	= 200	440	0,2
20	14,8	= 500	1'102	0,5
30	22,2	= 1'000	2'204	1,0
40	29,6	= 1'300	2'866	1,3
50	37,0	= 1'600	3'527	1,6

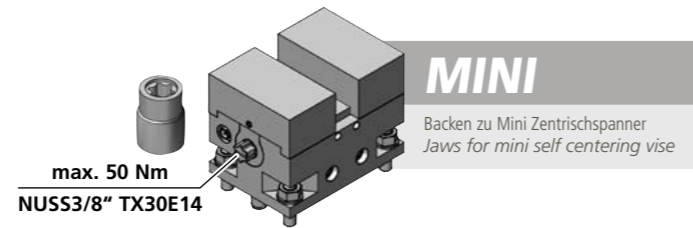

Prägebacken Stamping jaws	B175-26 Spannbereich / Clamping range 6-26 mm C = 70 H = 20 L = 40 i 57HRC	B175-45 Spannbereich / Clamping range 25-45 mm C = 70 H = 20 L = 40 i 57HRC	B175-64 Spannbereich / Clamping range 44-64 mm C = 70 H = 20 L = 40 i 57HRC
	B175-83 Spannbereich / Clamping range 63-83 mm C = 70 H = 20 L = 40 i 57HRC	B175-102 Spannbereich / Clamping range 83-102 mm C = 70 H = 20 L = 50 i 57HRC	B175-121 Spannbereich / Clamping range 101-121 mm C = 70 H = 20 L = 60 i 57HRC
Stufenbacken Stepped jaws	B173-26 Spannbereich / Clamping range 6-26 mm C = 70 H = 24 L = 40 i HV700 x 0,2 mm	B173-45 Spannbereich / Clamping range 25-45 mm C = 70 H = 24 L = 40 i HV700 x 0,2 mm	B173-64 Spannbereich / Clamping range 44-64 mm C = 70 H = 24 L = 40 i HV700 x 0,2 mm
	B173-83 Spannbereich / Clamping range 63-83 mm C = 70 H = 24 L = 40 i HV700 x 0,2 mm	B173-102 Spannbereich / Clamping range 82-102 mm C = 70 H = 24 L = 50 i HV700 x 0,2 mm	B170, B172 (weich / soft) Spannbereich / Clamping range 0-20 mm C = 70 H = 24 L = 40 i HV700 x 0,2 mm
Universalbacken Universal jaws	B176-80 Spannbereich / Clamping range 8-80 mm *PRG1003M8 C = 70 H = 24 L = 40 *PRG1003M8 Optional erhältlich / Optional accessory		

Für mehr Informationen, Zubehör oder Backensets > [Gesamtkatalog/triCENTRO](#)
For further informations, accessories or jaw sets > [General catalogue/triCENTRO](#)



Drehmoment Torque		Spannkraft Workholding force		
Nm	(lb-ft)	~daN	~(lb)	~t
4	3	= 457	1'007	0,46
5	3,7	= 571	1'259	0,57
6	4,4	= 686	1'512	0,69
7	5,2	= 800	1'764	0,8

Prägebacken Stamping jaws	B190-13 Spannbereich / Clamping range 3-13 mm	B190-22 Spannbereich / Clamping range 12-22 mm	B190-31 Spannbereich / Clamping range 21-31 mm
	B190W6-40 Spannbereich / Clamping range 0-10 mm H1 = 2,2 H = 6 i 1.7225	B190W10-40 Spannbereich / Clamping range 0-10 mm H1 = 6,2 H = 10 i 1.7225	B190W20-40 Spannbereich / Clamping range 0-10 mm H1 = 16,2 H = 20 i 1.7225
Formbacke weich Dedicated jaws	B190W30-40 Spannbereich / Clamping range 0-10 mm H1 = 26,2 H = 30 i 1.7225	H1: Zum Erstellen Ihrer individuellen Formbacke: Schnittzeichnung zum Ermitteln der max. Bearbeitungsprofiltiefe H1: If a dedicated jaw is being machined: Sectional drawing to determine the maximum machining depth.	

Für mehr Informationen, Zubehör oder Backensets > [Gesamtkatalog/triCENTRO](#)
For further informations, accessories or jaw sets > [General catalogue/triCENTRO](#)

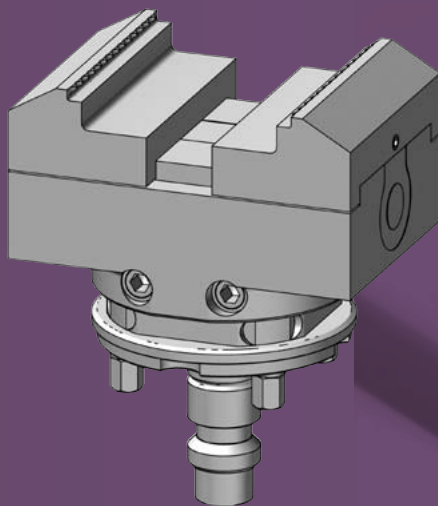
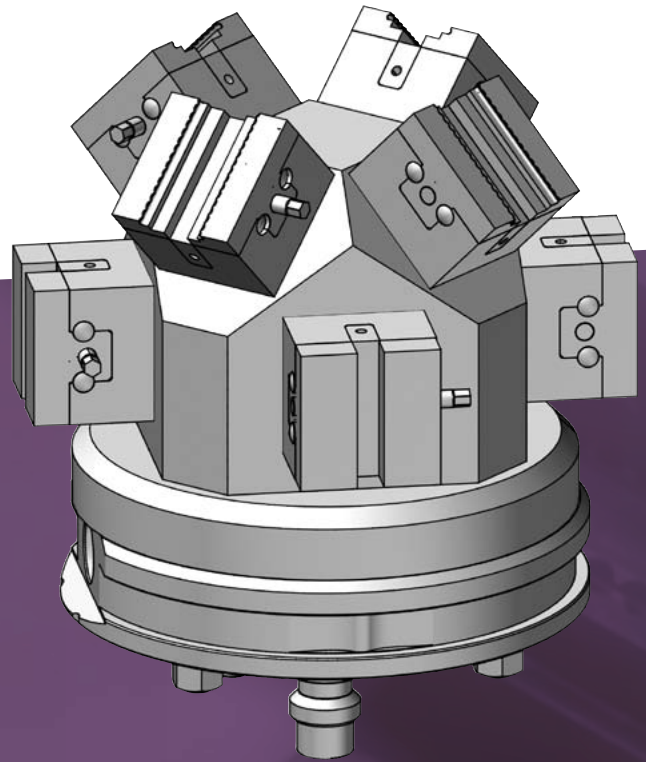
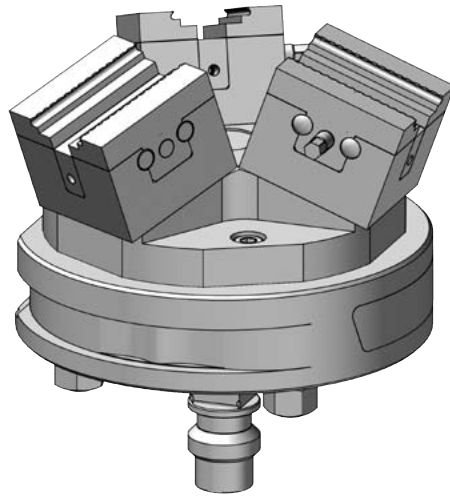

Triag International AG

Bösch 84 CH-6331 Hünenberg

☎ +41 41 727 27 77

✉ spannen@triag-int.ch

✉ clamping@triag-int.ch

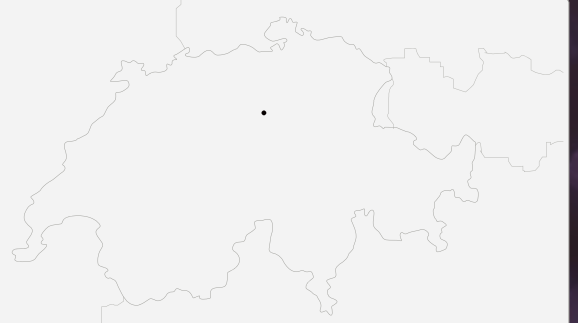

Mass- und Konstruktionsänderungen
bleiben uns vorbehalten. *We reserve
the right to modify dimensions and
structural design.*

triag-int.ch

Official Website



11
21