

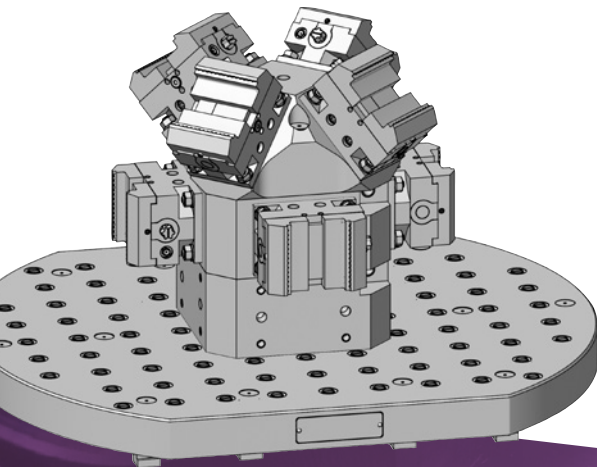

Maschinenspezifische Spannlösungen
Machine specific workholding solutions

swiss 
MODULAR[®]

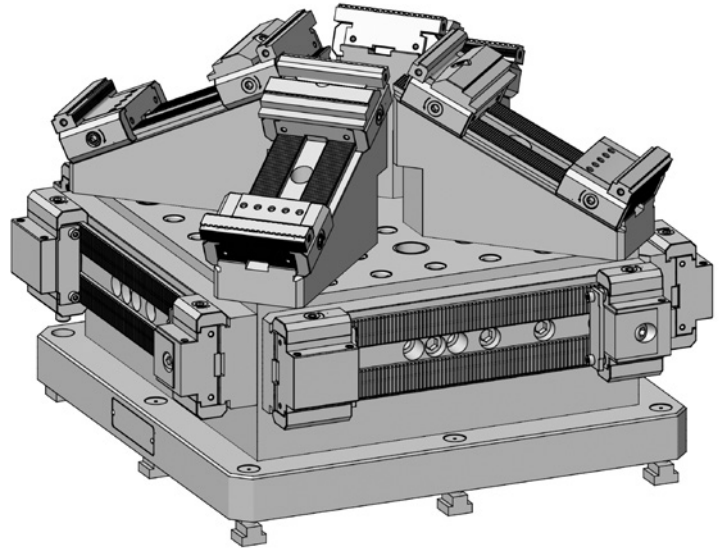
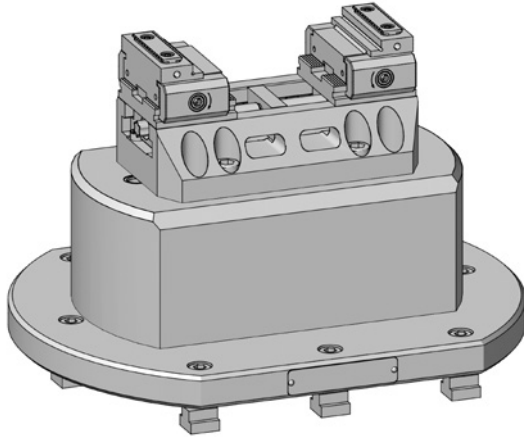

DMG MORI
DMU 50



DMU50 3. GENERATION **DMG MORI**

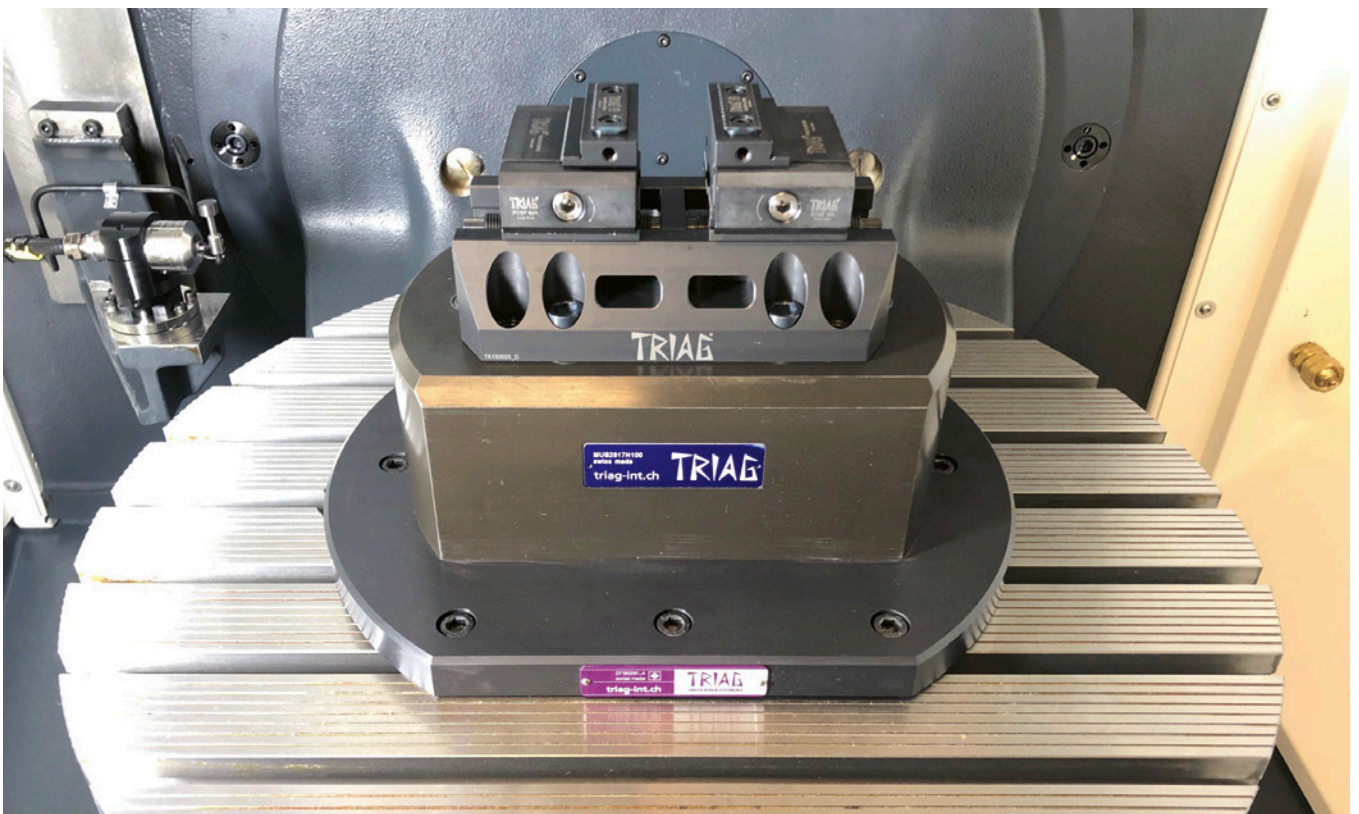
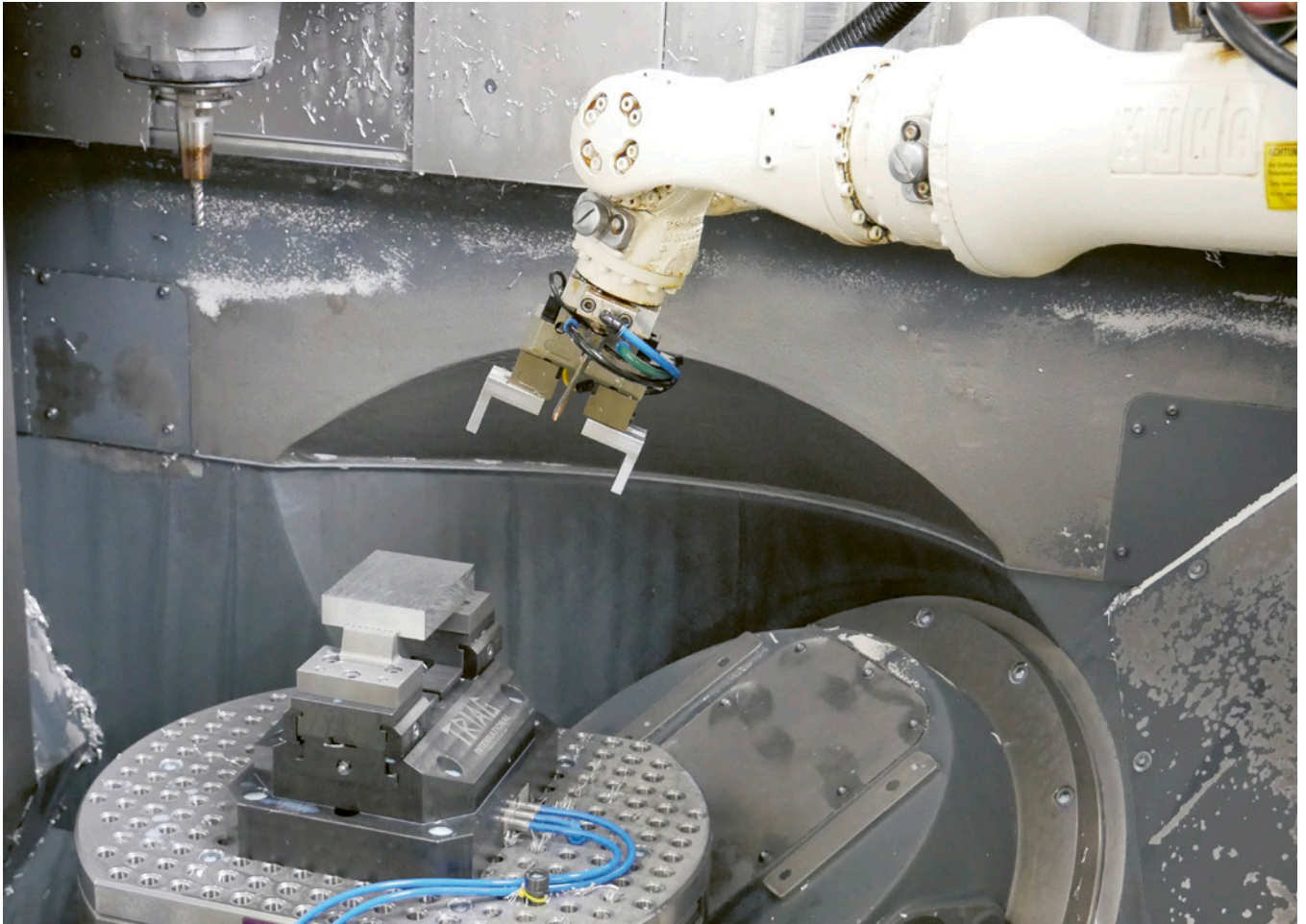



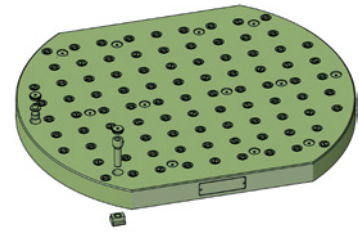

Rasterplatte Ø 600 x 500
Gridplatte Ø 600 x 500

swiss 
MODULAR®

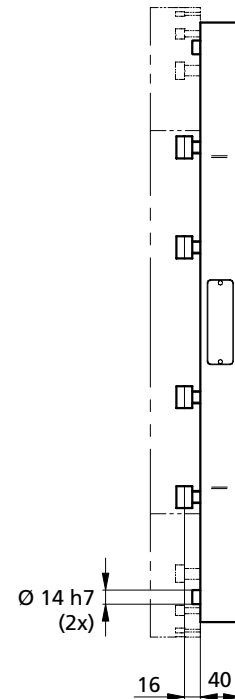
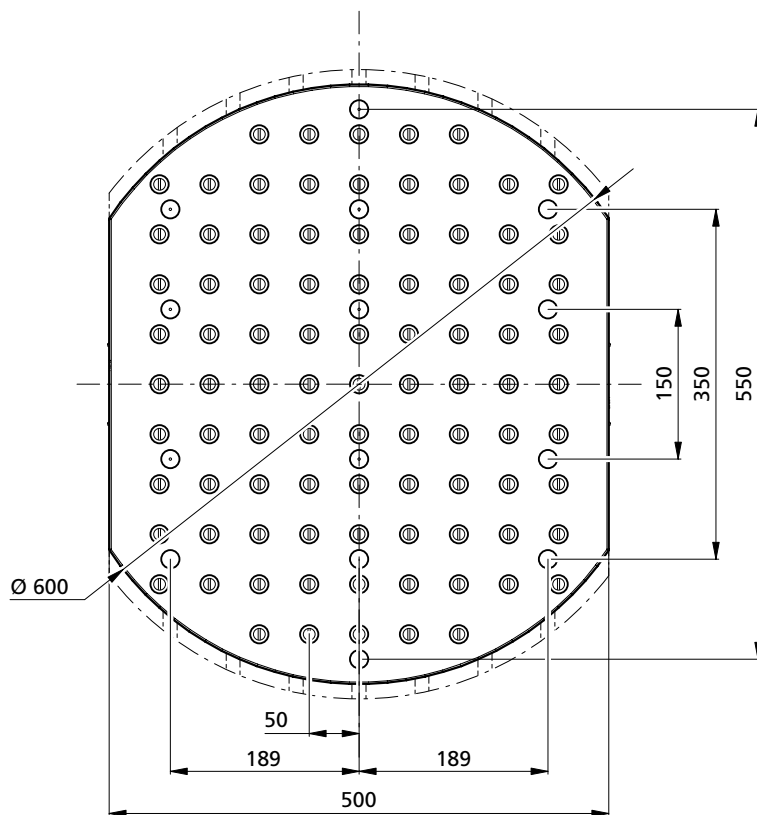

DM-DMU50-SET0



 Artikel Nr. und Inhalt Article Nr. and content	Bezeichnung Description	~ Kg
 DM-DMU50-SET0	Rasterplatte / Grid plate	80





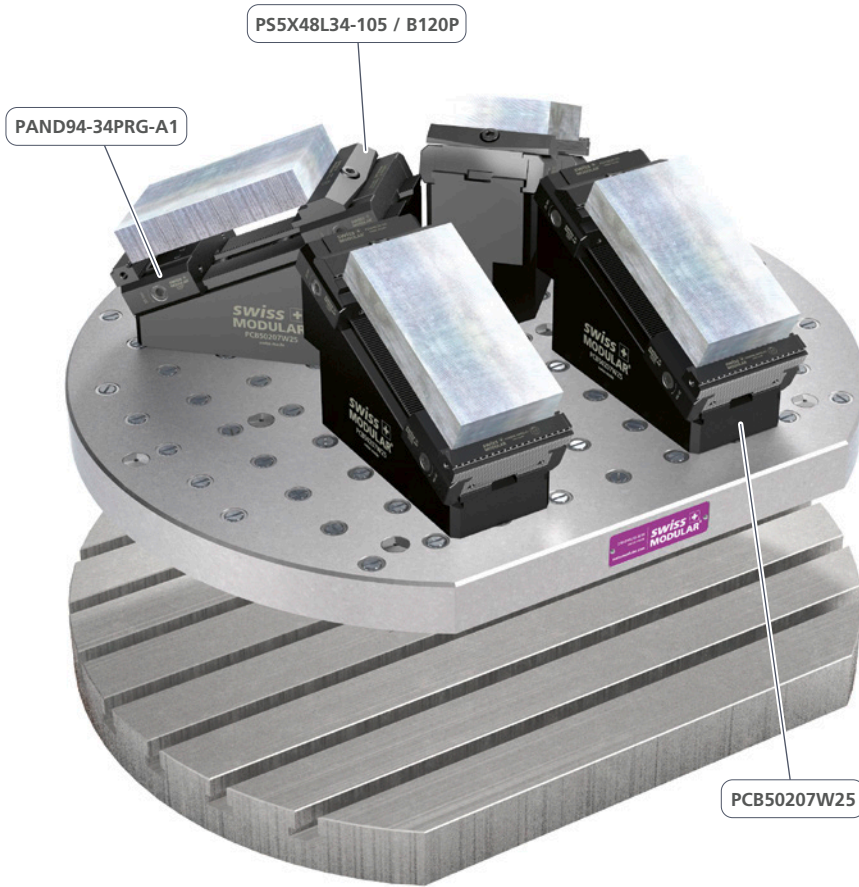

powerCLAMP

Schräge Basisschiene für 5-Achsenmaschinen
Angled base rail for 5-axis machines

swiss MADE IN 
MODULAR[®]

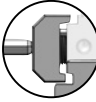

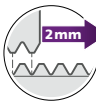
-  **>200** **Verschiedene Module**
Different Modules
-  **powerCLAMP Schnittstelle**
powerCLAMP interface
-  **powerCLAMP Pratzensystem**
powerCLAMP side clamp system
-  **M** **Höchste Modularität**
Highest modularity
-  **Keine spänefüllenden T-Nuten**
No chip catching T-slots
-  **Positionierschritte von 2 mm**
Positioning increments of 2 mm

Bestellschlüssel <i>Order code</i>	Bezeichnung <i>Description</i>	~ Kg	Spannstellen <i>Clamping areas</i>	Spannsystem <i>Clamping system</i>	Spannbereich <i>Clamping area</i>
 DM-DMU50-SET1	Maschinenset 1 / <i>Machine set 1</i>	128	4	powerCLAMP	22 – 154

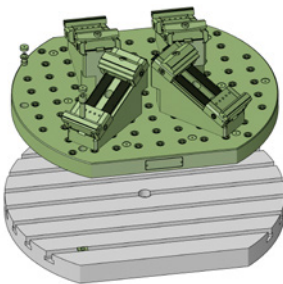

DM-DMU50-SET1



siehe **powerCLAMP**
Gesamtkatalog:
more in the powerCLAMP
main catalogue:



Backen gemäss Zusammenstellzeichnung
falls nicht anders vereinbart.
*Jaws according to assembly drawing
if not agreed otherwise.*



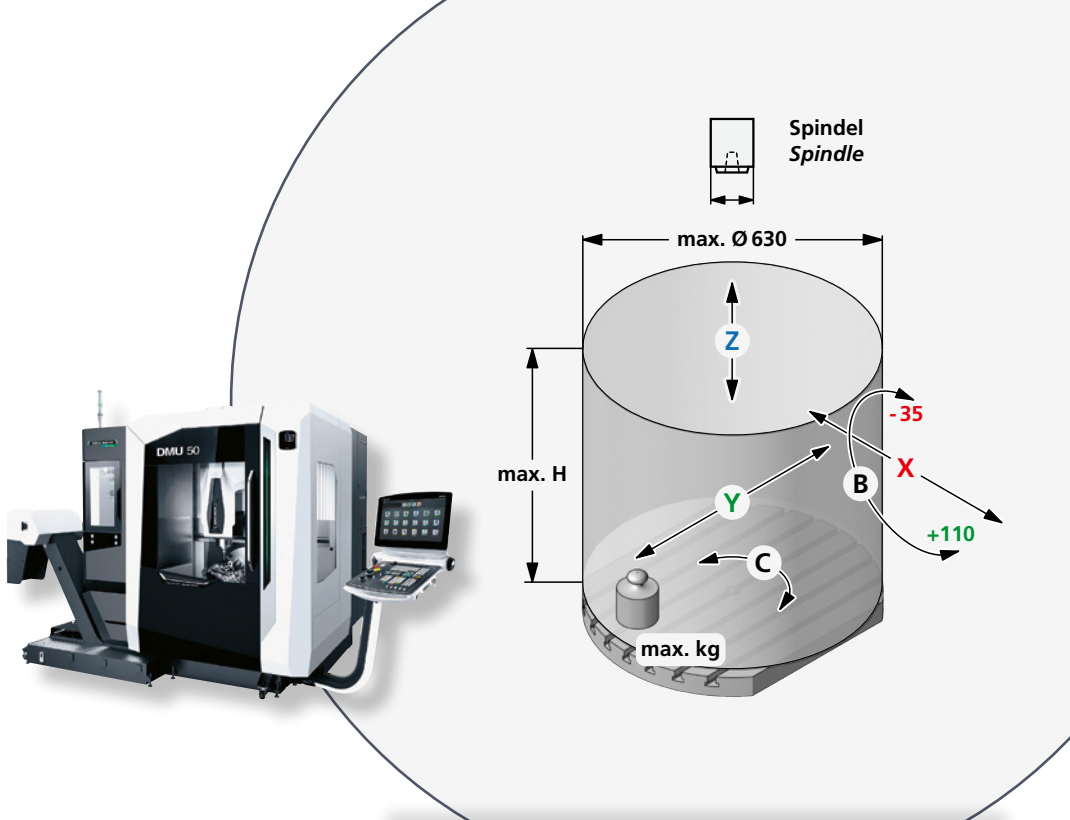

X	Y	Z	B	C	H	max. kg
650	520	475	-35° / +110°	-360°	600	300

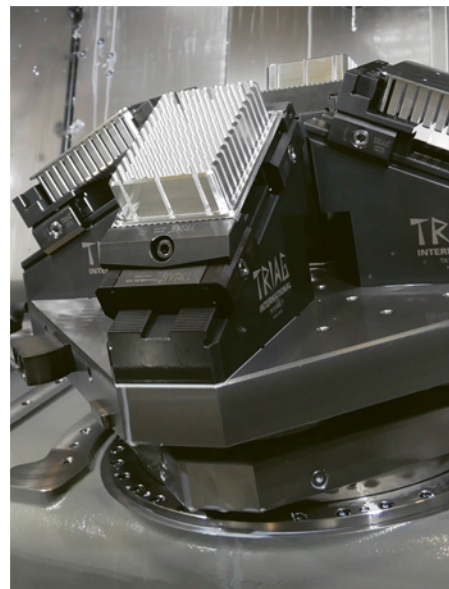
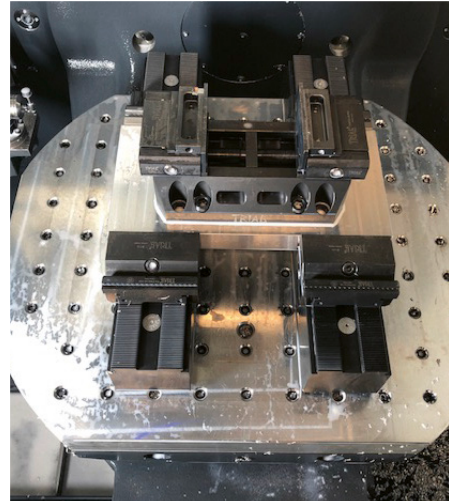
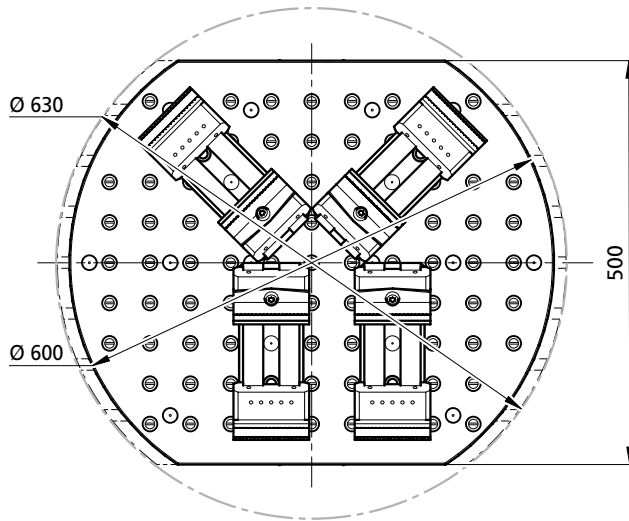
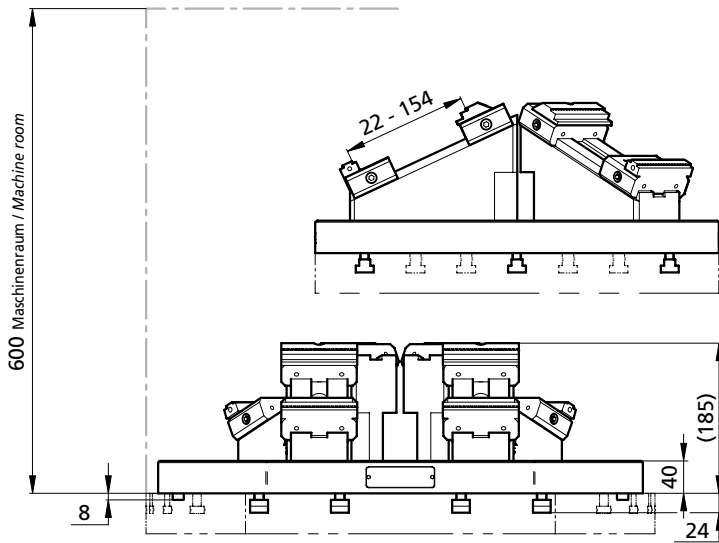



triCENTRO

5 - Achs Pyramidenlösung inkl. Rasterplatte
5 - axis pyramid solutions incl. grid plate

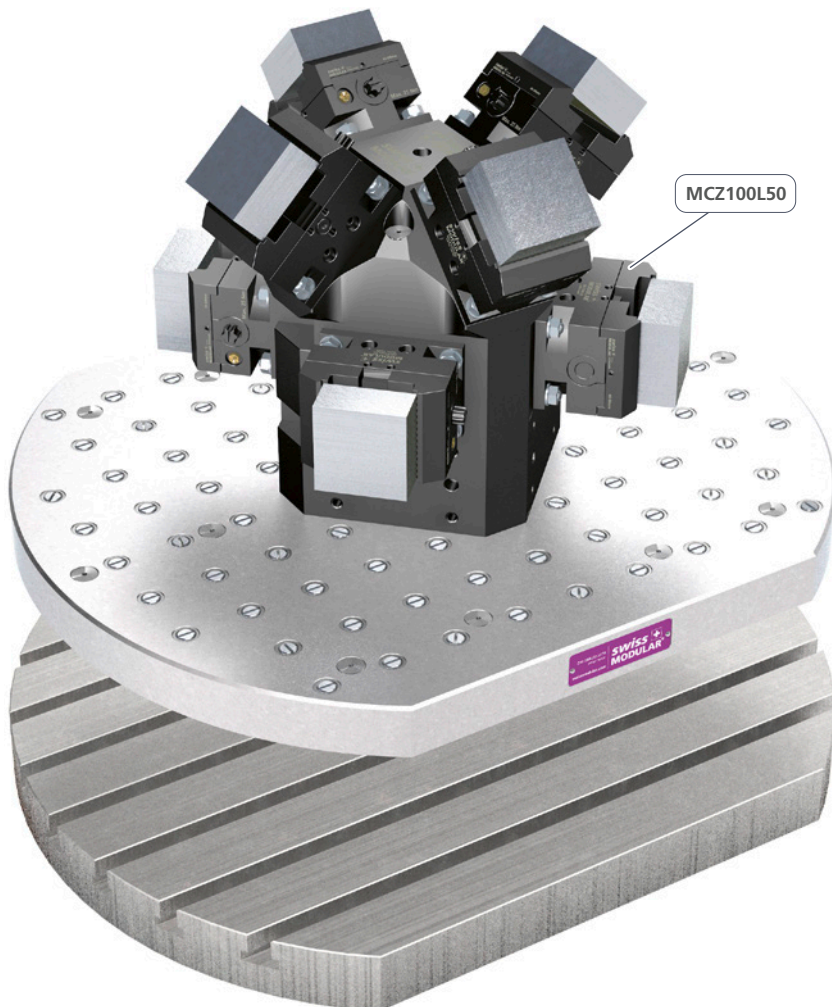

14

Backenvarianten
Jaw variants

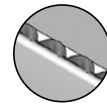

3mm Direkt-Prägebacken
3mm Direct stamping jaws

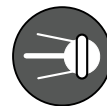

«SpaceGRIP» 5-Achs
Mehrfachspannsystem
«SpaceGRIP» 5-axis multiple
workholding system



Beste Zugänglichkeit
Best accessibility

Bestellschlüssel Order code	Bezeichnung Description	~ Kg	Spannstellen Clamping areas	Spannbereich Clamping area
DM-DMU50-SET2	Maschinenset 2 / Machine set 2	148	8	
DM-DMU50-SET3	Maschinenset 3 / Machine set 3	121	4	

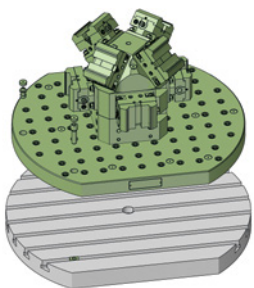

DM-DMU50-SET2

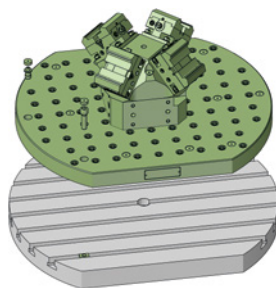

DM-DMU50-SET3

Drehmoment Torque		Spannkraft Workholding force		
Nm	(lb-ft)	~daN	~(lb)	~t
10	7,4	= 200	440	0,2
20	14,8	= 500	1'102	0,5
30	22,2	= 1'000	2'204	1,0
40	29,6	= 1'300	2'866	1,3
50	37,0	= 1'600	3'527	1,6

Backen gemäss Zusammenstellzeichnung
falls nicht anders vereinbart.
Jaws according to assembly drawing
if not agreed otherwise.

MINI

Backen zu Mini Zentrischspanner
Jaws for mini self centering vise

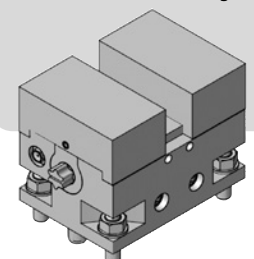

Mehr auf Seite 14
More on page 14



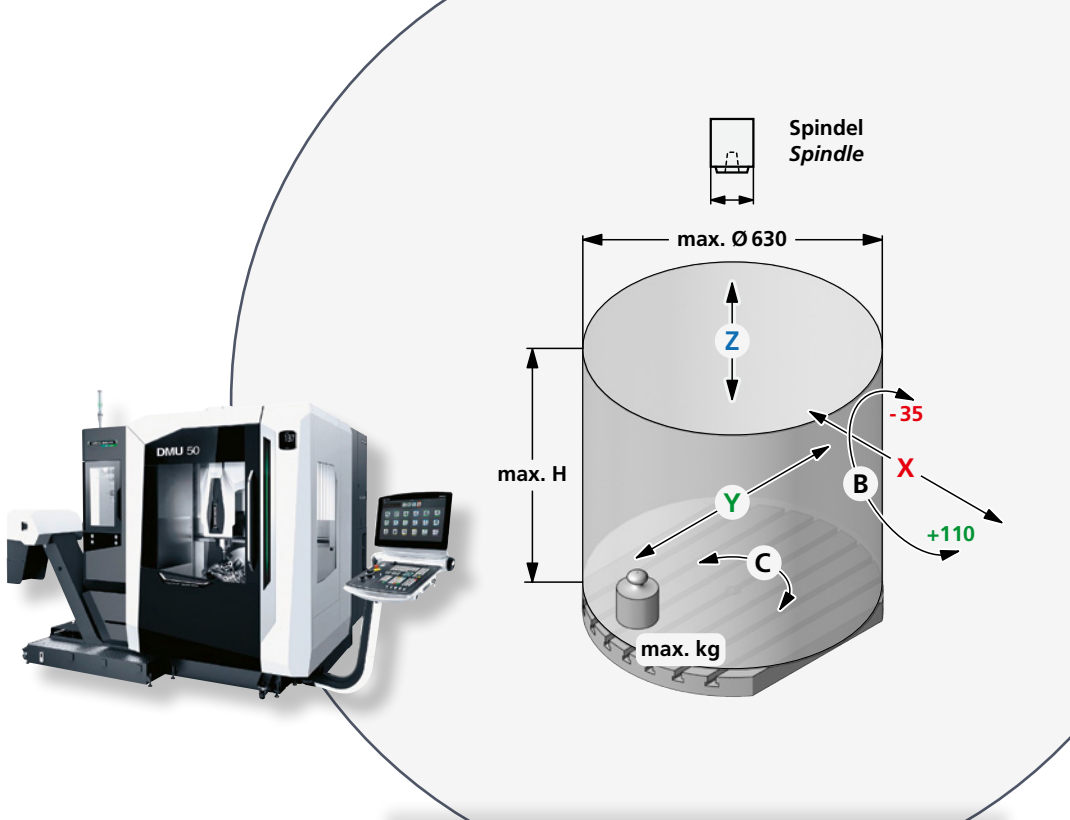

X	Y	Z	B	C	H	max. kg
650	520	475	-35° / +110°	-360°	600	300

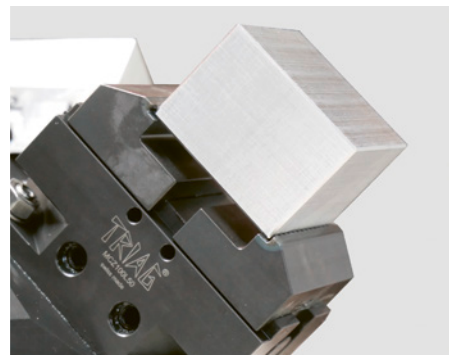
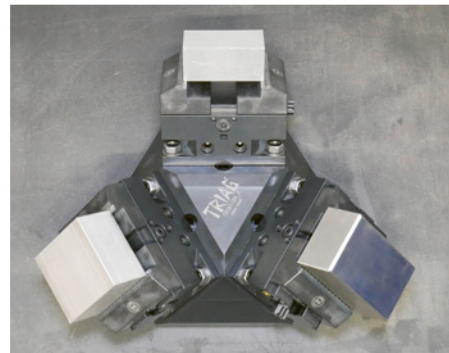
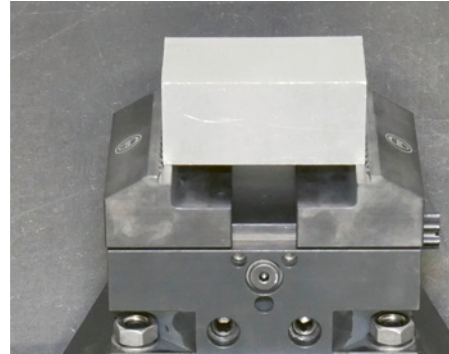
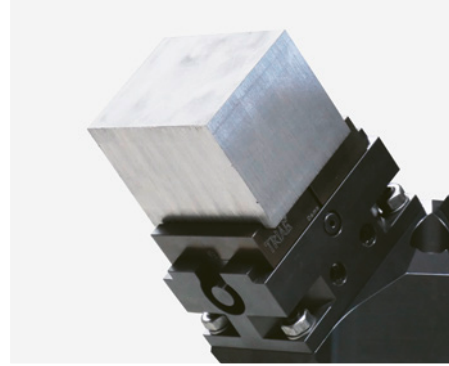
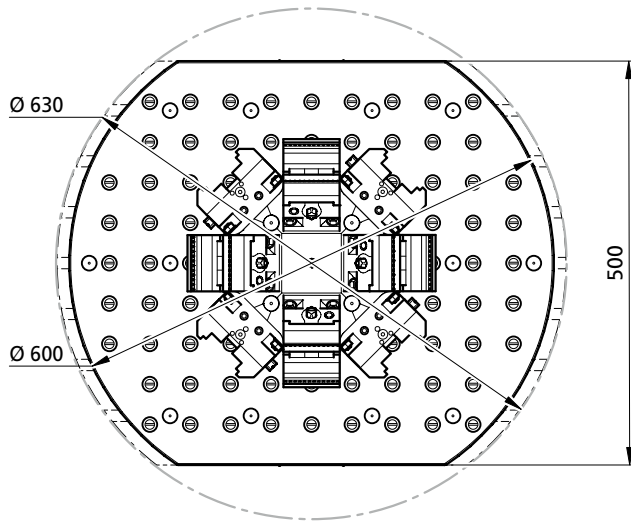
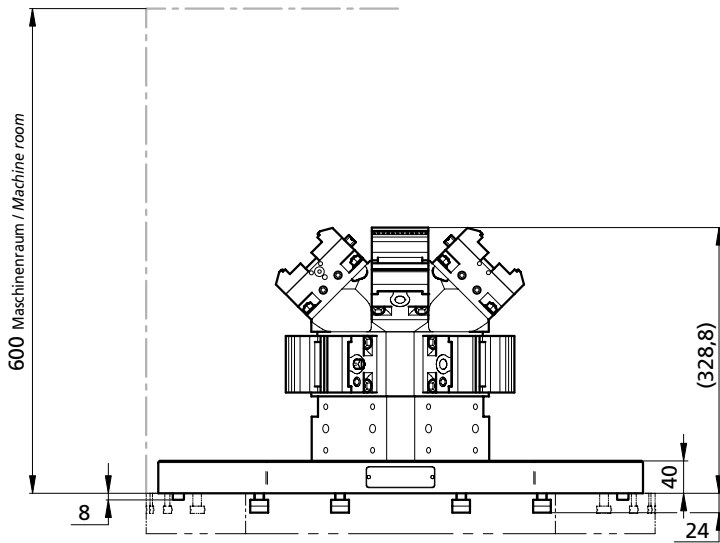



triCENTRO / powerCLAMP / tripoxyMINERAL

Modularer Zentrischspanner «ZSM» inkl. Mineralgusserhöhung
 Modular self centering vise «ZSM» incl. epoxy riser



60 Verschiedene Anschlagmodule
 Different stop modules

3mm Direkt-Prägebacken
 3mm Direct stamping jaws

powerCLAMP Schnittstelle
 powerCLAMP interface

powerCLAMP Pratzensystem
 powerCLAMP side clamp system

M Höchste Modularität
 Highest modularity



Bestellschlüssel Order code	Bezeichnung Description	~ Kg	Spannbereich A Clamping area A	Spannbereich B Clamping area B
DM-DMU50-SET4	Maschinenset 4 / Machine set 4	40	10 – 128	60 – 180

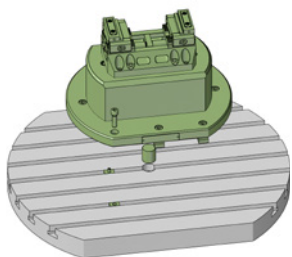

DM-DMU50-SET4

Drehmoment Torque		Spannkraft Workholding force		
Nm	(lb-ft)	~daN	~(lb)	~t
10	7,4	= 200	440	0,2
20	14,8	= 500	1'102	0,5
30	22,2	= 1'000	2'204	1,0
40	29,6	= 1'300	2'866	1,3
50	37,0	= 1'600	3'527	1,6

siehe powerCLAMP
 Gesamtkatalog:
 more in the powerCLAMP
 main catalogue:



Backen gemäss Zusammenstellzeichnung
 falls nicht anders vereinbart.
 Jaws according to assembly drawing
 if not agreed otherwise.

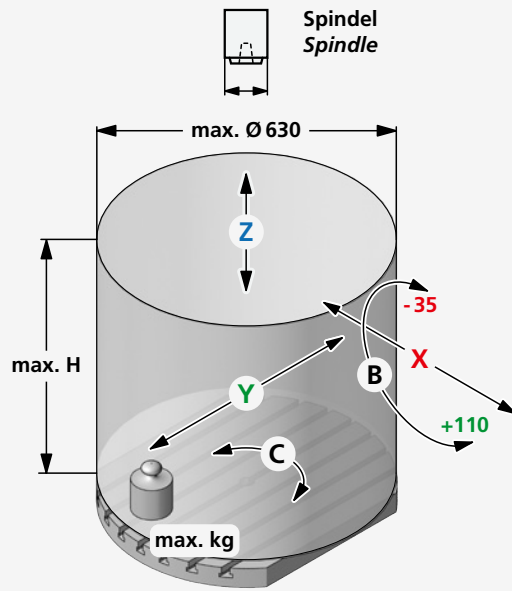

X	Y	Z	B	C	H	max. kg
650	520	475	-35° / +110°	-360°	600	300

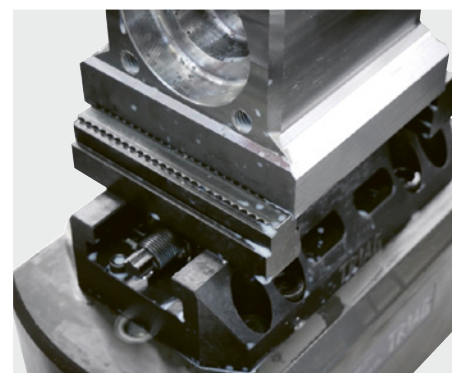
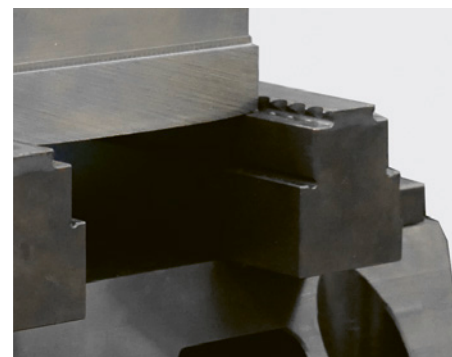
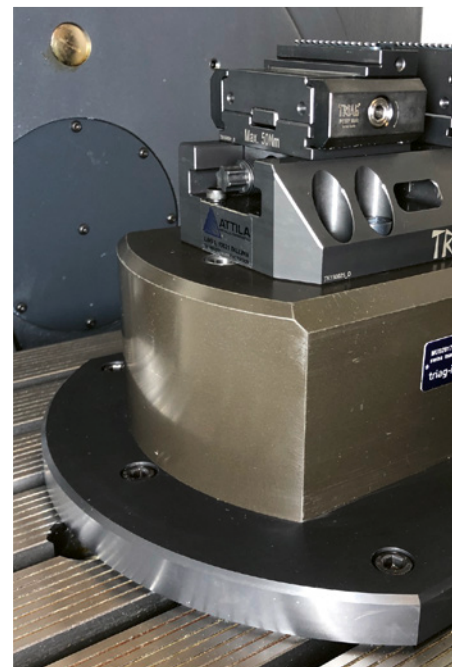
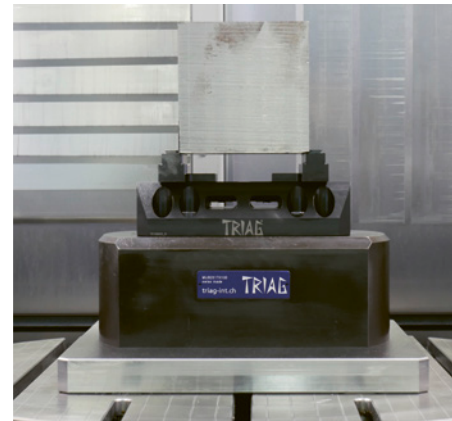
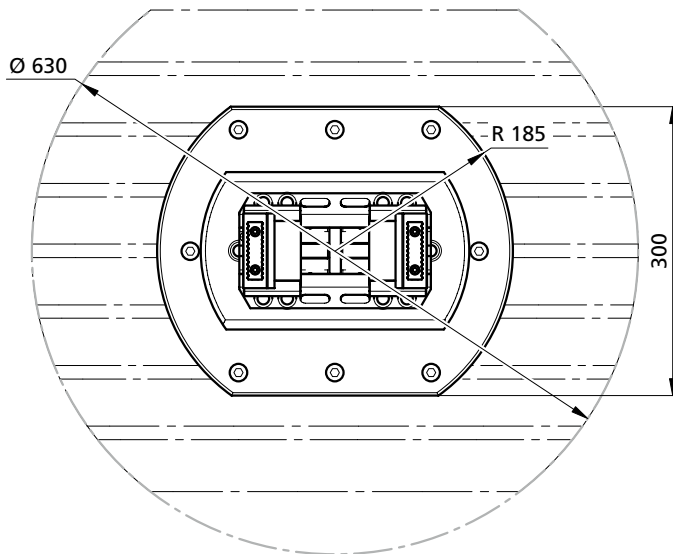
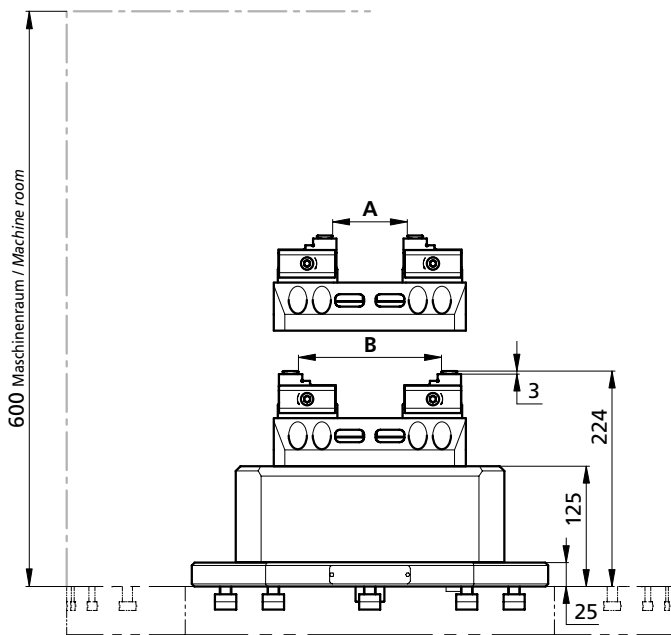





powerCLAMP / tripoxyMINERAL

Modulares Spannsystem
Modular workholding system

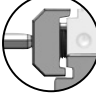

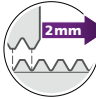
- >200** Verschiedene Module
Different Modules
-  powerCLAMP Schnittstelle
powerCLAMP interface
-  powerCLAMP Pratzensystem
powerCLAMP side clamp system
- M** Höchste Modularität
Highest modularity
-  Keine spänefüllenden T-Nuten
No chip catching T-slots
-  Positionierschritte von 2 mm
Positioning increments of 2 mm

Bestellschlüssel Order code	Bezeichnung Description	~ Kg	Spannstellen Clamping areas	Spannbereiche Clamping areas
 DM-DMU50-SET5	Maschinenset 5 / Machine set 5	186	8	4 x 22 - 150 / 4 x 0 - 240

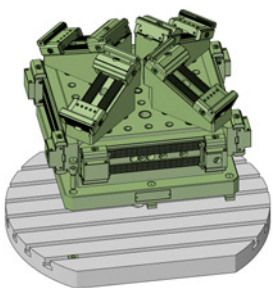

DM-DMU50-SET5



siehe powerCLAMP
Gesamtkatalog:
more in the powerCLAMP
main catalogue:



Backen gemäss Zusammenstellzeichnung
falls nicht anders vereinbart.
Jaws according to assembly drawing
if not agreed otherwise.

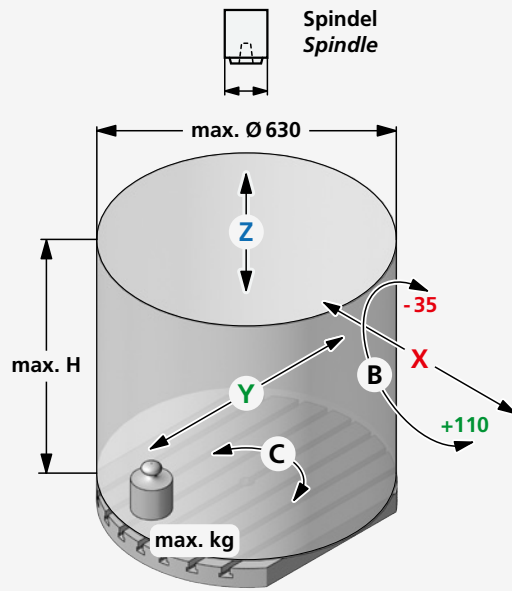

X	Y	Z	B	C	H	max. kg
650	520	475	-35° / +110°	-360°	600	300

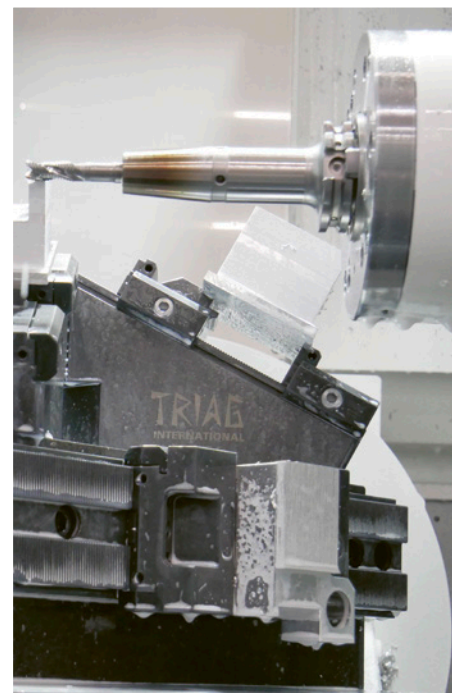
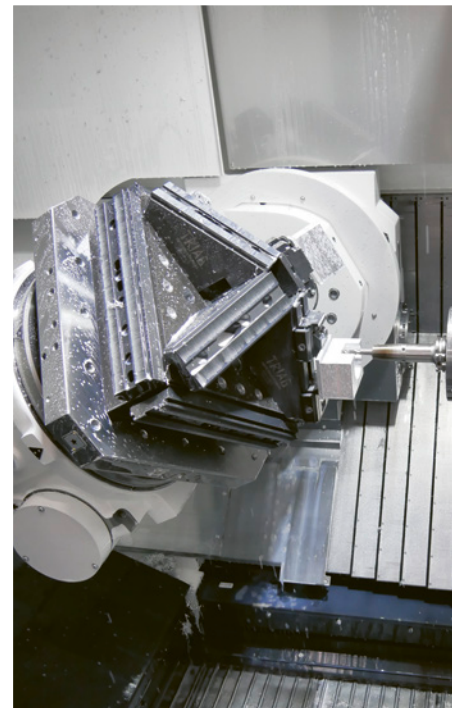
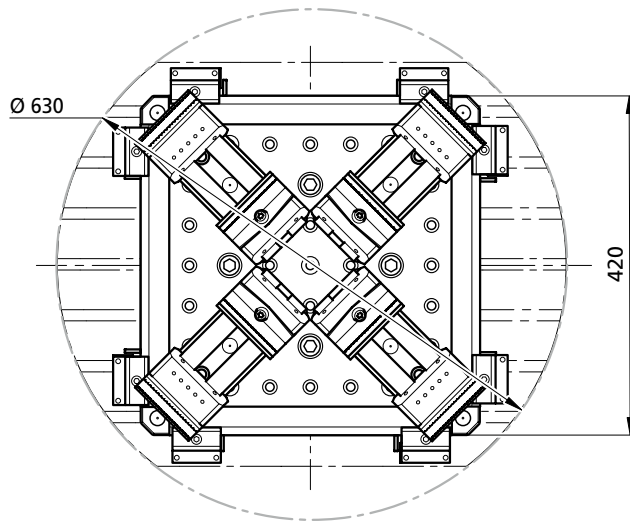
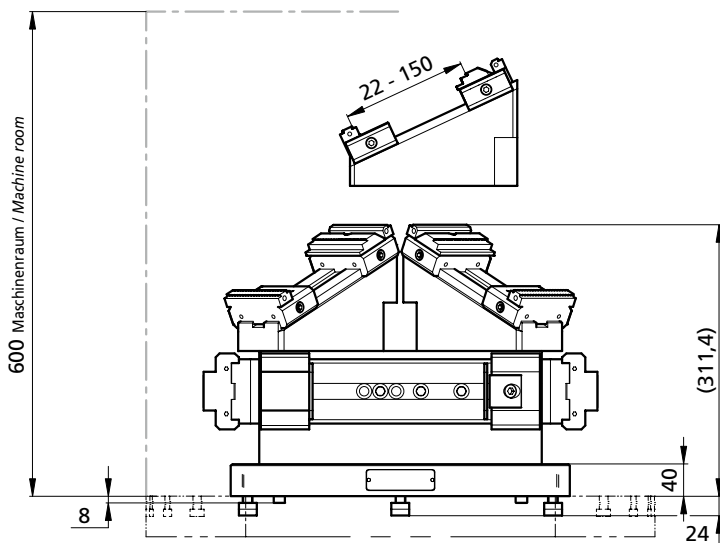



powerCLAMP

Modulares Spannsystem
Modular workholding system

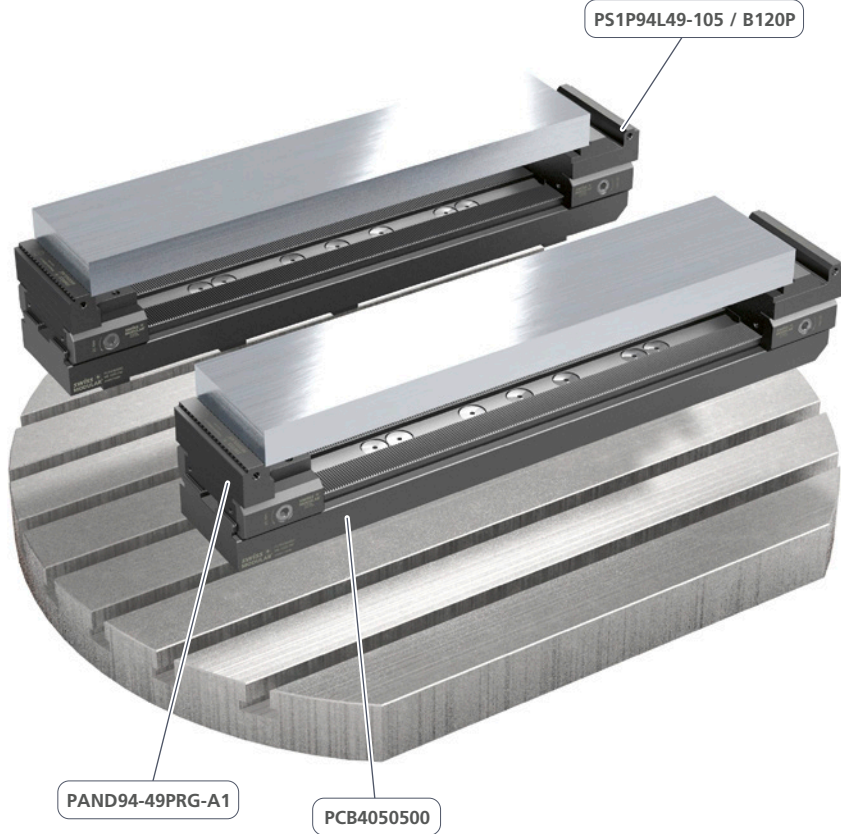

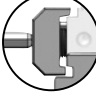
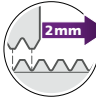
- >200** **Verschiedene Module**
Different Modules
-  **powerCLAMP Schnittstelle**
powerCLAMP interface
-  **powerCLAMP Pratzensystem**
powerCLAMP side clamp system
- M** **Höchste Modularität**
Highest modularity
-  **Keine spänefüllenden T-Nuten**
No chip catching T-slots
-  **Positionierschritte von 2 mm**
Positioning increments of 2 mm

Bestellschlüssel <i>Order code</i>	Bezeichnung <i>Description</i>	~ Kg	Spannstellen <i>Clamping areas</i>	Spannbereich <i>Clamping area</i>
 DM-DMU50-SET6	Maschinenset 6 / <i>Machine set 6</i>	29	2	22 – 434

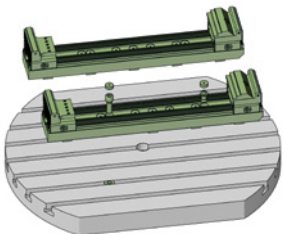

siehe powerCLAMP
Gesamtkatalog:
*more in the powerCLAMP
main catalogue:*



DM-DMU50-SET6



Backen gemäss Zusammenstellzeichnung
falls nicht anders vereinbart.
*Jaws according to assembly drawing
if not agreed otherwise.*

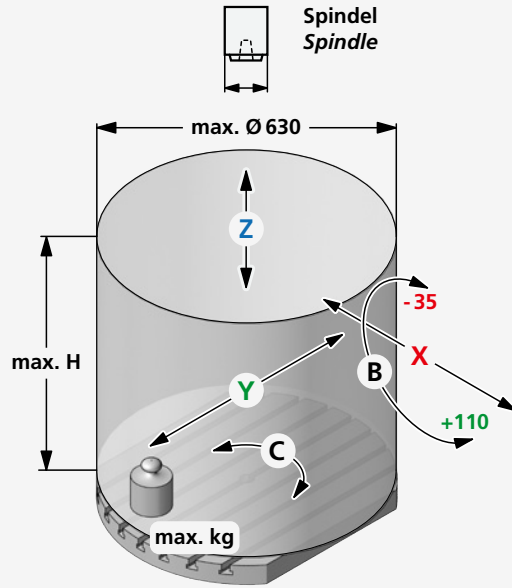

X	Y	Z	B	C	H	max. kg
650	520	475	-35° / +110°	-360°	600	300

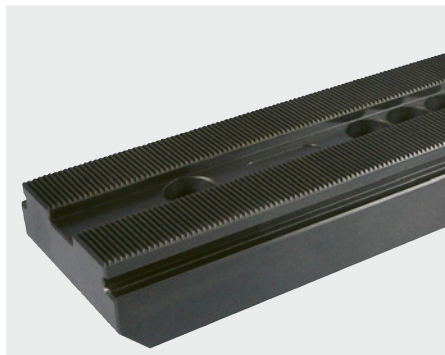
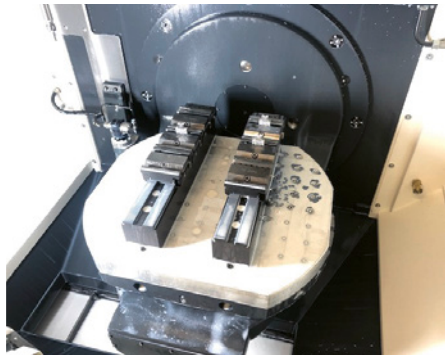
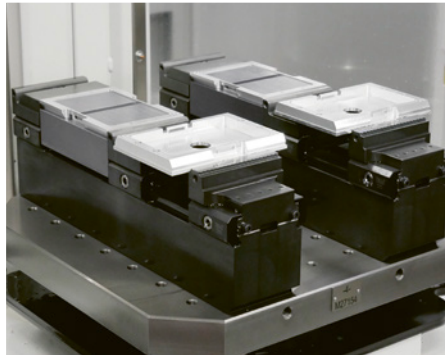
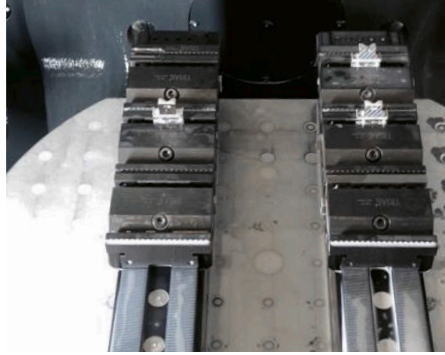
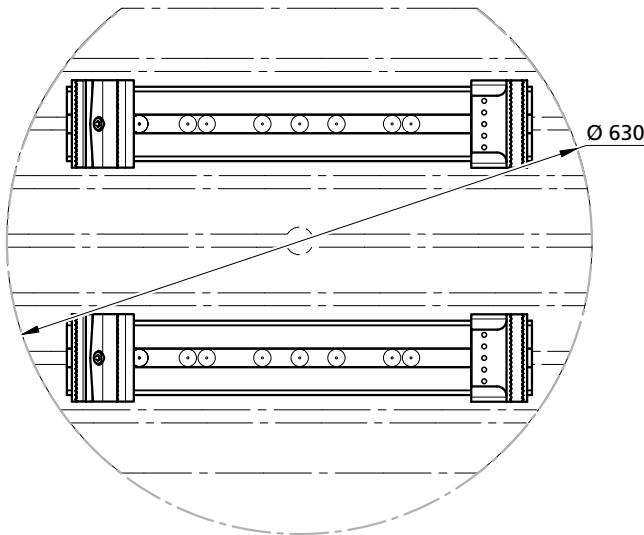
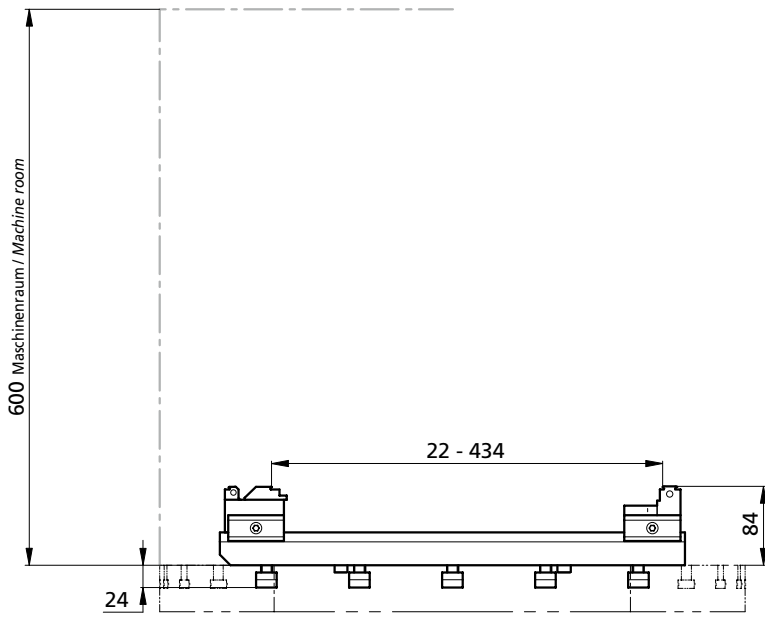



triCENTRO

Modulares Spannsystem
Modular workholding system

swiss 
MODULAR[®]

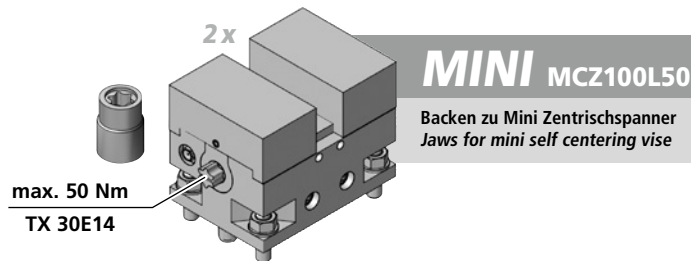

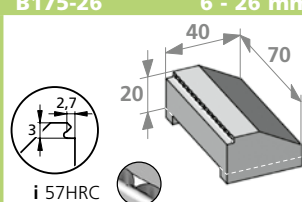
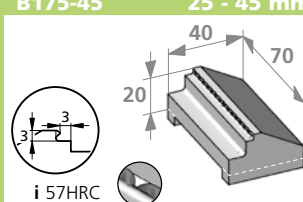
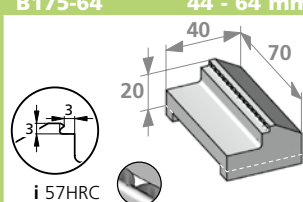
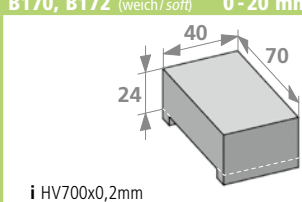
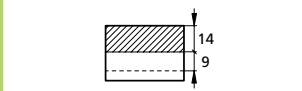
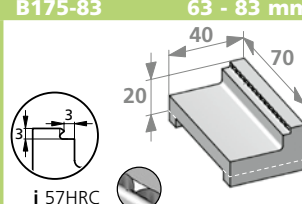
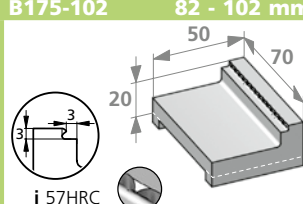
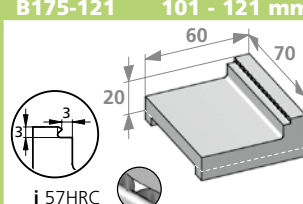
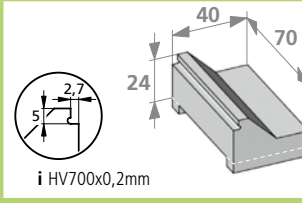
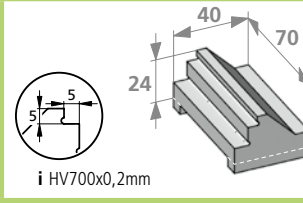
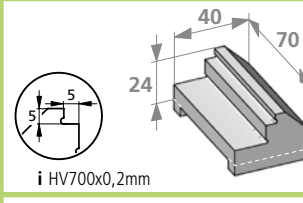
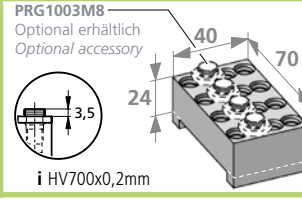
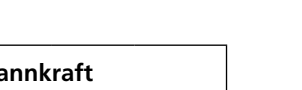
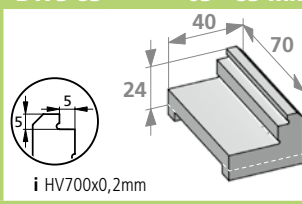
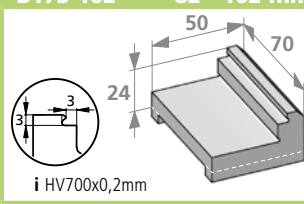
Spannbereich / Clamping range	Spannbereich / Clamping range	Spannbereich / Clamping range	Spannbereich / Clamping range
B175-26 6 - 26 mm	B175-45 25 - 45 mm	B175-64 44 - 64 mm	B170, B172 (weich/soft) 0 - 20 mm
			
i 57HRC	i 57HRC	i 57HRC	i HV700x0,2mm
Spannbereich / Clamping range	Spannbereich / Clamping range	Spannbereich / Clamping range	Zum Erstellen Ihrer individuellen Formbacke: Maximalen Bearbeitungsprofiltiefe If a dedicated jaw is being machined: Max. workpiece machining depth
B175-83 63 - 83 mm	B175-102 82 - 102 mm	B175-121 101 - 121 mm	
			
i 57HRC	i 57HRC	i 57HRC	
Spannbereich / Clamping range	Spannbereich / Clamping range	Spannbereich / Clamping range	Spannbereich / Clamping range
B173-26 6 - 26 mm	B173-45 25 - 45 mm	B173-64 44 - 64 mm	B176-80 8 - 80 mm
			
i HV700x0,2mm	i HV700x0,2mm	i HV700x0,2mm	i HV700x0,2mm
Spannbereich / Clamping range	Spannbereich / Clamping range	PRG1003M8 Optional erhältlich Optional accessory	
B173-83 63 - 83 mm	B173-102 82 - 102 mm		
			
i HV700x0,2mm	i HV700x0,2mm		

Drehmoment Torque		Spannkraft Workholding force		
Nm	(lb-ft)	~daN	~(lb)	~t
10	7,4	= 200	440	0,2
20	14,8	= 500	1'102	0,5
30	22,2	= 1'000	2'204	1,0
40	29,6	= 1'300	2'866	1,3
50	37,0	= 1'600	3'527	1,6

Für mehr Informationen, Zubehör oder Backensets > [Gesamtkatalog/powerCLAMP](#)
For further informations, accessories or jaw sets > [General catalogue/powerCLAMP](#)



powerCLAMP

Komponente
Components

swiss 
MODULAR[®]

Module *Modules*



Über 200 Varianten
Over 200 variants

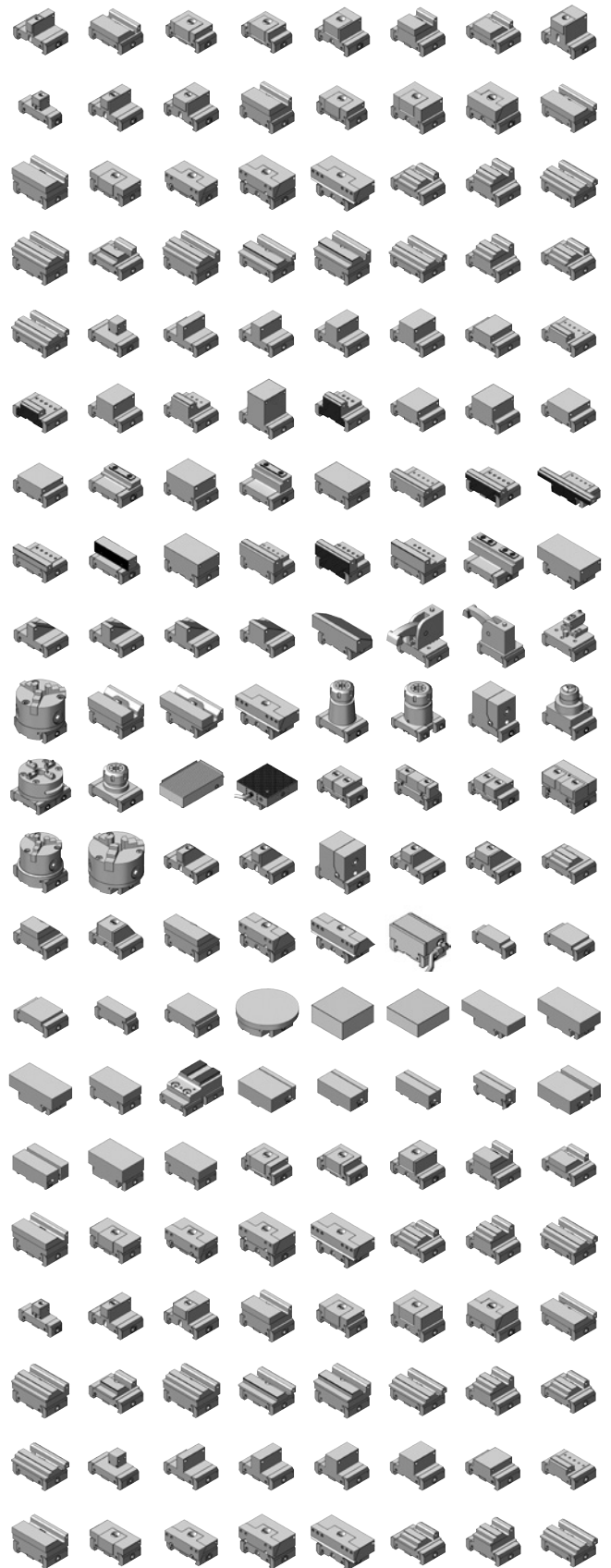
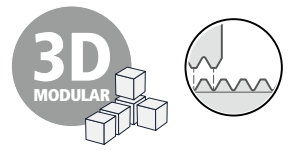

Linearspanmodule
Linear clamping modules

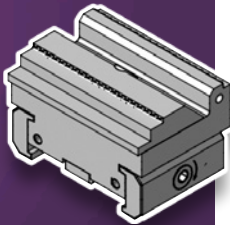

Niederzugspanmodule
Pull down clamping modules

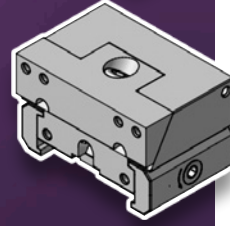

Anschlagmodule
Endmodules

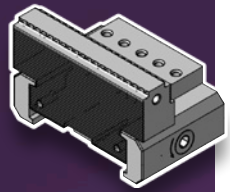

Sonstige Module
Other modules

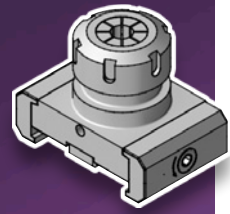

Spannmodul Breiten
Clamping module widths

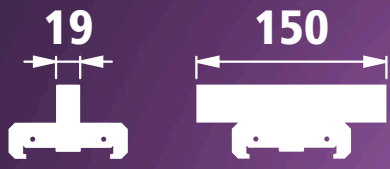

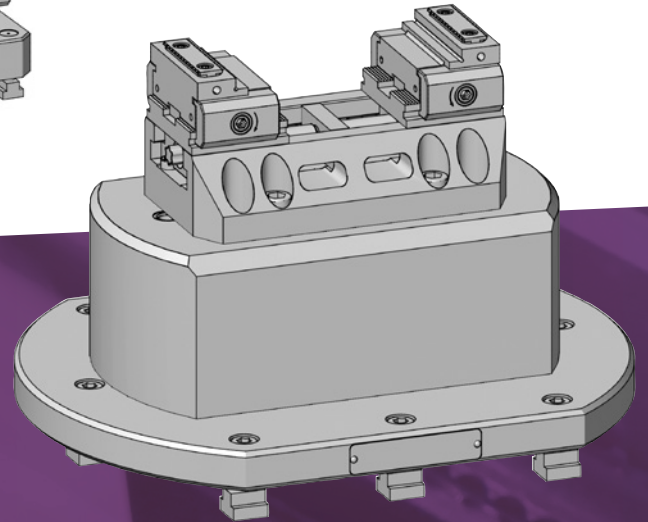
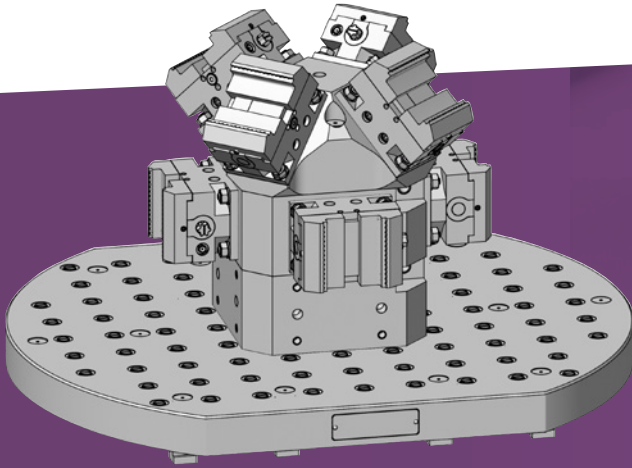
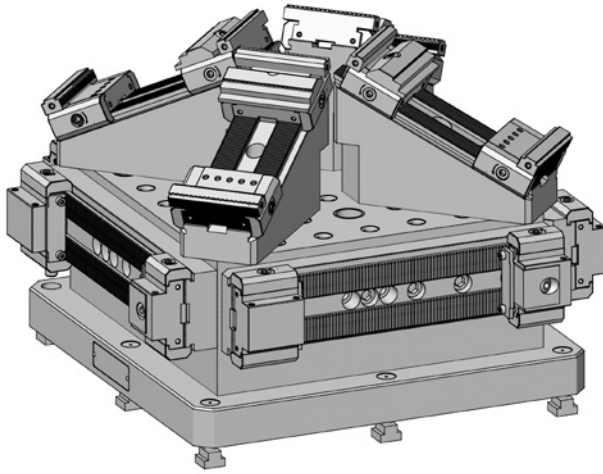

Triag International AG

Bösch 84 CH-6331 Hünenberg

☎ +41 41 727 27 77

✉ spannen@triag-int.ch

✉ clamping@triag-int.ch



Mass- und Konstruktionsänderungen
bleiben uns vorbehalten. *We reserve
the right to modify dimensions and
structural design.*

triag-int.ch

Official Website

swissmodular.com



**04
24**

