



TRIAG

INTERNATIONAL

Spannlösungen für **HURCO**
*Workholding solutions for **HURCO***



Triag International in Zusammenarbeit mit:
Triag International in collaboration with:

HURCO
mind over metal

Ausgabe/edition: 26.06.2018

www.triag-int.ch



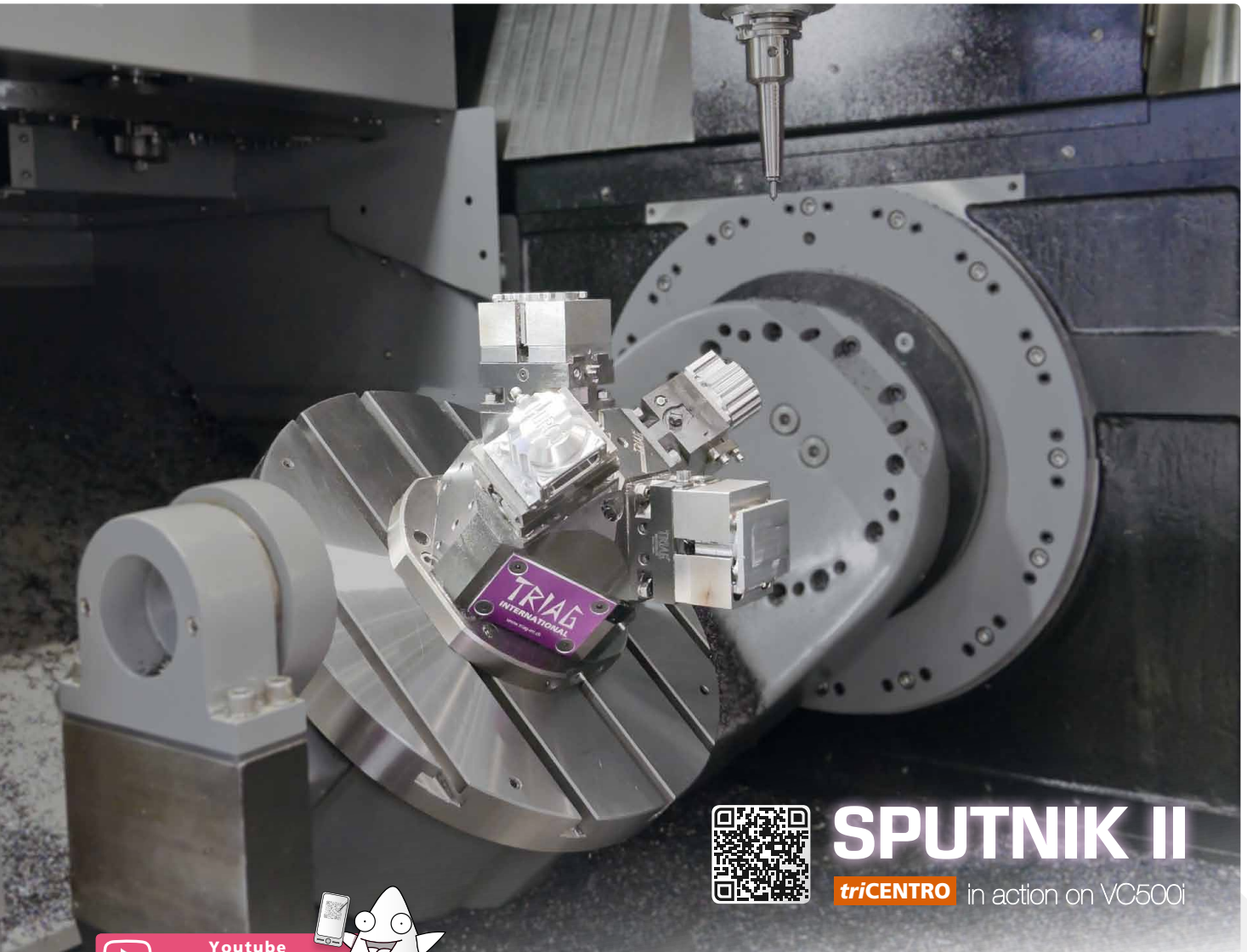

SPUTNIK II

triCENTRO in action on VC500i

 **Youtube**
Triag International



VIDEO ONLINE!

INTERNATIONAL **TRIAG**

Eigenes Engineering, eigene Fertigung, und weltweiter Vertrieb mit sehr hohem Qualitätsstandard.
Engineering, production and worldwide distribution in high quality!
Triag International AG - Bösch 84 / 6330 Hünenberg, Switzerland 

Die HURCO Maschinen-Sets

Die optimale Spannlösung für Ihre CNC-Werkzeugmaschine zu finden, ist nicht immer leicht. Doch was versteht man, unter einer «optimalen Spannlösung?»

- ✓ Hochflexible und modulare Spannprozesse
- ✓ Zuverlässiges sicheres Spannen
- ✓ Eine durchdachte Turnkey-Lösung
- ✓ Eine Investition die sich auszahlen lässt

Die HURCO Maschinen-Sets wurden mit Einhaltung der oben genannten Punkten zusammengestellt.

■ Für die 3-Achs Bearbeitung

Das «powerCLAMP» Starter Set ist ein hochmodulares und individuell gestaltbares, bzw. zusammenstellbares Set für die Einfach- und Mehrfachspannung von kleinen bis grossen Werkstücken. Schritt für Schritt stellen Sie sich Ihre individuelle und vielleicht einzigartige Spannlösung zusammen. Natürlich ist powerCLAMP auch auf 5-Achs und Horizontal Maschinen anwendbar. **Seite 4 - 5**

■ Für die 5-Achs Bearbeitung

«TriCENTRO» steht für kompaktes und zentrisches Spannen. Vom kleinen micro Zentrischspanner bis hin zum grossen ZSM. In Kombination mit den einzigartigen Zentrischspannblöcken der «Sputnik» Baureihe erhöht man die Maschinenlaufzeit um das x-fache. **Seite 6 - 12**

The HURCO machines-sets

Finding the optimal workholding solution for your CNC machine is not always easy. But what do we understand by an «optimal workholding solution?»

- ✓ Ultraflexible and modular clamping processes
- ✓ Reliable and safe clamping
- ✓ A well thought-out turnkey-solution
- ✓ An investment that pays off

The HURCO machines-sets have been composed in compliance with the above mentioned points.

■ For 3-axis machining

*The «powerCLAMP» Starter Set is a highly modular and individually configurable set for single and multiple workholding of small and large workpieces. Step by step you set up your individual and perhaps unique clamping solution. Of course powerCLAMP is also applicable to 5-axis and horizontal machines. **Page 4 - 5***

■ For 5-axis machining

*«TriCENTRO» stands for compact and centric clamping. From the small micro self centering vise to the big ZSM. In combination with the unique self centering vise blocks of the «Sputnik» series, we achieve an increase of the machine running time. **Page 6 - 12***



powerCLAMP

STARTER SET



1 Eine Schraube lösen
Loosen a screw



2 Abheben und neu platzieren
Lift and change position



3 Eine Schraube anziehen (25Nm)
Fasten one screw (25Nm)

- ✓ Schnell verstellbar / Quick adjustable
- ✓ Einfaches handling / Easy handling
- ✓ Geringes Gewicht / Low weight
- ✓ Enorme Modulvielfalt / Enormous module variety
- ✓ Einfache Reinigung / Easy cleaning
- ✓ Optimal für Einzel- & Mehrfachspannung
Optimal for single & multiple workholding
- ✓ Spannt kleine bis grosse Werkstücke
Clamps small and large workpieces



**SPECIAL
OFFER**

i EINFACH SELBER ZUSAMMENSTELLEN!
SCHRITT FÜR SCHRITT
SET IT UP BY YOURSELF!
STEP BY STEP

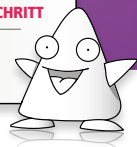

HURCO
mind over metal

• VMX42i	• VMX64i / VMX84i
• VMX24i / VMX30i	• VMX50i / VMX60i*
• VM10i	• VMX50i / VMX60i

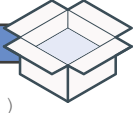
BPC-()B 

Befestigungspaket für PC-SET
Schienenlänge einfügen bei ()
Mounting package for PC-SET
Insert the baserail length in ()

Tisch Überstand*
Over edge of table*

1

BASISSCHIENEN
BASE-RAILS

PCSET18-400B
PCB100-400H60 L=400

PCSET18-500B
PCB100-500H60 L=500

PCSET18-600B
PCB100-600H60 L=600

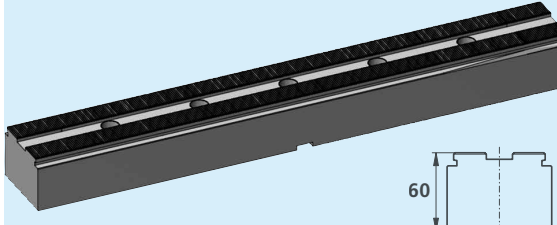

60

PCSET18-650B
PCB100-650H60 L=650

PCSET18-690B
PCB100-690H60 L=690

PCSET18-850B
PCB100-850H60 L=850

2

ANSCHLAGMODULE
END MODULES

01
PAND48-34
H=34 B/W=48

03
PAND48-34PRF-A1
H=34 B/W=48

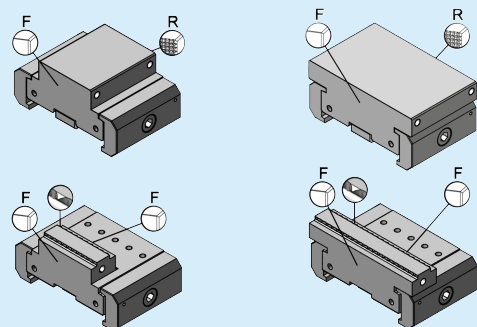

07
PAND94-34
H=34 B/W=94

09
PAND94-34PRF-A1
H=34 B/W=94

3

NIEDERZUGSPANNMODULE
PULL DOWN CLAMP MODULES

PCSET18-N1
PS1R48N34B80N
H=34 W/B=48

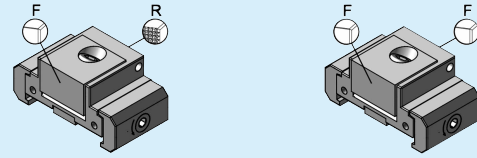

PCSET18-N3
PS1F48N34B80N
H=34 W/B=48

i Für mehr Informationen (Genauere Bemessung, Material, Spannkraft, Drehmoment) + Mehr Module und Zubehör > **Gesamtkatalog**
For further informations (exact dimensions, material, clamping forces, torque) + More modules and accessories > **General catalogue**



3

LINEARSPANNMODULE
 LINEAR CLAMP MODULES

PCSET18-L1

PS1PF48L34B115P
 H=34 W/B=48

PCSET18-L16

PS1R48L34B106
 H=34 W/B=48

PCSET18-L17

PS1F48L34B105
 H=34 W/B=48

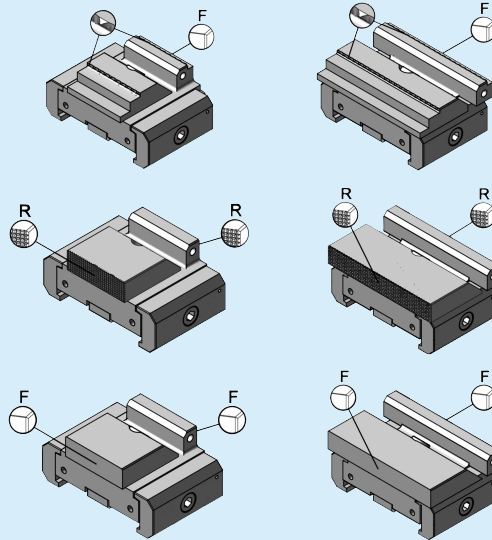

PCSET18-L9

PS1PF94L34B120P
 H=34 W/B=94

PCSET18-L12

PS1R94L34B111
 H=34 W/B=94

PCSET18-L13

PS1F94L34B110
 H=34 W/B=94

4

PARALLELUNTERLAGEN
 STEEL PARALLELS

B48-()

H*	B/W	H*	B/W
PCU (20)	047	PCU (34)	047
PCU (24)	047	PCU (39)	047
PCU (29)	047	PCU (44)	047
PCU (31)	047	PCU (46)	047

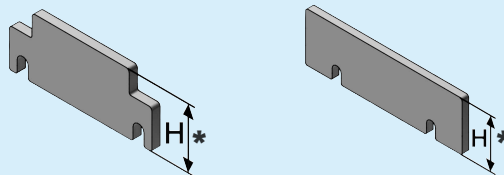

H*	B/W	H*	B/W
PCU (14)	093	PCU (34)	093
PCU (20)	093	PCU (39)	093
PCU (24)	093	PCU (44)	093
PCU (29)	093	PCU (46)	093
PCU (31)	093	PCU (47)	093

✓ 2x Unterlagen inkl. / Spannmodul
 2x parallels incl. / clamping module

BESTELLBEISPIEL
 ORDERING EXAMPLE



1x PCSET18-650B-01 3x PCSET18-N1 B48-29

1 — TEIL I / PART I — 2 3 — TEIL II / PART II — 4

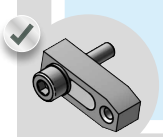

1x FA1240 INCL. / 3

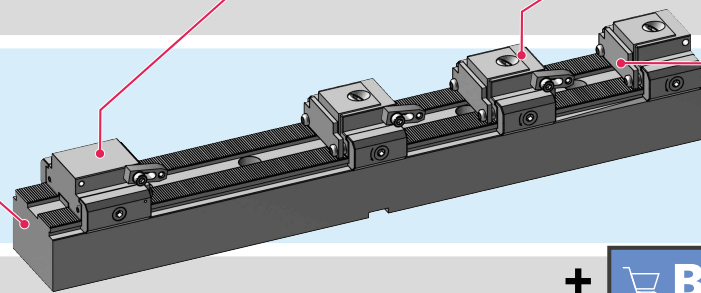

+ BPC-650B

Bestellschlüssel für powerCLAMP Starter Set, setzt sich aus zwei Teilen zusammen:

- TEIL I: Basisschiene + Anschlagmodul
- TEIL II: Spannmodule + Parallelunterlagen

Order code for a powerCLAMP Starter Set is composed by two parts:

- PART I: Base rail + End module
- PART II: Clamp modules + Steel parallels

Befestigungsset zum Starter Set
 Mounting package for Starter Set

Beinhaltet alle benötigten Befestigungsmittel
 Includes all necessary mounting elements



COMPACT

Kompakte Bauweise
Compact design

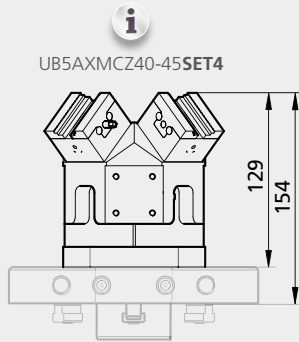

UB5AXMCZ40-45SET4

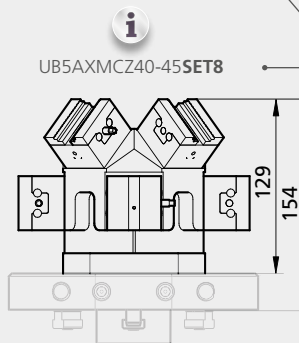

UB5AXMCZ40-45SET8

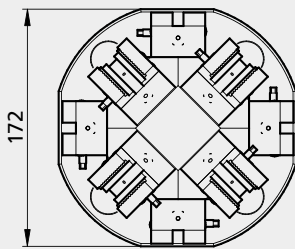

+ 0-PUNKT SYSTEM
0-POINT **oppSYSTEM**

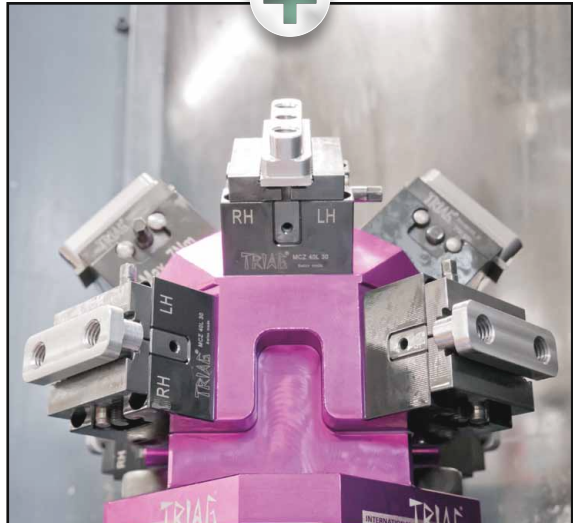

UB5AXMCZ40-45SET4
UB5AXMCZ40-45SET8

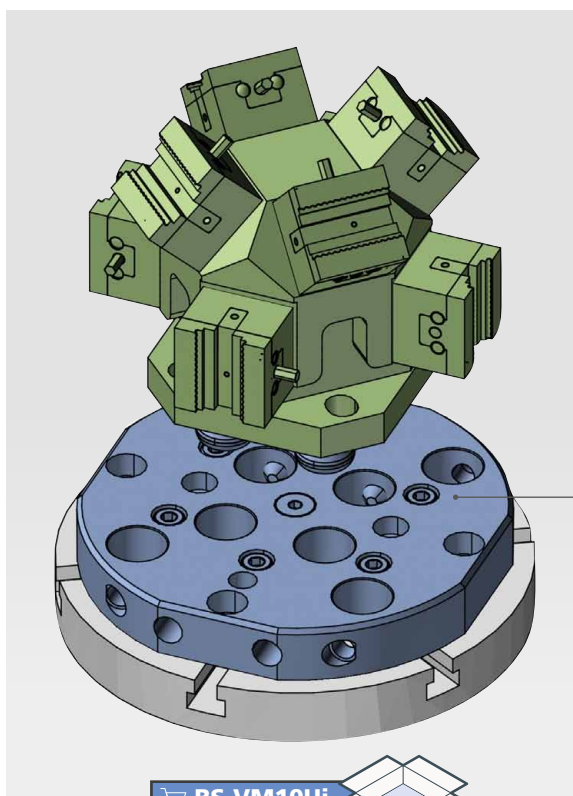

BS-VM10Ui
Befestigungspaket für VM10Ui
Mounting package for VM10Ui

MODULAR

Backen **micro** Zentrischspanner s.14
Jaws **micro** self centering vise p.14



SET4 Inkl. 8 Spannbacken Ihrer Wahl
SET8 Inkl. 16 Spannbacken Ihrer Wahl
SET4 Incl. 8 clamping jaws of your choice
SET8 Incl. 16 clamping jaws of your choice

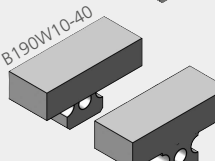
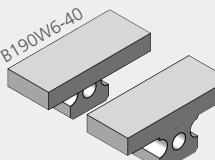
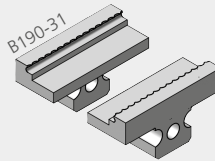
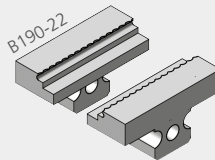
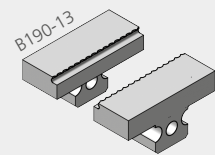

Beinhaltet: Flansch, Nullpunktbolzen,
Schrauben, Nutensteine
Includes: Flange, zero-point pull studs,
screws, t-nuts



Eigenschaften : Modulare Mehrfachspannung, 5 Seitenbearbeitung
Spannstellen: Bis zu 8 Micro Zentrischspanner
Spannbereich: 0-31 mm
Spannkraft: Max. 800 daN
Backenarten: Direkt Prägebacken, Formbacken (s.14)



Characteristics
Clamping areas
Clamping range
Clamping force
Jaw types

Modular multiple clamping, 5-side machining
Up to 8 Micro self centering vises
0-31 mm
Max. 800 daN
Direct Stamping jaws, dedicated jaws (p.14)



COMPACT

Kompakte Bauweise
Compact design



Spannbereich A / D auf Seite 11
Clamping range A / D on page 11

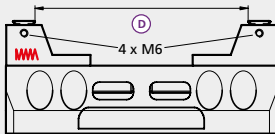
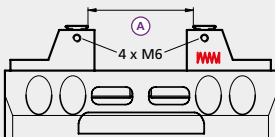
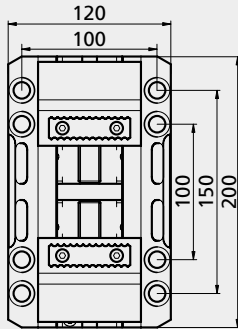
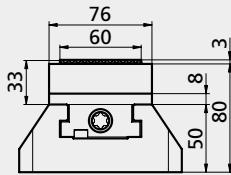

+ KRAFTERHALTUNG
+ SPRING LOADED MECHANISM

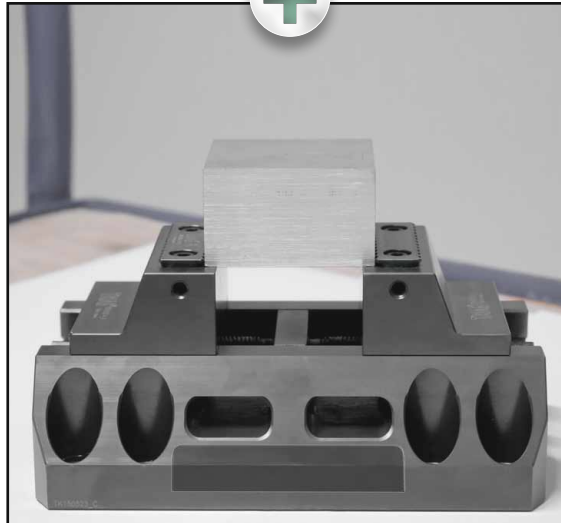

ZSX200L50-VM10Ui



Inkl. Sonderpratzen für VM10Ui
Incl. special clamps for VM10Ui



3mm Direktprägebacken
3mm Direct stamping jaws

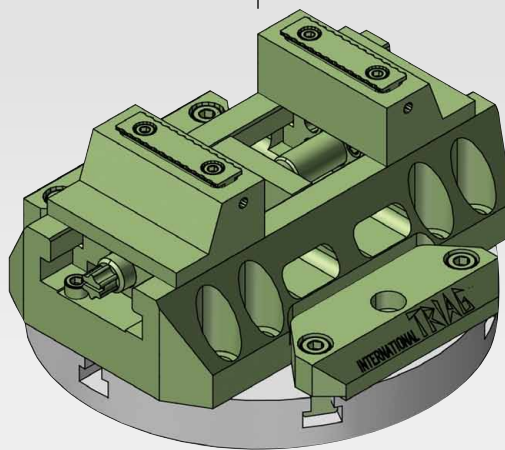

MODULAR

Extra breite Backen 120mm
Extra wide jaws 120mm



Optional erhältlich
Optionally available

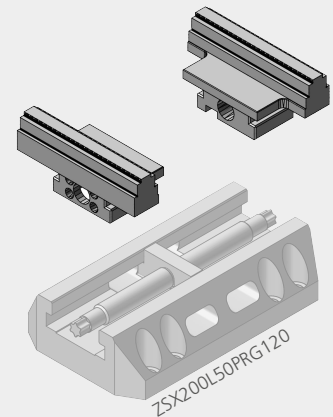

Eigenschaften : Einzigartiges integriertes Federpaket, Top Zugänglichkeit
Spannstellen: 1x (Wendbare Backen)
Spannbereich: 0-178 mm
Spannkraft: Max. 2100 daN
Backenarten: Direkt Prägebacken, Spannbereich Seite 11



Characteristics

Clamping areas
Clamping range
Clamping force
Jaw types

Unique integrated spring package, best accessibility
1x (Reversible jaws)
0-178 mm
Max. 2100 daN
Direct Stamping jaws, clamping range page 11



COMPACT

Kompakte Bauweise
Compact design



Spannbereich A / D auf Seite 11
Clamping range A / D on page 11

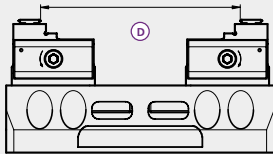
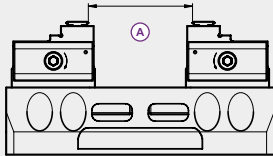
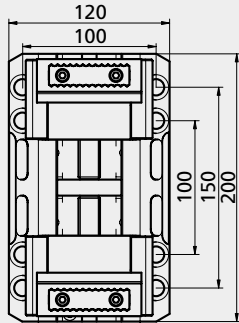
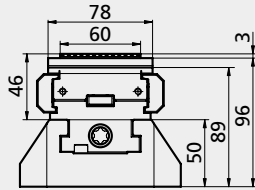

HÖCHSTE MODULARITÄT
HIGH MODULARITY



ZSM200L50-VM10Ui



Inkl. Pratzen, Befestigungsmaterial und 2x PAND78-34UPRG
Incl. claws, mounting material and 2x PAND78-34UPRG

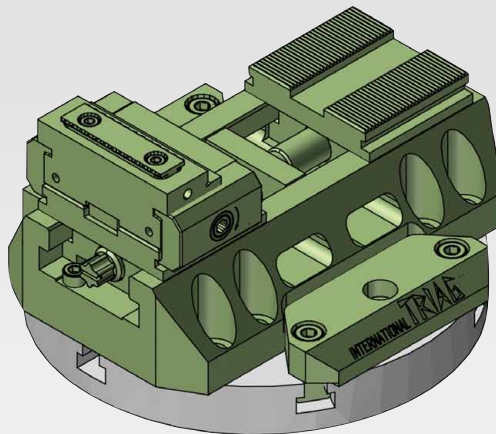
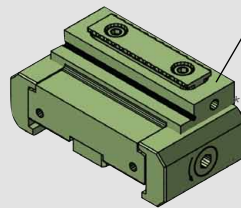

MODULAR

powerCLAMP Module



Alle Module siehe Gesamtkatalog
All modules in general catalogue

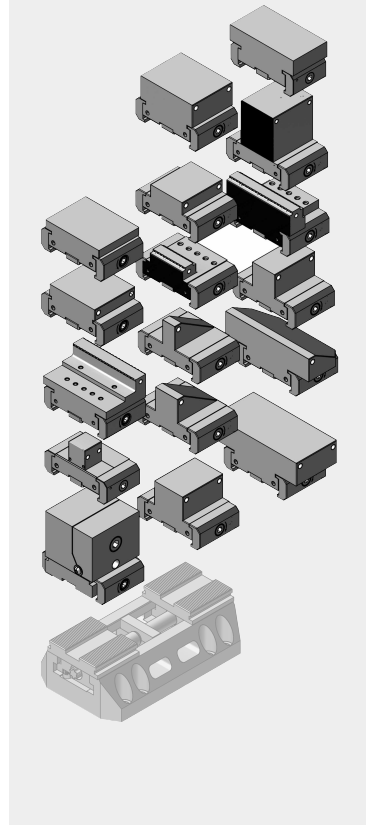

Eigenschaften : Höchste Modularität, alle powerCLAMP Module können eingesetzt werden. Sehr schneller Backen wechsel, Beste Zugangs-Möglichkeit
Spannstellen: 1x (Verschiedene Module von 19-150mm)
Spannkraft: Max. 2100 daN
Backenarten: Direkt Prägebacken, Spannbereich Seite 11



Characteristics

Clamping areas
Clamping force
Jaw types

Highest modularity, each powerCLAMP module can be used, quick jaw change, best accessibility
1x (Different modules from 19-150mm)
Max. 2100 daN
Direct stamping jaws
Clamping range page 11



COMPACT

Kompakte Bauweise
Compact design

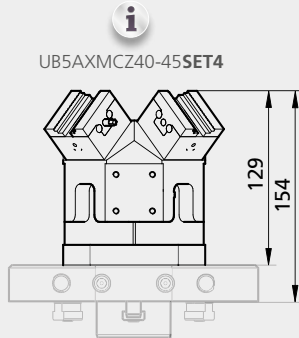

UB5AXMCZ40-45SET4

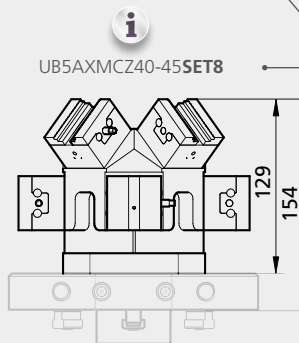

UB5AXMCZ40-45SET8

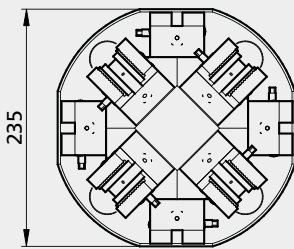

+ 0-PUNKT SYSTEM
oppSYSTEM

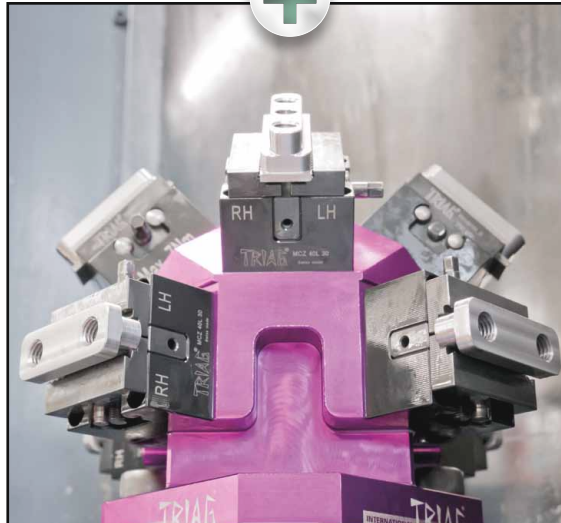

UB5AXMCZ40-45SET4

UB5AXMCZ40-45SET8

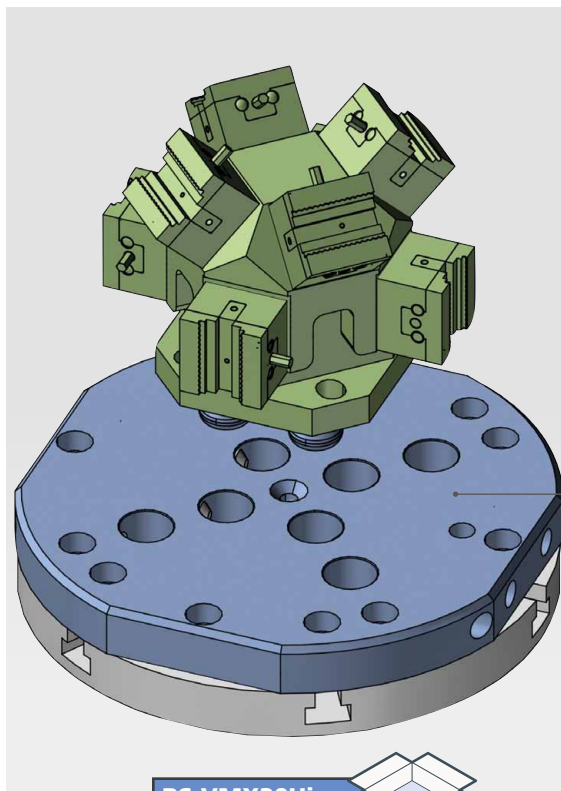

BS-VMX30Ui

Befestigungspaket für VMX30Ui
Mounting package for VMX30Ui

MODULAR

Backen **micro** Zentrischspanner s.14
Jaws **micro** self centering vise p.14



SET4 Inkl. 8 Spannbacken Ihrer Wahl
SET8 Inkl.16 Spannbacken Ihrer Wahl
SET4 Incl. 8 clamping jaws of your choice
SET8 Incl. 16 clamping jaws of your choice

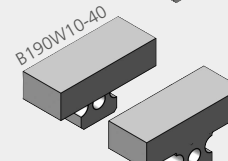
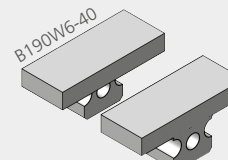
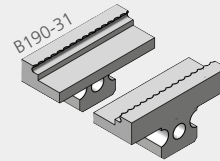
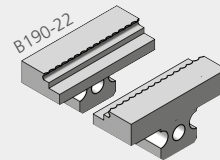
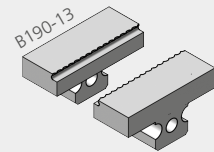

Beinhaltet: Flansch, Nullpunktbolzen,
Schrauben, Nutensteine
Includes: Flange, zero-point pull studs,
screws, t-nuts



Eigenschaften : Modulare Mehrfachspannung, 5 Seitenbearbeitung
Spannstellen: Bis zu 8 Micro Zentrischspanner
Spannbereich: 0-31 mm
Spannkraft: Max. 800 daN
Backenarten: Direkt Prägebacken, Formbacken (s.14)



Characteristics
Clamping areas
Clamping range
Clamping force
Jaw types

Modular multiple clamping, 5-side machining
Up to 8 Micro self centering vises
0-31 mm
Max. 800 daN
Direct Stamping jaws, dedicated jaws (p.14)



COMPACT

Kompakte Bauweise
Compact design



Weitere Infos im Gesamtkatalog
More informations on general catalogue

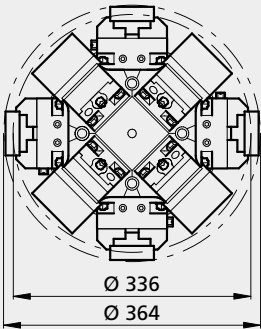
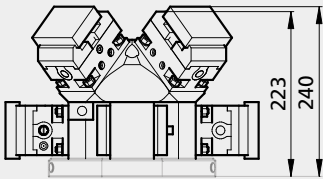
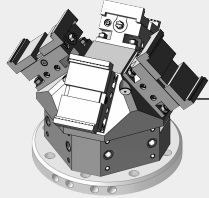
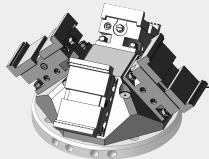

+ 0-PUNKT SYSTEM
0-POINT **oppSYSTEM**



- 5AXMCZ100-45-4S18 1 *
- 5AXMCZ100-45-4HS18 2 *
- 5AXMCZ100-45-8S18 3 *

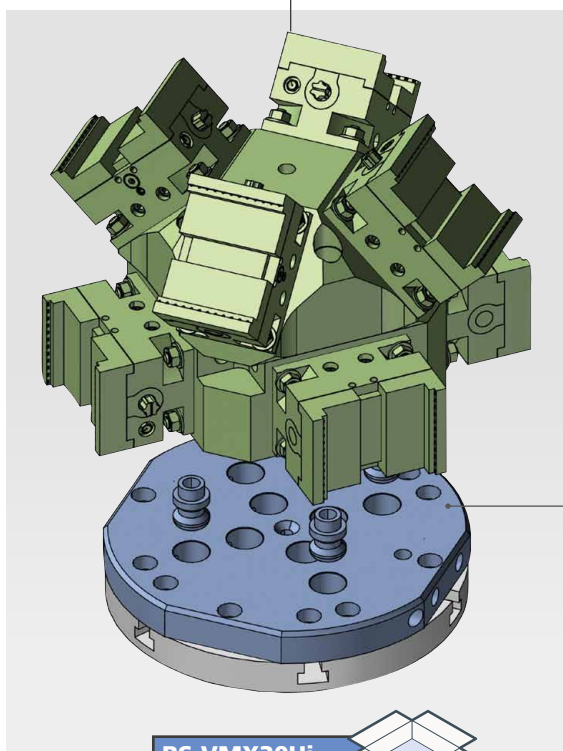

BS-VMX30Ui

Befestigungspaket für VMX30Ui
Mounting package for VMX30Ui

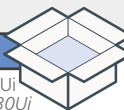

MODULAR

Backen **Mini** Zentrischspanner s.13
Jaws **mini** self centering vise p.13



- * 1/2) Inkl. 8 Spannbacken Ihrer Wahl
- * 3) Inkl. 16 Spannbacken Ihrer Wahl
- * 1/2) Incl. 8 clamping jaws of your choice
- * 3) Incl. 16 clamping jaws of your choice

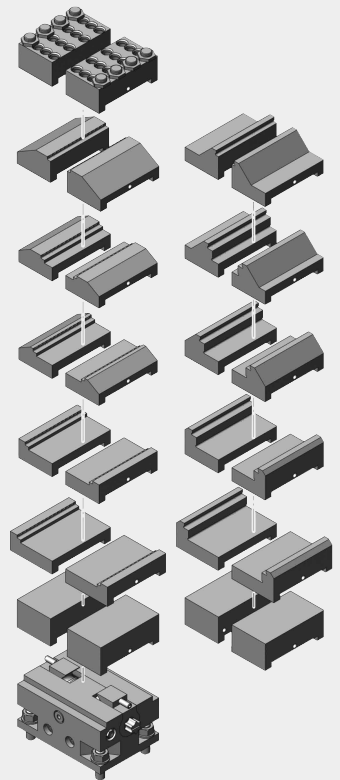

Beinhaltet: Flansch, Nullpunkbolzen,
Schrauben, Nutensteine
Includes: Flange, zero-point pull studs,
screws, t-nuts



Eigenschaften : Modulare Mehrfachspannung, 5 Seiten Bearbeitung
Spannstellen: 4-8 Mini Zentrischspanner
Spannbereich: 0-121 mm
Spannkraft: Max. 1600 daN
Backenarten: Direkt Prägebacken, Formbacken
Mehr Infos auf Seite 13



Characteristics
Clamping areas
Clamping range
Clamping force
Jaw types

Modular multiple workholding, 5 side machining
4-8 Mini self centering vises
0-121 mm
Max. 1600 daN
Direct Stamping jaws, dedicated jaws
More info on page 13

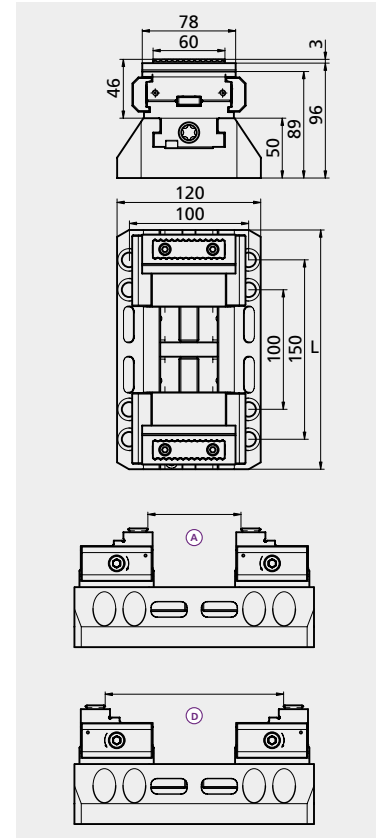
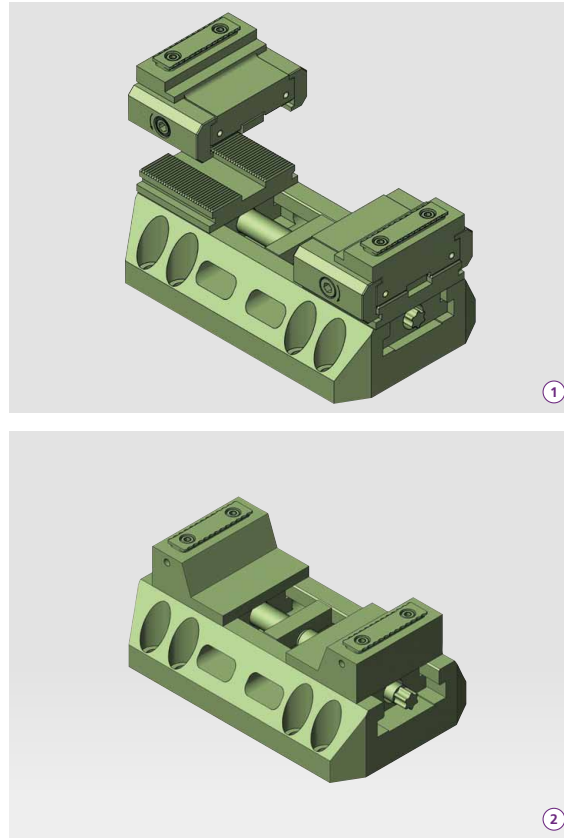
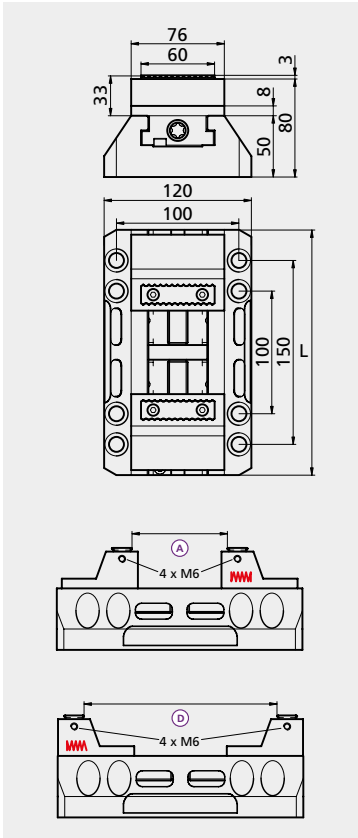
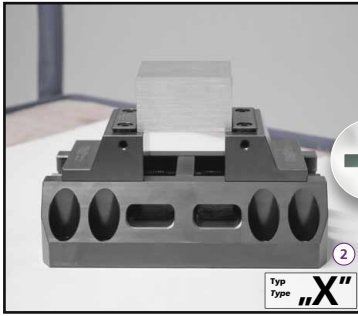

①		A	D	L	kg
	ZSM140L50UPRG-NS17	10-64	60-115	140	~ 4
	ZSM160L50UPRG-NS17	10-84	60-135	160	~ 4,5
	ZSM180L50UPRG-NS17	10-104	60-155	180	~ 5,0
	ZSM200L50UPRG-NS17	10-124	60-175	200	~ 5,6
	inkl. 2x PAND78-34UPRG Incl. 2x PAND78-34UPRG	-	-	-	-

Drehmoment Torque		Spannkraft Workholding force		i
10 Nm	lb-ft 7,4	= 0,2 t	200 daN	
20 Nm	lb-ft 14,8	= 0,5 t	500 daN	
30 Nm	lb-ft 22,2	= 1,0 t	1'000 daN	
40 Nm	lb-ft 29,6	= 1,3 t	1'300 daN	
50 Nm	lb-ft 37,0	= 1,6 t	1'600 daN	
60 Nm	lb-ft 44,4	= 1,8 t	1'800 daN	
70 Nm	lb-ft 51,8	= 2,1 t	2'100 daN	

②		A	D	L	kg
	ZSX140L50UPRG-NS17	10-64	62-118	140	~ 7,1
	ZSX160L50UPRG-NS17	10-84	62-138	160	~ 7,7
	ZSX180L50UPRG-NS17	10-104	62-158	180	~ 8,1
	ZSX200L50UPRG-NS17	10-124	62-178	200	~ 8,8
	inkl. 2x Backen / Incl. 2x jaws	-	-	-	-

②		A	D	L	kg
	ZSX140L50UPRGNF-NS17	10-64	62-118	140	~ 7,1
	ZSX160L50UPRGNF-NS17	10-84	62-138	160	~ 7,7
	ZSX180L50UPRGNF-NS17	10-104	62-158	180	~ 8,1
	ZSX200L50UPRGNF-NS17	10-124	62-178	200	~ 8,8
	inkl. 2x Backen / Incl. 2x jaws	-	-	-	-

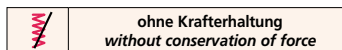

Beinhaltet: Flansch, Nullpunktbolzen
Schrauben, Nutensteine
Includes: Flange, screws, t-nuts, zero
point pull studs



COMPACT

Kompakte Bauweise
Compact design



Weitere Infos im Gesamtkatalog
More informations on general catalogue

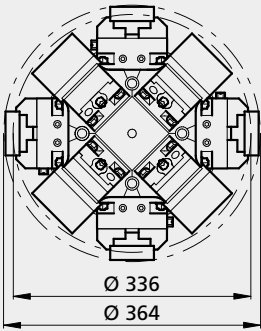
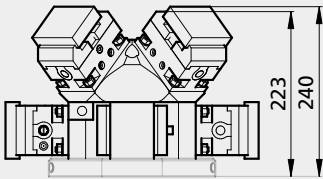
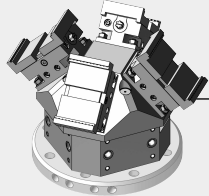
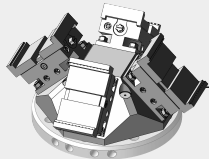

+ 0-PUNKT SYSTEM
0-POINT **oppSYSTEM**



- 5AXMCZ100-45-4S18** 1 *
- 5AXMCZ100-45-4HS18** 2 *
- 5AXMCZ100-45-8S18** 3 *

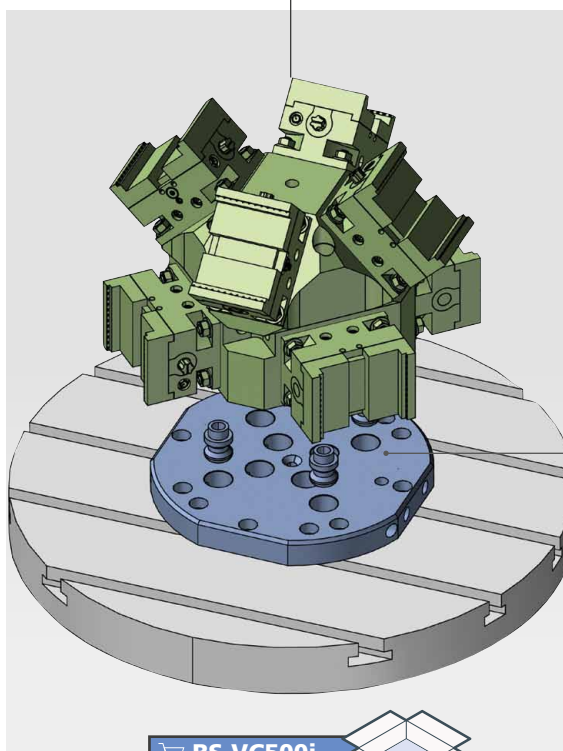

BS-VC500i

Befestigungspaket für VC500i
Mounting package for VC500i

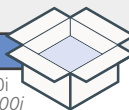

MODULAR

Backen **Mini** Zentrischspanner s.13
Jaws **mini** self centering vise p.13



- * 1/2) Inkl. 8 Spannbacken Ihrer Wahl
- * 3) Inkl. 16 Spannbacken Ihrer Wahl
- * 1/2) Incl. 8 clamping jaws of your choice
- * 3) Incl. 16 clamping jaws of your choice

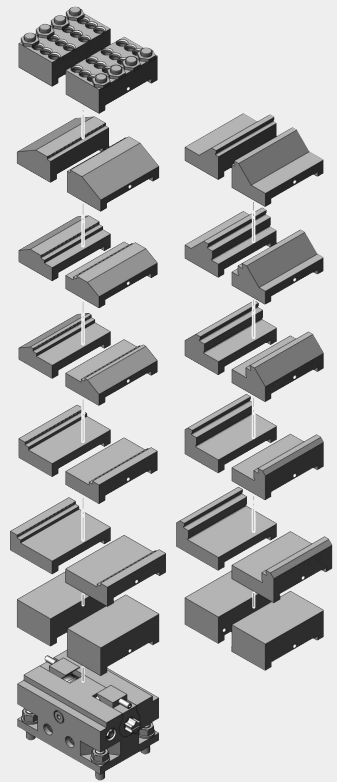

Beinhaltet: Flansch, Nullpunktbolzen,
Schrauben, Nutensteine
Includes: Flange, zero-point pull studs,
screws, t-nuts



Eigenschaften : Modulare Mehrfachspannung, 5 Seiten Bearbeitung
Spannstellen: 4-8 Mini Zentrischspanner
Spannbereich: 0-121 mm
Spannkraft: Max. 1600 daN
Backenarten: Direkt Prägebacken, Formbacken
Mehr Infos auf Seite 13



Characteristics
Clamping areas
Clamping range
Clamping force
Jaw types

Modular multiple workholding, 5 side machining
4-8 Mini self centering vises
0-121 mm
Max. 1600 daN
Direct Stamping jaws, dedicated jaws
More info on page 13

Drehmoment Torque		Spannkraft Workholding force	
10 Nm	lb-ft 7,4	= 0,2 t	200 daN
20 Nm	lb-ft 14,8	= 0,5 t	500 daN
30 Nm	lb-ft 22,2	= 1,0 t	1'000 daN
40 Nm	lb-ft 29,6	= 1,3 t	1'300 daN
50 Nm	lb-ft 37,0	= 1,6 t	1'600 daN

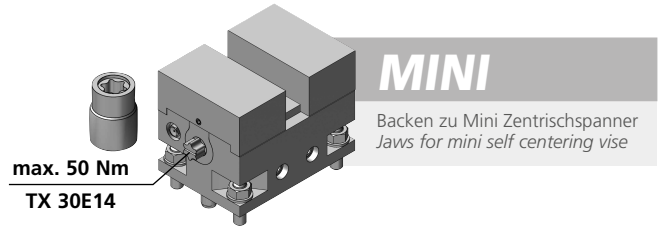

<p>Prägebacken Stamping jaws</p>	<p>B175-26</p> <p>Spannbereich / Clamping range 6-26 mm</p> <p>C = 70 H = 20 L = 40 i 57HRC</p>	<p>B175-45</p> <p>Spannbereich / Clamping range 25-45 mm</p> <p>C = 70 H = 20 L = 40 i 57HRC</p>	<p>B175-64</p> <p>Spannbereich / Clamping range 44-64 mm</p> <p>C = 70 H = 20 L = 40 i 57HRC</p>	
	<p>B175-83</p> <p>Spannbereich / Clamping range 63-83 mm</p> <p>C = 70 H = 20 L = 40 i 57HRC</p>	<p>B175-102</p> <p>Spannbereich / Clamping range 83-102 mm</p> <p>C = 70 H = 20 L = 50 i 57HRC</p>	<p>B175-121</p> <p>Spannbereich / Clamping range 101-121 mm</p> <p>C = 70 H = 20 L = 60 i 57HRC</p>	
<p>Stufenbacken Stepped jaws</p>	<p>B173-26</p> <p>Spannbereich / Clamping range 6-26 mm</p> <p>C = 70 H = 24 L = 40 i 57HRC</p>	<p>B173-45</p> <p>Spannbereich / Clamping range 25-45 mm</p> <p>C = 70 H = 24 L = 40 i 57HRC</p>	<p>B173-64</p> <p>Spannbereich / Clamping range 44-64 mm</p> <p>C = 70 H = 24 L = 40 i 57HRC</p>	
	<p>B173-83</p> <p>Spannbereich / Clamping range 63-83 mm</p> <p>C = 70 H = 24 L = 40 i 57HRC</p>	<p>B173-102</p> <p>Spannbereich / Clamping range 82-102 mm</p> <p>C = 70 H = 24 L = 50 i HV700 x 0,2 mm</p>	<p>B170 (HV700x0.2mm) B172 (weich / soft)</p> <p>Spannbereich / Clamping range 0-80 mm</p> <p>C = 70 H = 24 L = 40 i HV700 x 0,2 mm</p>	
<p>B176-80</p> <p>Spannbereich / Clamping range 8-80 mm</p> <p>*PRG1003M8 C = 70 H = 24 L = 40 i HV700 x 0,2 mm *PRG1003M8 Optional erhältlich / Optional accessory</p>	<p>Zum Erstellen Ihrer individuellen Formbacken: Maximalen Bearbeitungsprofiltiefe If a dedicated jaw is being machined: Max. workpiece penetration depth</p>			

MICRO

Backen zu micro Zentrischspanner
Jaws for mini self centering vise

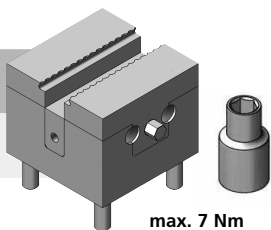

max. 7 Nm
Nuss 1/4 - sw 4,5

Drehmoment Torque		Spannkraft Workholding force	
4 Nm	lb-ft 3	= 0,46 t	457 daN
5 Nm	lb-ft 3,7	= 0,75 t	571 daN
6 Nm	lb-ft 4,4	= 0,69 t	686 daN
7 Nm	lb-ft 5,18	= 0,8 t	800 daN

	B190-13	B190-22	B190-31
Spannbereich Clamping range	3-13mm	12-22mm	21-31mm
Prägebacken Stamping jaws			
Formbacke weich Dedicated jaws			
Spannbereich Clamping range	-	-	-
			<p>H1: Zum Erstellen Ihrer individuellen Formbacke: Schnittzeichnung zum Ermitteln der max. Bearbeitungsprofiltiefe</p> <p>H1: If a dedicated jaw is being machined: This sketch will be of help regarding the workpiece penetration depth</p>
H	6	10	-
H1	2,2	6,2	-

oppSYSTEM

Nullpunkt Zentrier- & Klemmbolzen
Zero point pull studs

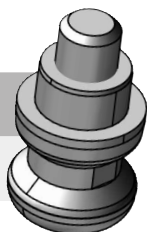

	Nullpunkt Zentrier- und Klemmbolzen Zero point pull studs	Nullpunkt Schwertbolzen diamond pull studs	Klemmbolzen mit Unterlass Pull studs with minus tolerance	Schutzbolzen Protection bolts
Fügeart 1 Joining mode 1				
Fügeart 2 Joining mode 2				

Für mehr Informationen, Zubehör > Gesamtkatalog/triCENTRO, oppSYSTEM
For further informations, accessories > General catalogue/triCENTRO, oppSYSTEM

Time to say goodbye
to the dinosaur vises!



Video

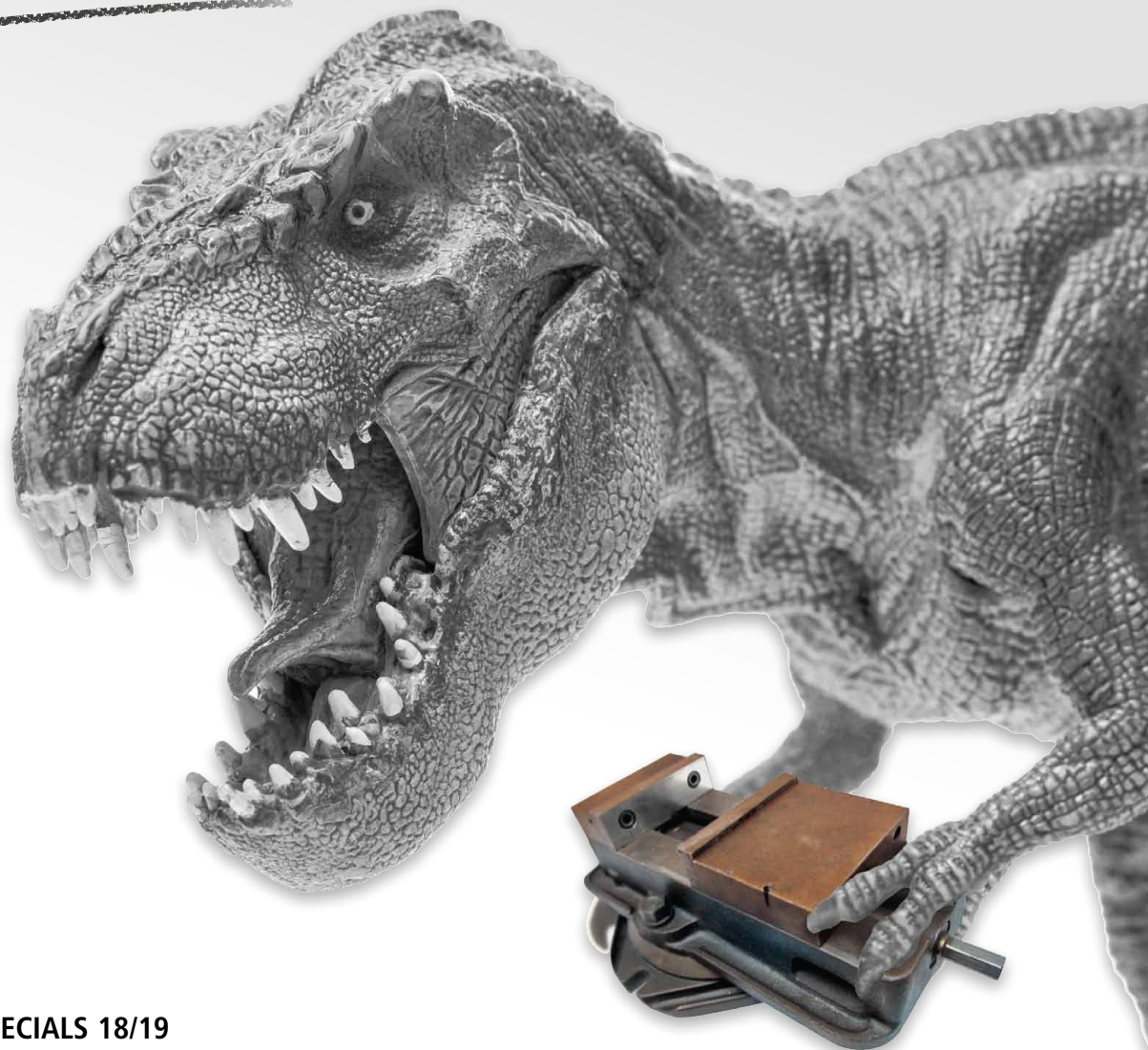

NEWS & SPECIALS 18/19

In dieser Broschüre finden Sie unsere Produktneuheiten und alle aktuelle Sonderangebote.

In this brochure you will find all product news and special offers.

GESAMTKATALOG GENERAL CATALOGUE

In unserem Gesamtkatalog finden Sie alle Standardprodukte und Anwendungsbeispiele.

In our catalogue you will find all standard-products and application examples.





TRIAG

INTERNATIONAL

60 Vertretungen in 43 Länder
60 representations in 43 countries



Triag International AG
Bösch 84 / CH-6331 Hünenberg

Tel. +41 41 727 27 77
spannen@triag-int.ch
clamping@triag-int.ch

