

TD4N | 4 Corner Super Radius | Modular Type

Q max High Efficient	 Roughing	 Semi Finishing	HRC 55	No. of Teeth 2-6
--------------------------------	---	---	------------------	----------------------------

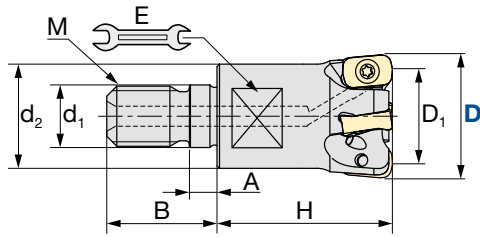
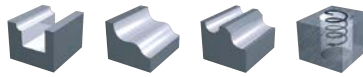

Diameter Holder only [mm]	CAM Radius:	Fastening Torque [Nm]
-0.06/-0.11 mm	2.0 mm	1.1 Nm

ID Code	Item Code	Z	Size								Inserts	
			D	D ₁	H	A	B	d ₁	d ₂	M		E
FH603	TD4N-2016M-2	2	16	10	25	5.5	17	8.5	12.8	M8	10	ENMU0603ER-B ENMU0603ER-C
FH604	TD4N-2020M-3	3	20	14	30		19	10.5	17.8	M10	15	
FH605	TD4N-2025M-4	4	25	19	35		22	12.5	20.8	M12	17	
FH606	TD4N-2032M-5	5	32	26	40	6	23	17	28.8	M16	22	
FH607	TD4N-2035M-5		35	29								
FH608	TD4N-2040M-6	6	40	34								
FH609	TD4N-2042M-6		42	36								

TD4N | 4 Corner Super Radius | Shank Type

Q max High Efficient	 Roughing	 Semi Finishing	HRC 55	No. of Teeth 2-6
--------------------------------	--	--	------------------	----------------------------

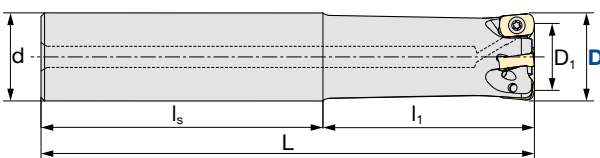
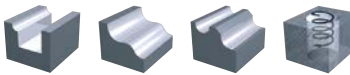
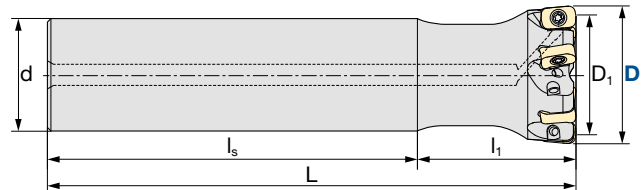
Fig. 1: Standard Type

Fig. 2: Undercut Type

Diameter Holder only [mm]	CAM Radius:	Fastening Torque [Nm]
-0.06/-0.11 mm	2.0 mm	1.1 Nm

ID Code	Item Code	Z	Size						Shape	Inserts
			D	D ₁	L	l ₁	l _s	d		
FH610	TD4N-2016S-2	2	16	10	100	30	70	16	Fig.1	ENMU0603ER-B ENMU0603ER-C
FH615	TD4N-2016L-2				150	50	100			
FH611	TD4N-2020S-3	3	20	14	130	80	80			
FH616	TD4N-2020L-3				160	80				
FH612	TD4N-2025S-4	4	25	19	140	60		25		
FH617	TD4N-2025L-4				180	100				
FH613	TD4N-2032S-5	5	32	26	150	70	32		Fig.2	
FH618	TD4N-2032L-5				200	120				
FH614	TD4N-2040S32-6	6	40	34	150	45		105		
FH619	TD4N-2040L32-6				220	175				

※ S = Short · L = Long

Parts	Clamp Screw 			Wrench 	
	ID Code	Item Code	Fastening Torque [Nm]	ID Code	Item Code
	ET175	250-141(A)	1.1 Nm	ET013	104-T8



INSERTS | TD4N

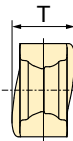
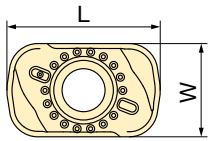

Fig. 1: ENMU0603ER-B
Low cutting force geometry
For SUS and sticky materials

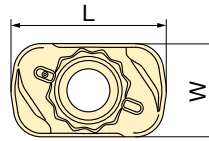
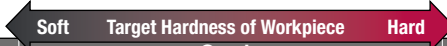

Fig. 2: ENMU0603ER-C
Reinforced edge geometry
For general use
For hard material, interrupt milling



Inserts	Grade				Tolerance Class	Size (mm)				Insert Shape
	GX2140	JM4160	JS4045	JP4120		L	W	T	CAM R	
Item code	ID Code									
ENMU0603ER-B	WF785	WF784	WF783	WF782	M	10	6	4.2	2.0	Fig. 1
ENMU0603ER-C	WF781	WF780	WF779	WF778						Fig. 2



B Type
For lower cutting force.
Recommended for sticky material like Stainless Steel



C Type
For general usage.
Same strength as high feed item.
Against chip biting, vibration, crater wear

TD4N | Insert grade – target material

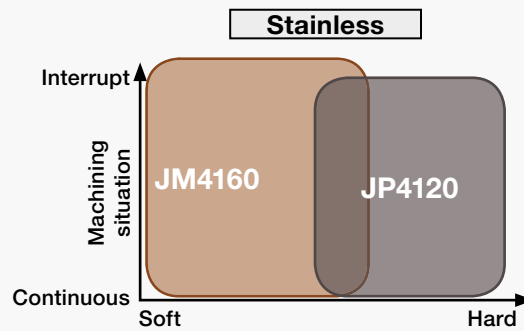
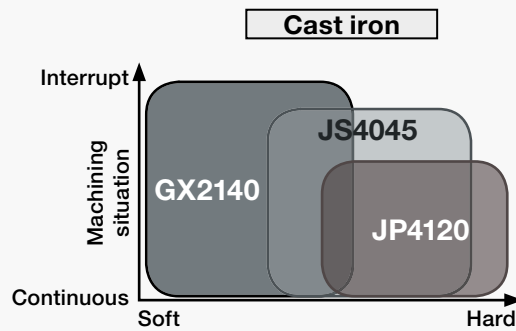
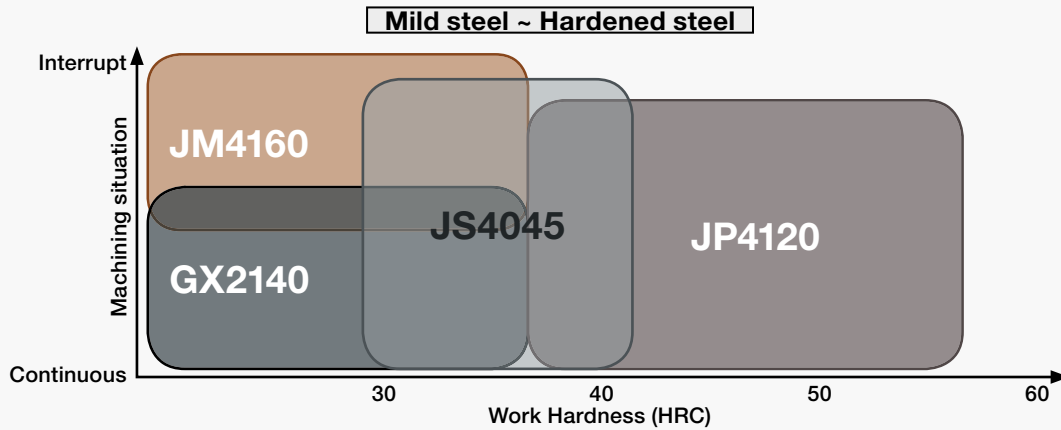

Reduces uncut Remnants on Workpieces

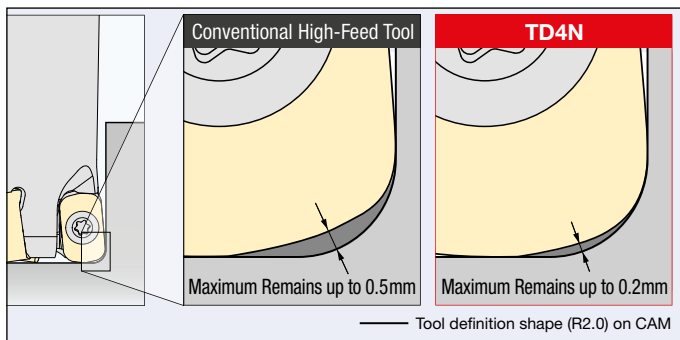

Economical 4-Corner-Use Inserts

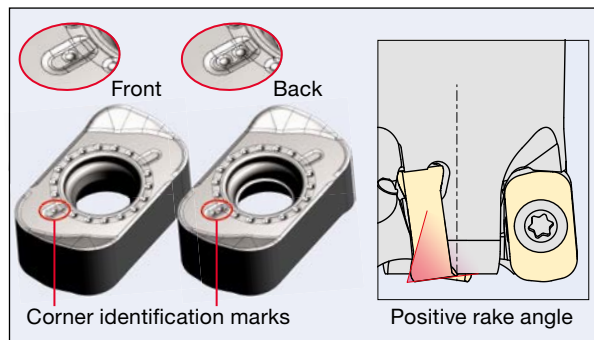



ASC | Carbide Shanks for TD4N

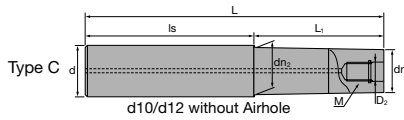
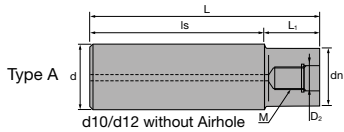

Fits Modular	ID Code	Item Code	D ₂	M	L	L ₁	L _s	dn	dn ₂	d	Type
D 16	FH141	ASC16-8.5-95-30	8.5	M8	95	30	65	14.5	15.5	16	C
	FH258	ASC16-8.5-120-55			120	55					
	FH142	ASC16-8.5-140-75			140	75					
	FH259	ASC16-8.5-160-95			160	95					
	FH260	ASC16-8.5-160-30			160	30					
D 20	FH143	ASC20-10.5-120-50Z	10.5	M10	120	50	70	18	–	20	A
	FH261	ASC20-10.5-170-90Z			170	90	80	18.5	19.5		C
	FH262	ASC20-10.5-220-120Z			220	120	100				
	FH263	ASC20-10.5-270-150Z			270	150	120				
	FH144	ASC20-10.5-220-50Z			220	50	170	18	–		A
	FH264	ASC20-10.5-270-50Z			270	50	220	18.5	19.5		C
D 25	FH145	ASC25-12.5-145-65	12.5	M12	145	65	80	23	–	25	A
	FH265	ASC25-12.5-215-115			215	115	100				
	FH266	ASC25-12.5-265-145			265	145	120				
	FH267	ASC25-12.5-315-195			315	195	120				
	FH146	ASC25-12.5-265-65			265	65	200				
	FH268	ASC25-12.5-315-65			315	65	250				
D 32	FH147	ASC32-17-160-80	17	M16	160	80	80	28	–	32	A
	FH269	ASC32-17-260-140			260	140	120				
	FH270	ASC32-17-360-240			360	240	120				
	FH148	ASC32-17-310-80			310	80	230				

🇬🇧 SUPER Lock milling chucks or shrink-fit holders can be used.

🇩🇪 SUPER Lock Aufnahmen oder Schrumpffutter können verwendet werden.

🇮🇹 Possono essere utilizzati mandrini a forte serraggio SUPER Lock.

🇪🇸 Aptos para amarrar en portapinzas SUPER Lock.

🇫🇷 Les attachements SUPER Lock peuvent être utilisés.

🇵🇹 Cones hidráulicos de grande aperto e aperto térmico podem ser usados.

🇬🇧 For further information about modular chucks please see our brochure *Indexable Modular Series No. 328*

🇩🇪 Weitere Informationen über modulare Werkzeugaufnahmen finden Sie in unserem Prospekt: *Indexable Modular Series No. 328*

🇪🇸 Para obtener más información sobre conos modulares consulte nuestro folleto *Indexable Modular Series No. 328*

🇮🇹 Per maggiori informazioni riguardanti la gamma dei mandrini avvitabili consultate il catalogo *Indexable Modular Series No. 328*

🇫🇷 Pour de plus amples informations concernant les attachements modulaires, voyez SVP notre brochure *Indexable Modular Series No. 328*

🇵🇹 Para mais informações sobre Cones Modulares consulte o nosso folheto *Indexable Modular Series No. 328*

