

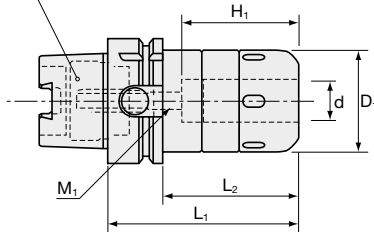

SUPER LOCK | Milling Power Chuck - HSK DIN 69893 A



HSK 63 A M18 x 1.0
HSK 100 A M24 x 1.5



Type 1

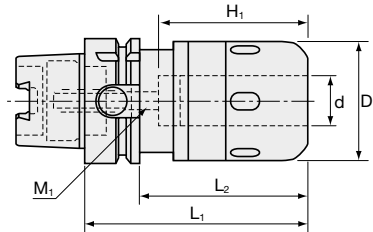

Type 2

HSK63A									
ID Code	Item Code	Type	d	D ₁	L ₁	L ₂	M ₁	H ₁	
NT098	HSK63A-CT20SA-105	1	20	52	105	79	M8	75	
NT126	HSK63A-CT32SA-120	2	32	73	120	94	M8	90	

HSK100A									
ID Code	Item Code	Type	d	D ₁	L ₁	L ₂	M ₁	H ₁	
NT231	HSK100A-CT20SA-105	1	20	52	105	76	M10	70	
NT099	HSK100A-CT32SA-135	2	32	73	135	106	M10	100	

Content of Sets:				
ID Code	Item Code	Content *		
NT101	SET-HSK63-CT20	1x HSK63A-CT20SA-105	(Chuck)	* Info: see p.5 below * Info: siehe S. 5 unten * Per maggiori informazioni consultare pagina 5 seguente * Info: ver pág. 5 abajo * Info: voir ci-après p. 5 * Para mais informação, ver final de pág. 5.
		incl. 5 MC20 Collets	(Collets)	
NT079	SET-HSK63-CT32	1x HSK63A-CT32SA-120G	(Chuck)	
		incl. 7 MC32 Collets	(Collets)	
NT076	SET-HSK100-CT20	1x HSK100A-CT20SA-105	(Chuck)	
		incl. 5 MC20 Collets	(Collets)	
NT100	SET-HSK100-CT32	1x HSK100A-CT32SA-135	(Chuck)	
		incl. 7 MC32 Collets	(Collets)	

Attention!

🇬🇧 Please check your spindle system on the machine if there is an inner coolant pipe needed.
Please ask your machine manufacturer if you are not sure. For a following damage/ mistake we will not guarantee!

Achtung!

🇩🇪 Bitte prüfen Sie Ihr Spindel-System, ob Sie für die innere Kühlmittel-zufuhr eine Hülse in der Aufnahme benötigen.
Sollten Sie nicht sicher sein, ziehen Sie bitte Ihren Maschinenhersteller zu Rate. Für eventuell auftretende Beschädigungen können wir keine Garantie übernehmen!

Attenzione!

🇮🇹 Si prega di controllare se nel mandrino della vostra macchina utensile è necessario avere il tubo per il refrigerante interno.
Si prega di contattare il costruttore della macchina se non si è sicuri. Per eventuali danni/errori dovuti all'omesso controllo non garantiremo

¡Importante!

🇪🇸 Por favor compruebe si el cabezal de su máquina requiere un manguito para la refrigeración interna. Pregunte al fabricante de la máquina si Ud. no está seguro.
¡En caso de averia no nos haremos responsables de la misma!

Attention !

🇫🇷 Veuillez, SVP, vérifier si votre système de broche nécessite l'utilisation d'un tube d'arrosage par le centre. Si vous n'êtes pas certain, veuillez, SVP, demander au fabricant de la machine.
Nous déclinons toute responsabilité en cas de dommage et ou d'erreur, liés à l'utilisation ou non du tube d'arrosage !

Atenção:

🇵🇹 Por favor, verifique se a sua cabeça da máquina requer dispositivo para arrefecimento interno. Pergunte ao fabricante da máquina se não tiver certeza. Em caso de falha não se responsabilizamos pela sua falta!

Parts	Wrench	
Item Code	ID Code	Item Code
for CT20SA	NT009	HS-2
for CT32SA	NT010	HS-3



SUPER LOCK | Milling Power Chuck - SK DIN 69871

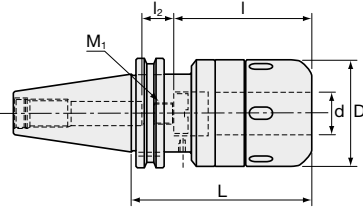

Type 1

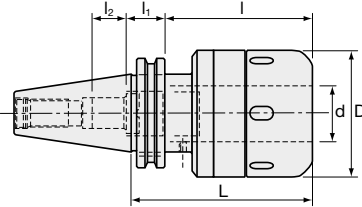

Type 2

ID Code	Item Code	Type	d	D	L	l	l ₁	M ₁	l ₂
NT029	SK40-CT20SA-90	1	20	52	90	80	-	12	15
NT129	SK40-CT32SA-105	2	32	73	105	85	23	18	20
NT232	SK50-CT20SA105	1	20	52	105	80	-	12	15
NT030	SK50-CT32SA-105	2	32	73	105	120	-	18	20
NT001	BT40-CT20SA-90	1	20	52	90	80	-	12	15
NT002	BT50-CT32SA-105	2	32	73	105	120	-	18	20
NT235	BT40-CT32SA-105	2	32	73	105	120	23	18	20

Content of Sets:

ID Code	Item Code	Content *
NT027	SET-SK40-CT20	1x SK40-CT20SA-90 (Chuck) incl. 5 MC20 Collets (Collets)
NT077	SET-SK50-CT20	1x SK50-CT20SA-105 (Chuck) incl. 5 MC20 Collets (Collets)
NT028	SET-SK50-CT32	1x SK50-CT32SA-105 (Chuck) incl. 7 MC32 Collets (Collets)
NT078	SET-SK40-CT32	1x SK40-CT32SA-105 (Chuck) incl. 7 MC32 Collets (Collets)
NT025	SET-BT40-CT20	1x BT40-CT20SA-90 (Chuck) incl. 5 MC20 Collets (Collets)
NT236	SET-BT40-CT32	1x BT40-CT32SA-105 (Chuck) incl. 7 MC32 Collets (Collets)
NT026	SET-BT50-CT32	1x BT50-CT32SA-105 (Chuck) incl. 7 MC32 Collets (Collets)

🇬🇧 * Info: see below
🇩🇪 * Info: siehe unten
🇮🇹 * Per maggiori informazioni: vedi sotto
🇪🇸 * Info: ver más abajo
🇫🇷 * Info: voir ci-dessous
🇵🇹 * Para mais informação: ver abaixo

🇬🇧 * The diameters and milling chucks (type 1 or type 2) can be freely combined as set with the collets.

🇩🇪 * Die Durchmesser und die Spannzange (Typ 1 oder Typ 2) sind als Set mit den Hülsen frei kombinierbar.

🇮🇹 * I mandrini (Tipo 1 o Tipo 2), nei vari diametri, possono essere abbinati a pinze a scelta creando un SET

🇪🇸 * Los diferentes tamaños de conos (tipo 1 o tipo 2) se pueden combinar libremente como Set con las pinzas

🇫🇷 * Les attachements permettent de combiner des mandrins et des pinces de diamètres différents (type 1 ou type 2).

🇵🇹 * Os cones e respetivos diâmetros (tipo 1 ou tipo 2) podem ser livremente combinados em SETs com as pinças.

Parts		Wrench		
Item Code	ID Code	Item Code	ID Code	Item Code
for CT20SA	NT009	HS-2		
for CT32SA	NT010	HS-3		
for EM2019A			NT024	S-1



MC20 | Collets for CT20S

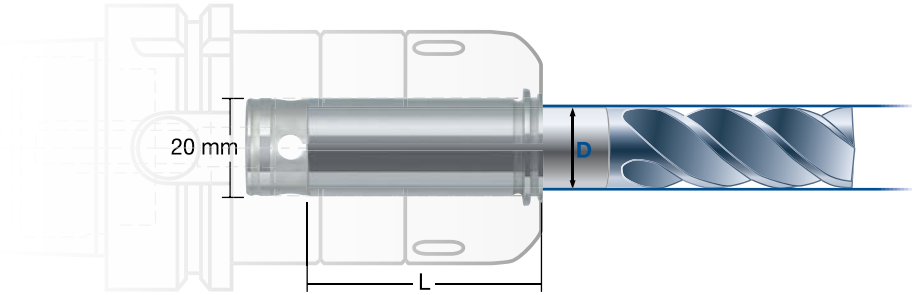

ID Code	Item Code	Shank D	Chucking Length L*
NT085	MC20-3	3	30 mm
NT014	MC20-4	4	
NT015	MC20-6	6	
NT016	MC20-8	8	
NT011	MC20-10	10	40 mm
NT012	MC20-12	12	
NT081	MC20-14	14	45 mm
NT013	MC20-16	16	
NT083	MC20-18	18	
-	-	20	

* Recommended Chucking Length of Cutting Tool

UK Note: The closed version (OH) is also available with unequal diameters (please see below).

DE Hinweis: Die geschlossene Version (OH) ist auch mit ungeraden Durchmessern verfügbar (siehe unten).

IT Nota: La versione a tenuta (OH) è disponibile anche con diametri dispari (vedi sotto).

ES Nota: La versión cerrada (OH) también está disponible con diámetros impares (ver más abajo)

FR Note : Différents diamètres (voir ci-dessous) sont également disponibles pour cette référence (OH).

PT Nota: A versão fechada (OH) está também disponível para diâmetros ímpares (ver abaixo).

MC20-OH | Collets for CT20S

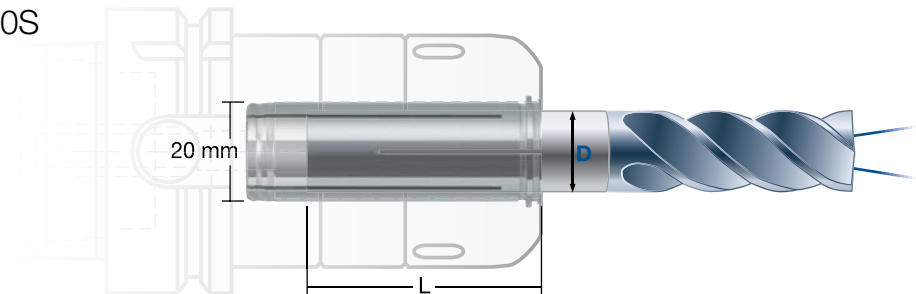

ID Code	Item Code	Shank D	Chucking Length L*
NT086	MC20-3OH	3	30 mm
NT042	MC20-4OH	4	
NT043	MC20-5OH	5	
NT044	MC20-6OH	6	
NT045	MC20-7OH	7	40 mm
NT046	MC20-8OH	8	
NT047	MC20-9OH	9	
NT037	MC20-10OH	10	
NT038	MC20-11OH	11	45 mm
NT039	MC20-12OH	12	
NT040	MC20-13OH	13	
NT082	MC20-14OH	14	
NT080	MC20-16OH	16	45 mm
NT084	MC20-18OH	18	
-	-	20	

* Recommended Chucking Length of Cutting Tool



MC32 | Collets for CT32S

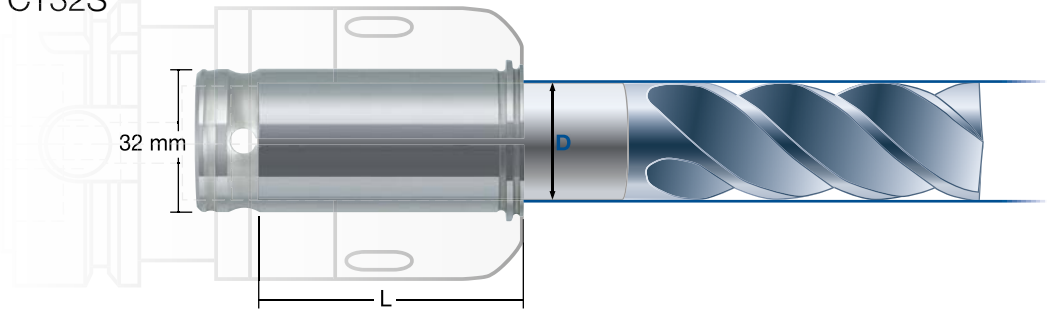

ID Code	Item Code	Shank D	Chucking Length L*
NT091	MC32-3	3	30 mm
NT093	MC32-4	4	
NT022	MC32-6	6	
NT023	MC32-8	8	40 mm
NT017	MC32-10	10	
NT018	MC32-12	12	
NT087	MC32-14	14	45 mm
NT019	MC32-16	16	
NT089	MC32-18	18	
NT020	MC32-20	20	50 mm
NT021	MC32-25	25	
-	-	32	

* Recommended Chucking Length of Cutting Tool

Note: The closed version (OH) is also available with unequal diameters (please see below).

Hinweis: Die geschlossene Version (OH) ist auch mit ungeraden Durchmessern verfügbar (siehe unten).

Nota: La versione a tenuta (OH) è disponibile anche con diametri dispari (vedi sotto).

Nota: La versión cerrada (OH) también está disponible con diámetros impares (ver más abajo)

Note : Différents diamètres (voir ci-dessous) sont également disponibles pour cette référence (OH).

Nota: A versão fechada (OH) está também disponível para diâmetros ímpares (ver abaixo).

MC32-OH | Collets for CT32S

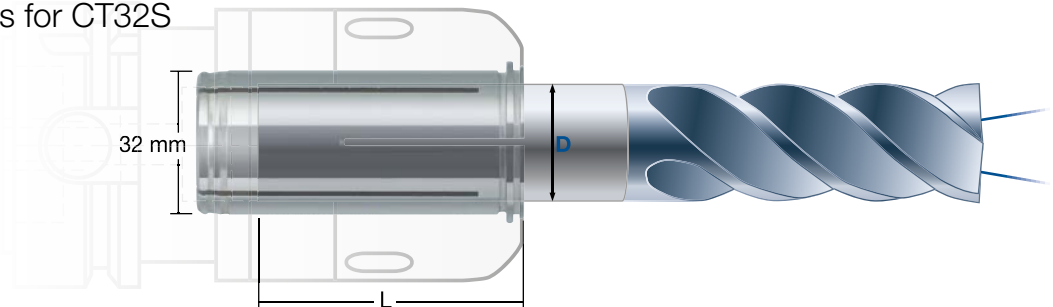

ID Code	Item Code	Shank D	Chucking Length L*
NT092	MC32-3OH	3	30 mm
NT052	MC32-4OH	4	
NT053	MC32-5OH	5	
NT054	MC32-6OH	6	40 mm
NT055	MC32-7OH	7	
NT056	MC32-8OH	8	
NT057	MC32-9OH	9	45 mm
NT048	MC32-10OH	10	
NT049	MC32-11OH	11	
NT151	MC32-12OH	12	50 mm
NT050	MC32-13OH	13	
NT088	MC32-14OH	14	
NT152	MC32-16OH	16	50 mm
NT090	MC32-18OH	18	
NT153	MC32-20OH	20	
NT154	MC32-25OH	25	50 mm
-	-	32	

* Recommended Chucking Length of Cutting Tool