

HGOS-2-PN | GO-Line PaNacea Square

V max High Speed	▽ Roughing	▽▽ Semi Finishing	▽▽▽ Finishing	HRC 52	No. of Teeth 2
----------------------------	----------------------	-----------------------------	-------------------------	------------------	--------------------------

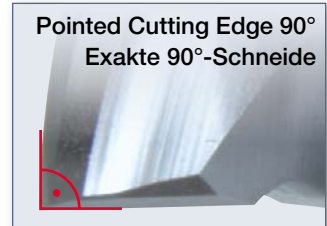
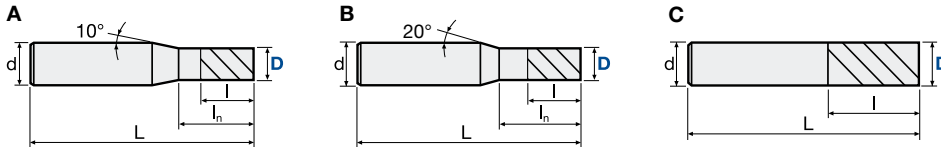

Carbide Micro Grain	PN PaNacea Coating	Rake Angle Positive
-------------------------------	------------------------------	-------------------------------

Helix Angle 30°	D Tol. [mm] D0.2~D0.9: 0/-0.015 D1~D20: 0/-0.020	d Tol. h5
---------------------------	---	---------------------

ID Code	Item Code	Z	D	l	l _n	L	d	Type
EL066	HGOS-2002-PN	2	0.2	0.4	0.6	40	4	A
EL067	HGOS-2003-PN		0.3	0.6	0.9			
EL068	HGOS-2004-PN		0.4	0.8	1.1			
EL069	HGOS-2005-PN		0.5	1	1.3			
EL070	HGOS-2006-PN		0.6	1.2	1.5			
EL071	HGOS-2007-PN		0.7	1.4	1.7			
EL072	HGOS-2008-PN		0.8	1.6	1.9			
EL073	HGOS-2009-PN		0.9	1.8	2.1			
EL074	HGOS-2010-PN		1	2	2.5			
EL075	HGOS-2015-PN		1.5	3	3.5			
EL076	HGOS-2020-PN		2	6	7			
EL077	HGOS-2025-PN		2.5	8	9			
EL078	HGOS-2030-PN		3	10	11	45	6	B
EL079	HGOS-2035-PN		3.5	11	12			
EL080	HGOS-2040-PN		4	13	14			
EL081	HGOS-2045-PN		4.5	16	17			
EL082	HGOS-2050-PN		5	19	20			
EL083	HGOS-2055-PN		5.5	22	-	70	8	B
EL084	HGOS-2060-PN		6	26	-	75		C
EL085	HGOS-2070-PN		7	35	-	80	10	B
EL086	HGOS-2080-PN	8	40	-	80	10	B	
EL087	HGOS-2090-PN	9	22	-	80	10	B	
EL088	HGOS-2100-PN	10	26	-	100	12	C	
EL089	HGOS-2120-PN	12	35	-	110	16		
EL090	HGOS-2160-PN	16	40	-	125	20		
EL091	HGOS-2200-PN	20						

Cutting Conditions | Schnittwerte | Condizioni di taglio | Condiciones de Corte | Conditions de coupe | Valores de corte:

D0.2 - D20 :

Page 4-5

HGOS-4-PN | GO-Line PaNacea Square

V max High Speed	▽ Roughing	▽▽ Semi Finishing	▽▽▽ Finishing	HRC 52	No. of Teeth 4
----------------------------	----------------------	-----------------------------	-------------------------	------------------	--------------------------

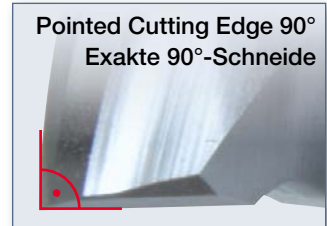
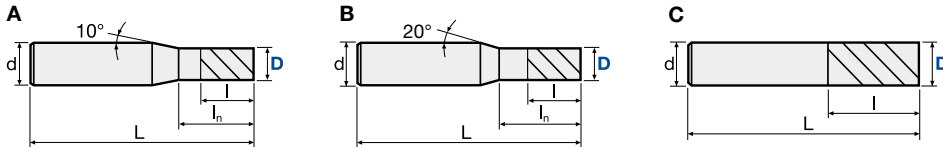
Carbide Micro Grain	PN PaNacea Coating	Rake Angle Positive
-------------------------------	------------------------------	-------------------------------

Helix Angle	D Tol. [mm]	d Tol.
30°	0/-0.02	h5

ID Code	Item Code	Z	D	I	I _n	L	d	Type
EL092	HGOS-4010-PN	4	1	2.5	3	40	4	A
EL093	HGOS-4015-PN		1.5	4	4.5			
EL118	HGOS-4020-PN		2	6	7			
EL119	HGOS-4025-PN		2.5	8	9			
EL120	HGOS-4030-PN		3	10	11	45	6	B
EL121	HGOS-4040-PN		4	12	13			
EL122	HGOS-4050-PN		5	15	16	60	8	C
EL123	HGOS-4060-PN		6					
EL124	HGOS-4080-PN		8	20	-	75		
EL125	HGOS-4100-PN		10	25	-	80	10	
EL126	HGOS-4120-PN		12	30	-	100	12	
EL127	HGOS-4160-PN		16	35	-	110	16	
EL128	HGOS-4200-PN	20	40	-	125	20		

Cutting Conditions | Schnittwerte | Condizioni di taglio | Condiciones de Corte | Conditions de coupe | Valores de corte: D1 - D20 : Page 6-7

PaNacea Coating
high adhesion and wear resistance

