

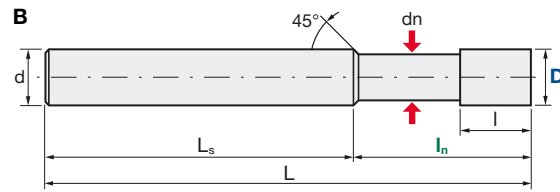

EPSM-PN | Epoch Multi Series Square Type

V max High Speed	Q max High Efficient	▽ Roughing	▽▽ Semi Finishing	▽▽▽ Finishing	HRC 52	No. of Teeth 4
----------------------------	--------------------------------	----------------------	-----------------------------	-------------------------	------------------	--------------------------

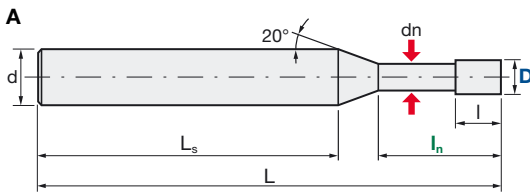

Type B: D16 and D20 without 45° phase at neck end

Carbide Micro Grain	PN PaNacea Coating	Rake Angle Positive
-------------------------------	------------------------------	-------------------------------

Helix Angle	D Tol. [mm]	d Tol.
40°	D1~D6: 0/-0.015	D1~D12: h5
	D8~D20: 0/-0.02	D16~D20: h6

EPSM-PN Regular Type (underneck 3xD)										
ID Code	Item Code	Z	D	ln	l	dn	L	Ls	d	Type
EP1666	EPSM-4010-3-PN	4	1	3	1.5	0.96	56	46.08	6	A
EP1669	EPSM-4020-6-PN		2	6	3	1.92		44.40		
EP1672	EPSM-4030-9-PN		3	9	4.5	2.88		42.71		
EP1675	EPSM-4040-12-PN		4	12	6	3.70		40.84		
EP1678	EPSM-4050-15-PN		5	15	7.5	4.60		39.08		
EP1681	EPSM-4060-18-PN		6	18	9	5.50	38.00	8	B	
EP1685	EPSM-4080-24-PN		8	24	12	7.30	63			39.00
EP1689	EPSM-4100-30-PN		10	30	15	9.10	74			44.00
EP1693	EPSM-4120-36-PN		12	36	18	11.00	86			50.00
EP1696	EPSM-4160-48-PN		16	48	24	14.50	110			62.00
EP1699	EPSM-4200-60-PN	20	60	30	18.20	125	65.00	20		

EPSM-PN Regular Type (underneck 5xD)										
ID Code	Item Code	Z	D	ln	l	dn	L	Ls	d	Type
EP1667	EPSM-4010-5-PN	4	1	5	1.5	0.96	68	56.08	6	A
EP1670	EPSM-4020-10-PN		2	10	3	1.92		52.40		
EP1673	EPSM-4030-15-PN		3	15	4.5	2.88		48.71		
EP1676	EPSM-4040-20-PN		4	20	6	3.7		44.84		
EP1679	EPSM-4050-25-PN		5	25	7.5	4.6		41.08		
EP1682	EPSM-4060-30-PN		6	30	9	5.5	38	8	B	
EP1686	EPSM-4080-40-PN		8	40	12	7.3	80			40
EP1690	EPSM-4100-50-PN		10	50	15	9.1	94			44
EP1694	EPSM-4120-60-PN		12	60	18	11	110			50
EP1697	EPSM-4160-80-PN		16	80	24	14.5	135			55
EP1700	EPSM-4200-100-PN	20	100	30	18.2	155	55	20		



EPSM-PN | Epoch Multi Series Square Type

V max High Speed	Q max High Efficient	▽ Roughing	▽▽ Semi Finishing	▽▽▽ Finishing	HRC 52	No. of Teeth 4
----------------------------	--------------------------------	----------------------	-----------------------------	-------------------------	------------------	--------------------------

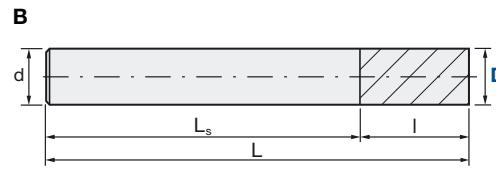
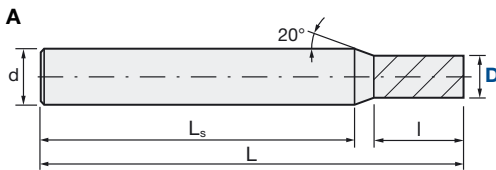

Carbide Micro Grain	PN PaNacea Coating	Rake Angle Positive
-------------------------------	------------------------------	-------------------------------

Helix Angle	D Tol. [mm]	d Tol.
40°	D1~D6: 0/-0.015	D1~D12: h5
	D8~D20: 0/-0.02	D16~D20: h6

EPSM-PN Regular Type (no underneck)								
ID Code	Item Code	Z	D	I	L	L _s	d	Type
EP1665	EPSM-4010-PN	4	1	2.5	56	46.13	6	A
EP1668	EPSM-4020-PN		2	5		44.51		
EP1671	EPSM-4030-PN		3	7.5		43.38		
EP1674	EPSM-4040-PN		4	10		42.25		
EP1677	EPSM-4050-PN		5	12.5		41.13		
EP1680	EPSM-4060-PN		6	15		41.00		
EP1683	EPSM-4070-PN		7	17.5	63	43.13	8	A
EP1684	EPSM-4080-PN		8	20	74	43.00	8	B
EP1687	EPSM-4090-PN		9	22.5	74	49.13	10	A
EP1688	EPSM-4100-PN		10	25	74	49.00	10	B
EP1691	EPSM-4110-PN		11	27.5	86	56.13	12	A
EP1692	EPSM-4120-PN		12	30	86	56.00	12	B
EP1695	EPSM-4160-PN		16	40	110	70.00	16	B
EP1698	EPSM-4200-PN		20	50	125	75.00	20	

Cutting Conditions Schnittwerte Condizioni di taglio Condiciones de Corte Conditions de coupe Valores de corte:			
Side Milling: Page 6		Slot Milling: Page 7	
		Side Finishing: Page 8	



EPSM-CR-PN | Epoch Multi Series Corner Radius

V max High Speed	Q max High Efficient	▽ Roughing	▽▽ Semi Finishing	▽▽▽ Finishing	HRC 55	No. of Teeth 4
----------------------------	--------------------------------	----------------------	-----------------------------	-------------------------	------------------	--------------------------

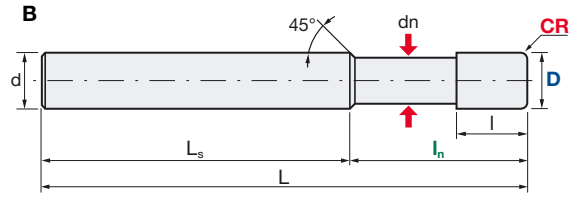
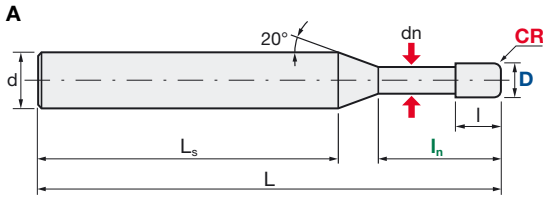
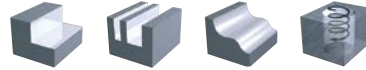

Type B: D16 and D20 without 45° phase at neck end

Carbide Micro Grain	PN PaNacea Coating	Rake Angle Positive
-------------------------------	------------------------------	-------------------------------

Helix Angle	D Tol. [mm]	d Tol.
40°	D1~D6: 0/-0.015	D1~D12: h5
	D8~D20: 0/-0.02	D16~D20: h6

EPSM Corner R (underneck 5xD)														
ID Code	Item Code	Z	D	CR	ln	l	dn	L	Ls	d	Type			
EP1702	EPSM-4010-5-R0.1-PN	4	1	0.1	5	1.5	0.960	68	56.08	6	A			
EP1705	EPSM-4020-10-R0.1-PN		2	0.2	10	3	1.920		52.40					
EP1706	EPSM-4020-10-R0.2-PN		2	0.2	10	3	1.920		52.40					
EP1709	EPSM-4030-15-R0.2-PN		3	0.5	15	4.5	2.880		48.71					
EP1710	EPSM-4030-15-R0.5-PN		3	0.5	15	4.5	2.880		48.71					
EP1714	EPSM-4040-20-R0.2-PN		4	0.2	20	6	3.700		44.84					
EP1715	EPSM-4040-20-R0.5-PN		4	0.5	20	6	3.700		44.84					
EP1716	EPSM-4040-20-R1.0-PN		4	1	20	6	3.700		44.84					
EP1719	EPSM-4050-25-R0.2-PN		5	0.2	25	7.5	4.600		41.08					
EP1720	EPSM-4050-25-R0.5-PN		5	0.5	25	7.5	4.600		41.08					
EP1725	EPSM-4060-30-R0.3-PN		6	0.3	30	9	5.500	38.00	8	8	B			
EP1726	EPSM-4060-30-R0.5-PN			0.5										
EP1727	EPSM-4060-30-R1.0-PN			1										
EP1728	EPSM-4060-30-R1.5-PN		1.5											
EP1733	EPSM-4080-40-R0.3-PN		8	0.3	40	12	7.300	80				40.00	8	B
EP1734	EPSM-4080-40-R0.5-PN			0.5										
EP1735	EPSM-4080-40-R1.0-PN			1										
EP1736	EPSM-4080-40-R2.0-PN		2											
EP1741	EPSM-4100-50-R0.3-PN		10	0.3	50	15	9.100	94				44.00	10	B
EP1742	EPSM-4100-50-R0.5-PN			0.5										
EP1743	EPSM-4100-50-R1.0-PN	1												
EP1744	EPSM-4100-50-R2.0-PN	2												
EP1750	EPSM-4120-60-R0.3-PN	12	0.3	60	18	11.000	110	50.00	12	B				
EP1751	EPSM-4120-60-R0.5-PN		0.5											
EP1752	EPSM-4120-60-R1.0-PN		1											
EP1753	EPSM-4120-60-R1.5-PN		1.5											
EP1754	EPSM-4120-60-R2.0-PN	2												
EP1757	EPSM-4160-80-R0.5-PN	16	0.5	80	24	14.500	135	55.00	16	B				
EP1758	EPSM-4160-80-R1.0-PN		1											
EP1761	EPSM-4200-100-R0.5-PN	20	0.5	100	30	18.200	155	55.00	20	B				
EP1762	EPSM-4200-100-R1.0-PN		1											



EPSM-CR-PN | Epoch Multi Series Corner Radius

V max High Speed	Q max High Efficient	▽ Roughing	▽▽ Semi Finishing	▽▽▽ Finishing	HRC 55	No. of Teeth 4
----------------------------	--------------------------------	----------------------	-----------------------------	-------------------------	------------------	--------------------------

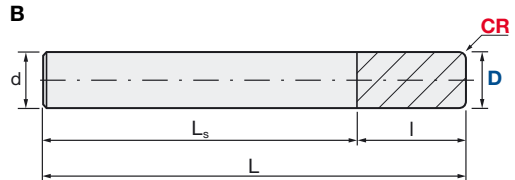
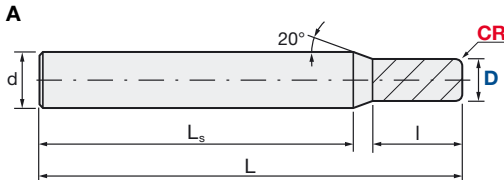
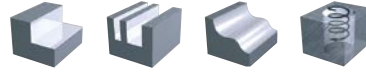

Carbide Micro Grain	PN PaNacea Coating	Rake Angle Positive
-------------------------------	------------------------------	-------------------------------

Helix Angle	D Tol. [mm]	d Tol.
40°	D1~D6: 0/-0.015	D1~D12: h5
	D8~D20: 0/-0.02	D16~D20: h6

EPSM Corner R (no underneck)									
ID Code	Item Code	Z	D	CR	l	L	L _s	d	Type
EP1701	EPSM-4010-R0.1-PN	4	1	0.1	2.5	56	46.13	6	A
EP1703	EPSM-4020-R0.1-PN		2	0.2	5		44.51		
EP1704	EPSM-4020-R0.2-PN		3	0.2	7.5		43.38		
EP1707	EPSM-4030-R0.2-PN			0.5					
EP1708	EPSM-4030-R0.5-PN		4	0.2	10		42.25		
EP1711	EPSM-4040-R0.2-PN			0.5					
EP1712	EPSM-4040-R0.5-PN		1						
EP1713	EPSM-4040-R1.0-PN		5	0.2	12.5	41.13			
EP1717	EPSM-4050-R0.2-PN			0.5					
EP1718	EPSM-4050-R0.5-PN			0.3					
EP1721	EPSM-4060-R0.3-PN		6	0.5	15	41.00			
EP1722	EPSM-4060-R0.5-PN			1					
EP1723	EPSM-4060-R1.0-PN			1.5					
EP1724	EPSM-4060-R1.5-PN		8	0.3	20	43.00			
EP1729	EPSM-4080-R0.3-PN			0.5					
EP1730	EPSM-4080-R0.5-PN			1					
EP1731	EPSM-4080-R1.0-PN		10	2	25	49.00			
EP1732	EPSM-4080-R2.0-PN			0.3					
EP1737	EPSM-4100-R0.3-PN		12	0.5	30	56.00			
EP1738	EPSM-4100-R0.5-PN			1					
EP1739	EPSM-4100-R1.0-PN	1.5							
EP1740	EPSM-4100-R2.0-PN	16	2	40	70.00				
EP1745	EPSM-4120-R0.3-PN		0.3						
EP1746	EPSM-4120-R0.5-PN		0.5						
EP1747	EPSM-4120-R1.0-PN	20	1	50	75.00				
EP1748	EPSM-4120-R1.5-PN		1						
EP1749	EPSM-4120-R2.0-PN		1						
EP1755	EPSM-4160-R0.5-PN	20	0.5	50	75.00				
EP1756	EPSM-4160-R1.0-PN		1						
EP1759	EPSM-4200-R0.5-PN		1						
EP1760	EPSM-4200-R1.0-PN								

Cutting Conditions Schnittwerte Condizioni di taglio Condiciones de Corte Conditions de coupe Valores de corte:					
Side Milling: Page 6		Slot Milling: Page 7		Side Finishing: Page 8	
				3D finishing: Page 9	